

*Improvements to*  
**EDWARDS/McCARTHY  
PLAYGROUND**



December 13, 2018  
Boston Parks and Recreation



# AGENDA

---

1

**PROJECT TEAM INTRODUCTION**

---

2

**PROJECT OVERVIEW**

---

3

**PRESENTATION**

---

4

**LISTENING & DISCUSSION**

---

5

**CLOSING REMARKS & NEXT STEPS**

---

# PROJECT TEAM

---

## **Allison Perlman**

Project Manager

[allison.perlman@boston.gov](mailto:allison.perlman@boston.gov) or 617-961-3035

## **Marchelle Jacques-Yarde**

Outreach Coordinator, External Affairs

[marchelle.jacques-yarde@boston.gov](mailto:marchelle.jacques-yarde@boston.gov) or 617-961-3006

**Kaki Martin**, Principal

**Sharon Komarow**, Associate

Klopfer Martin Design Group

## **Quinlan Locke**

Office of Neighborhood Services

[quinlan.locke@boston.gov](mailto:quinlan.locke@boston.gov) or 617-635-3549



# PROJECT SCHEDULE & FUNDING

---

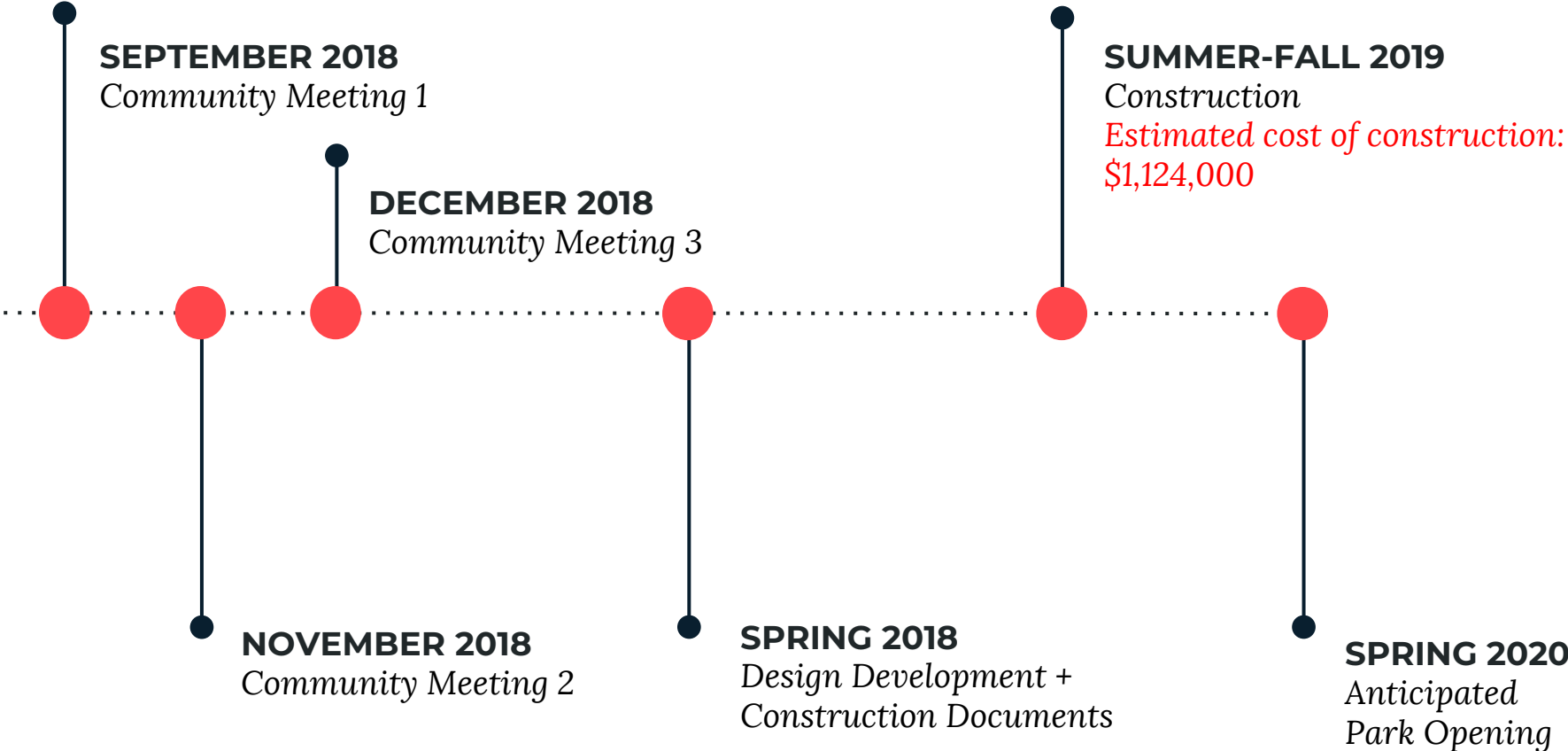

**RECAP**

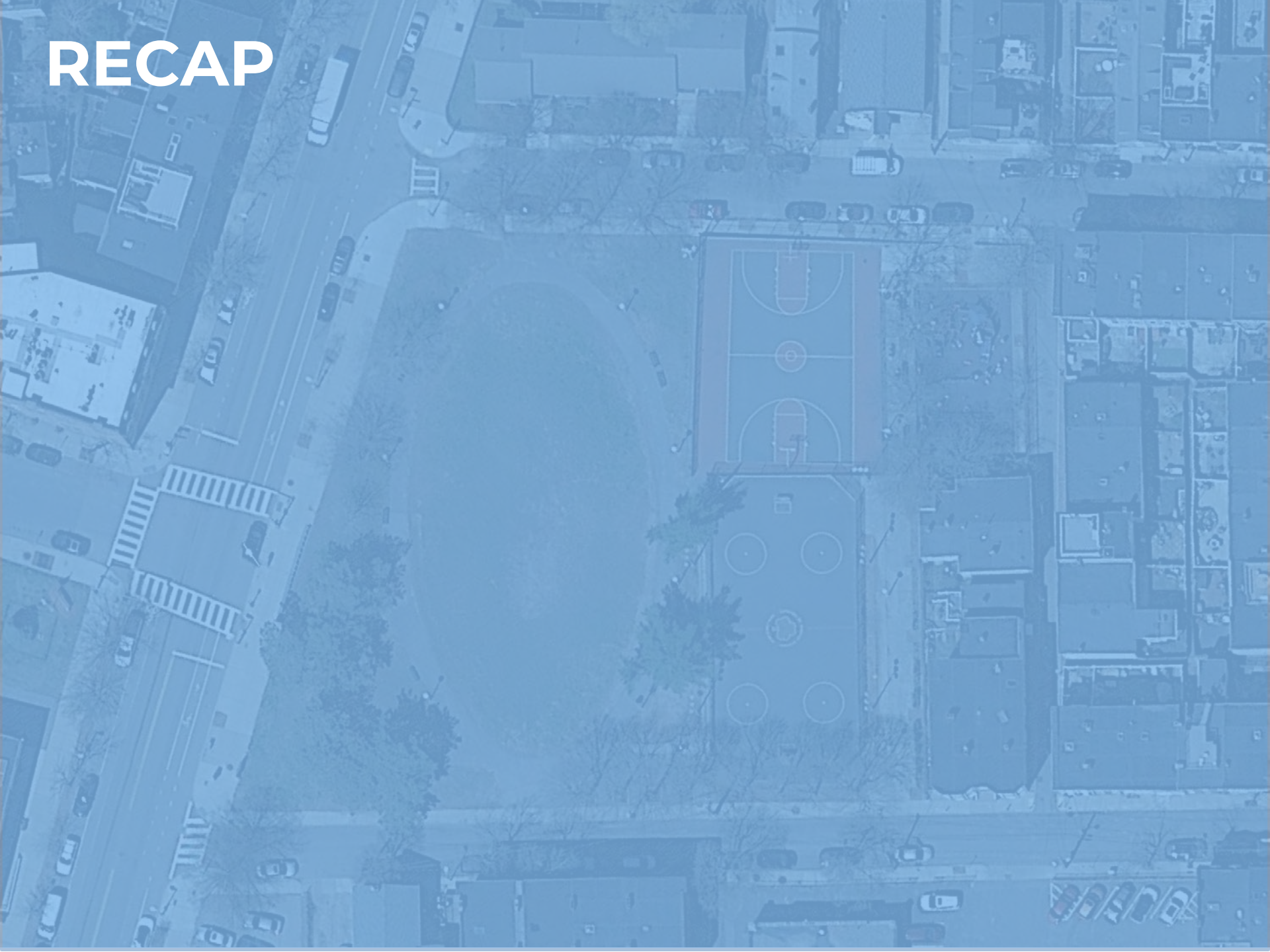

**SITE  
EXISTING**



# SITE EXISTING PROGRAM



## LEGEND

-  Playground
-  Street Hockey
-  Basketball
-  Lawn/Passive Area

# SITE TOPOGRAPHY

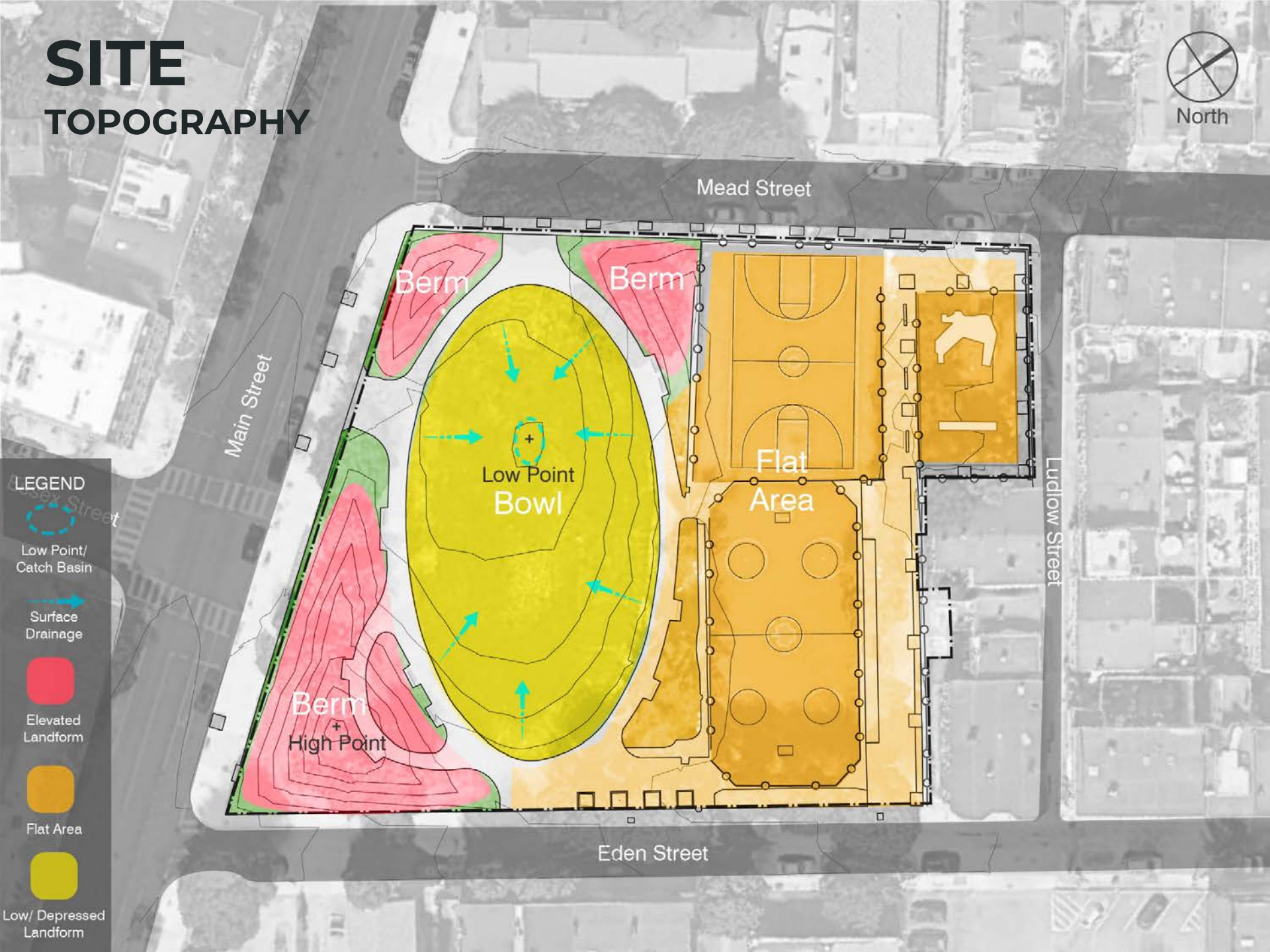

Mead Street

Main Street

Ludlow Street

Eden Street

Berm

Berm

Low Point  
Bowl

Flat  
Area

Berm  
+  
High Point

## LEGEND

Low Point/  
Catch Basin

Surface  
Drainage

Elevated  
Landform

Flat Area

Low/ Depressed  
Landform



# MTG. 2 – GENERAL TAKEAWAYS



- Park is very important to the neighborhood and the community is highly engaged
- Overall layout of park is working – maintained in 3 options presented
- Play Spaces
  - Lots of enthusiasm for expanded playground
  - Careful placement of gates for safety/child management
  - Courts also important for overall play experience
- Green space
  - Ensure visibility with any topographic changes
  - Maintain space for community events
  - Provide more seating

LEGEND

-  Playground
-  Street Hockey
-  Basketball
-  Lawn/Passive Area

# SURVEY UPDATE

## WHO WE HEARD FROM

**19 Responses at Mtg #2**  
**48 Responses at Mtg #3**

### Where do you live?

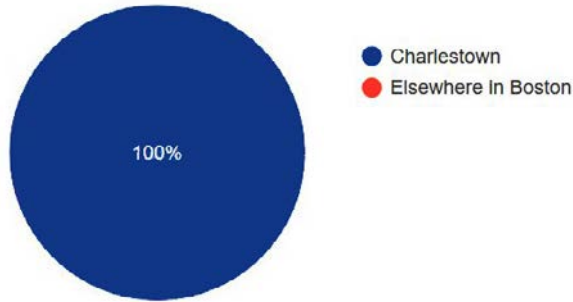

### How old are you?

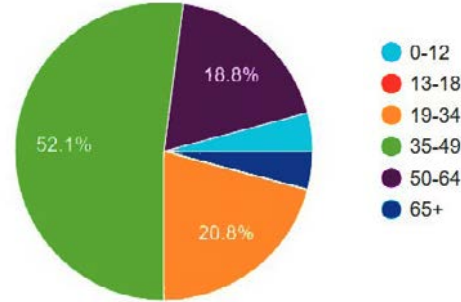

### Do you have children that use the playground?

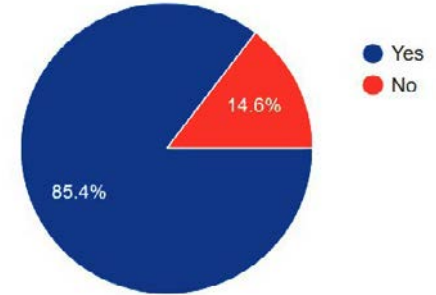

### About how often do you visit?

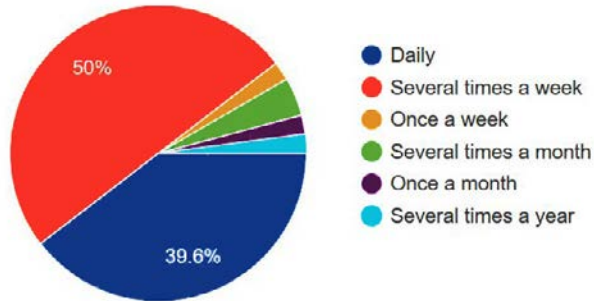

### If you have children, how old are they?

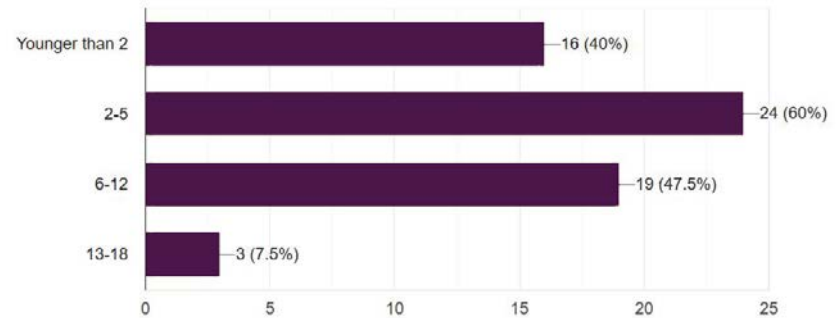

### How long does it take to get to the park from your home?

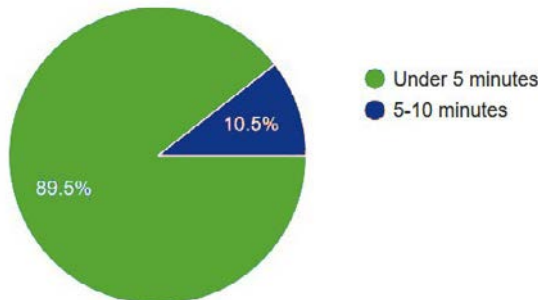

### Did you attend the first meeting at the Golden Age Center?

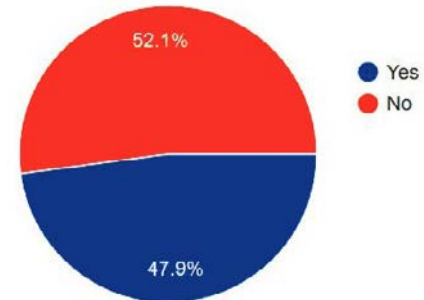

# SURVEY UPDATE

## WHAT WE HEARD

When you visit, what do you like to do?

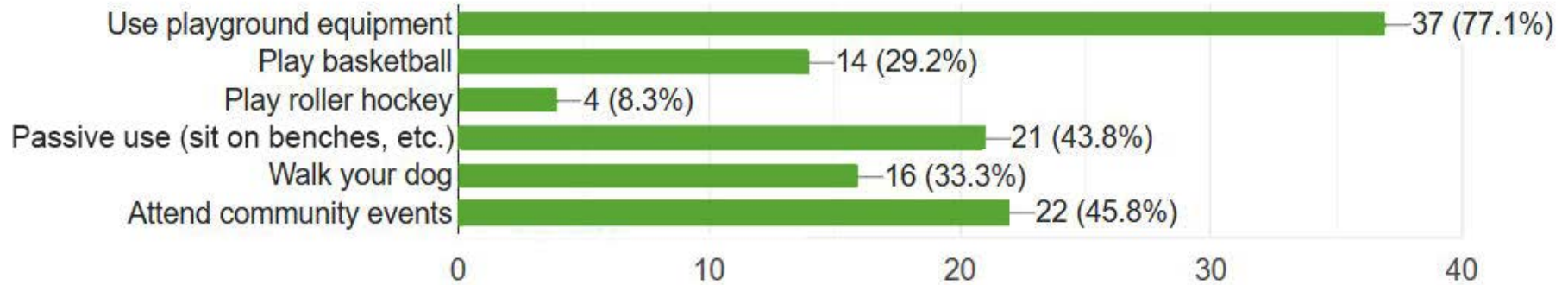

Other responses: ride bikes & scooters, fly kites, play ball games

What is your first priority in improving the park?



# SURVEY UPDATE

## WHAT WE HEARD

What types of play equipment are you most interested in seeing?

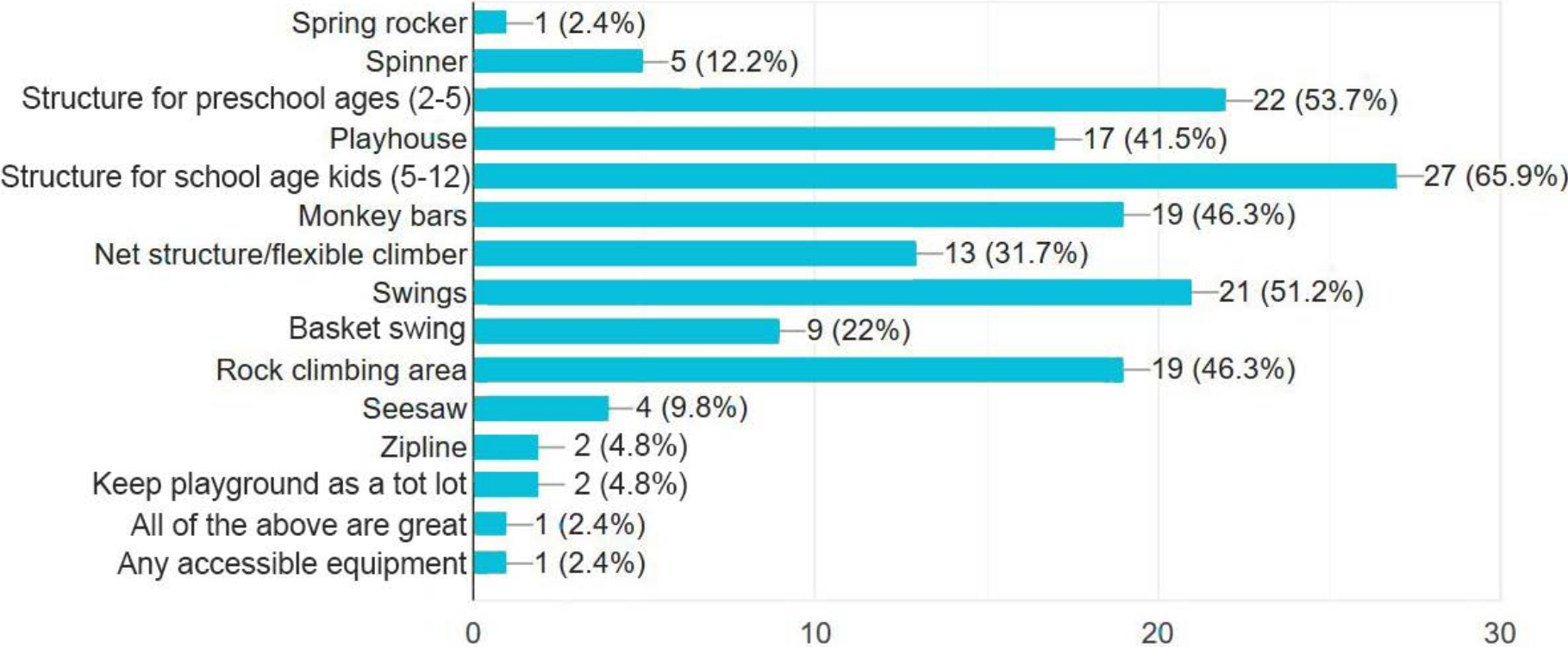

# SURVEY UPDATE

## WHAT WE HEARD

What other amenities are you interested in seeing?

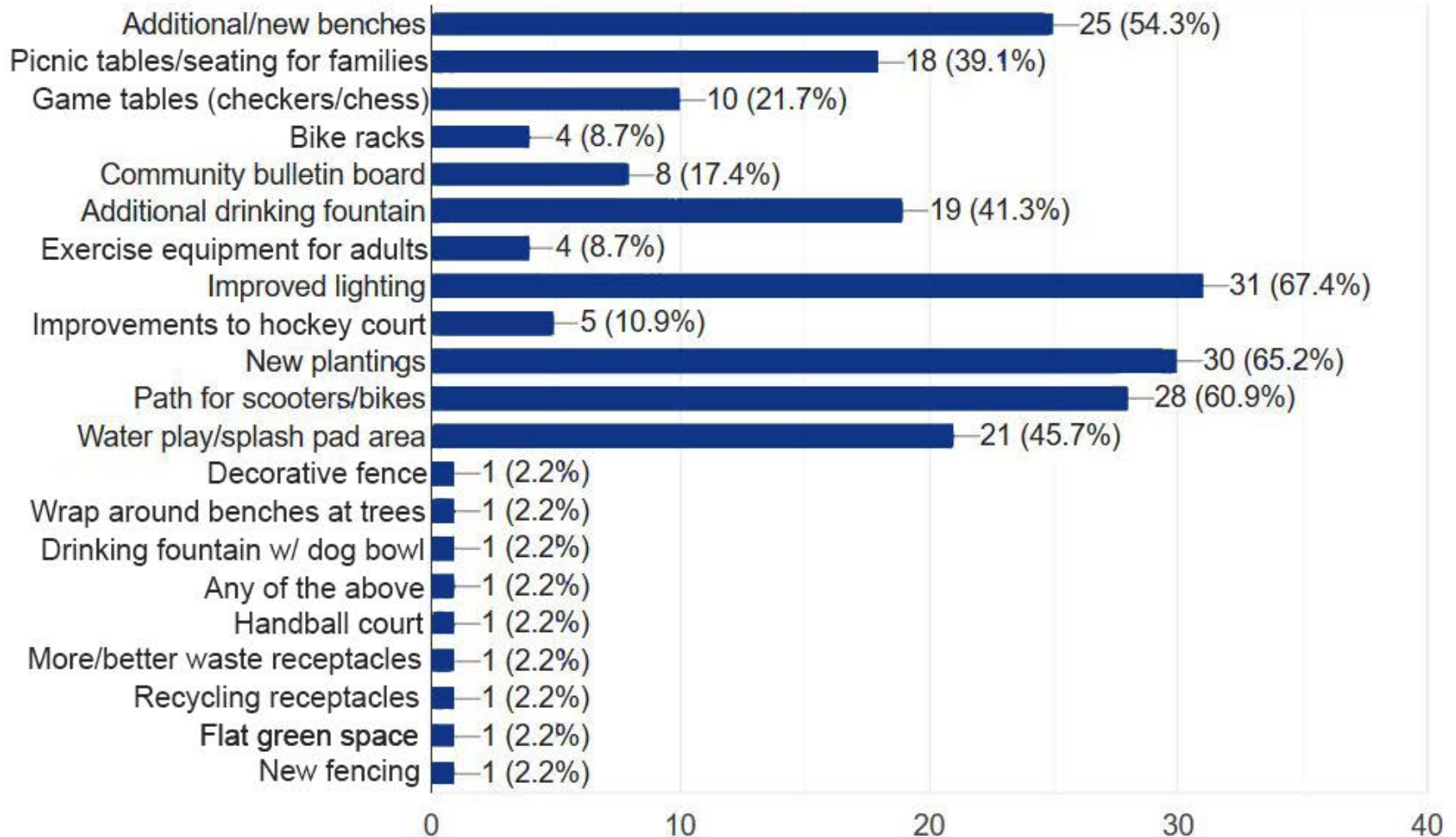

# MTG. #2 - OPTIONS



**Option 1**



**Option 2**



**Option 3**

# MTG. #2 – LAWN OPTIONS

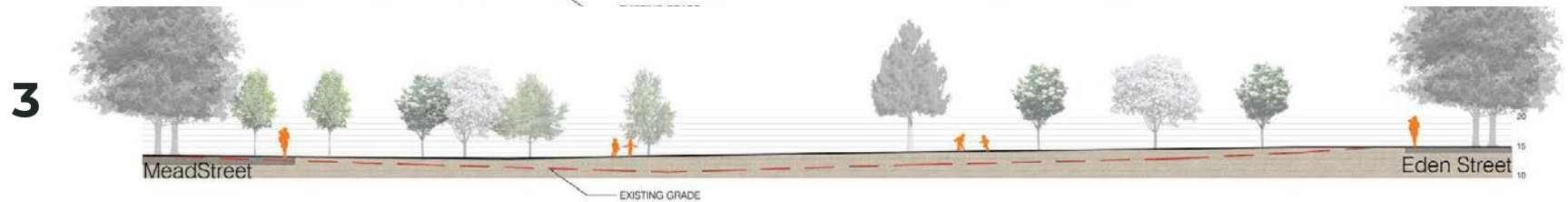
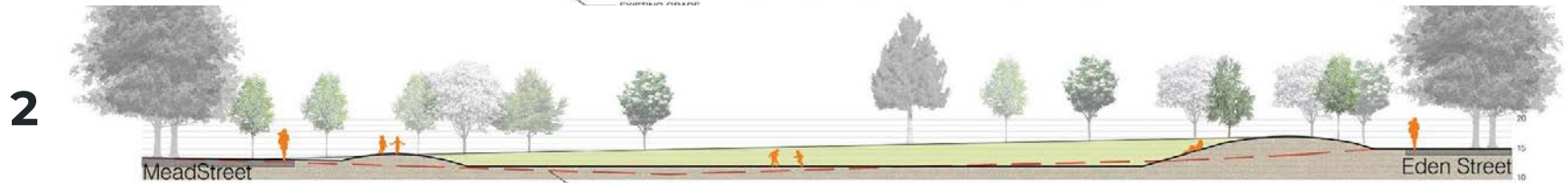
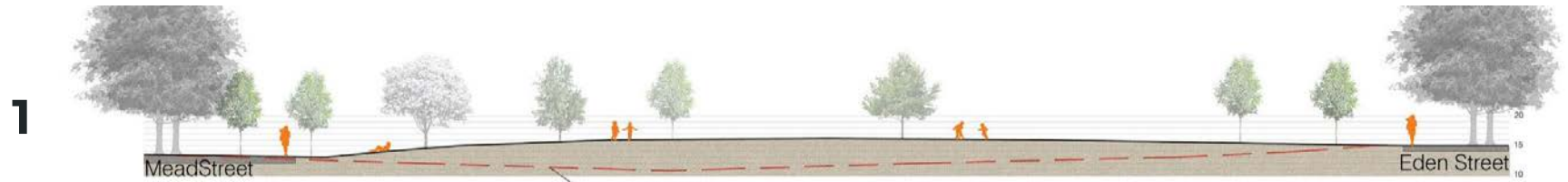
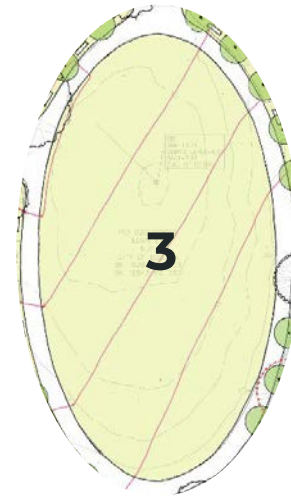
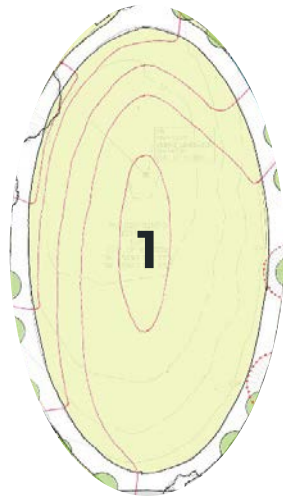

# MTG. #2 – PREFERENCES





# HYBRID PLAN



# HYBRID PLAN

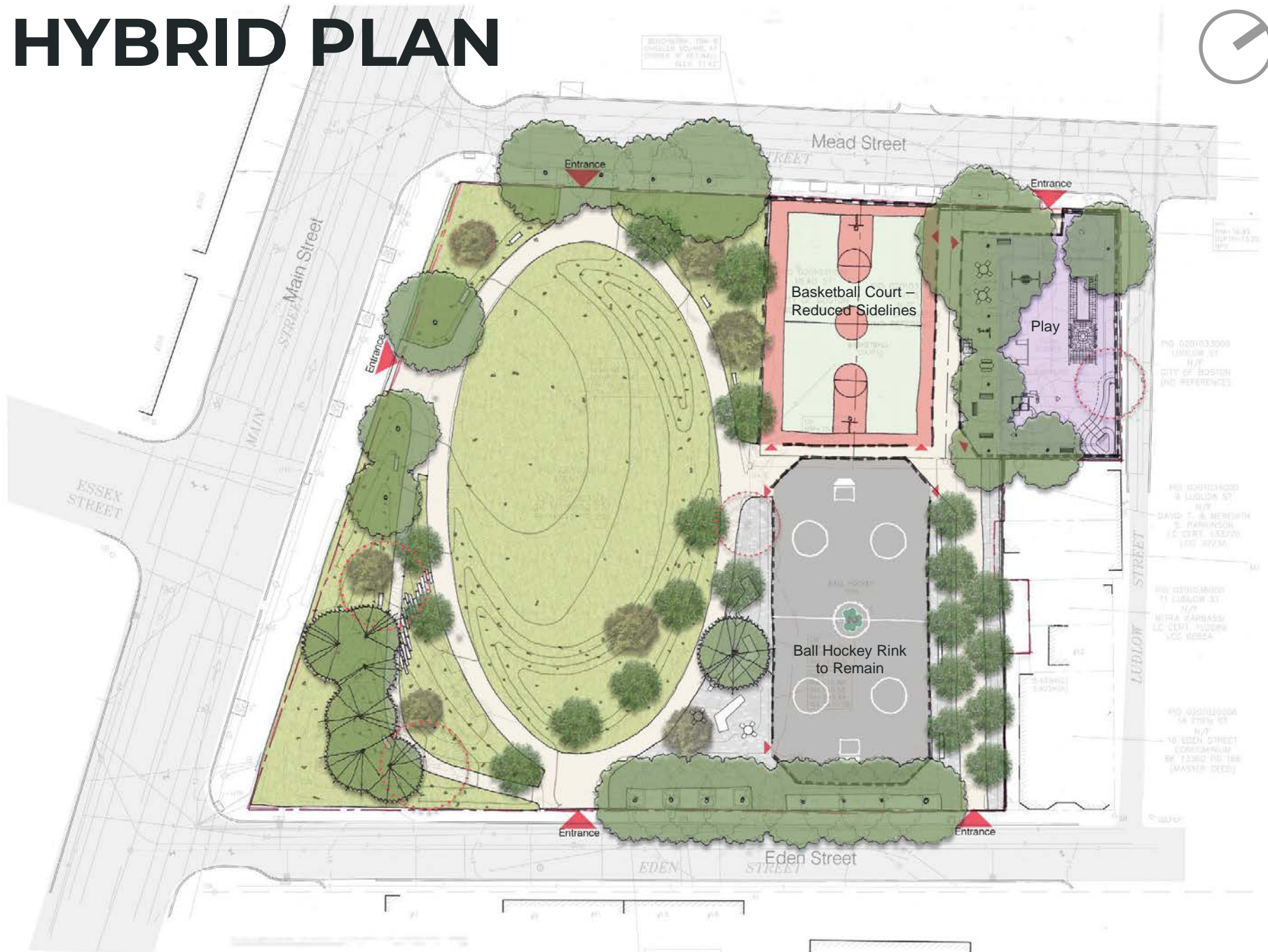

# HYBRID PLAN



ENLARGED PLAY  
AREA, MORE DETAIL  
TO FOLLOW

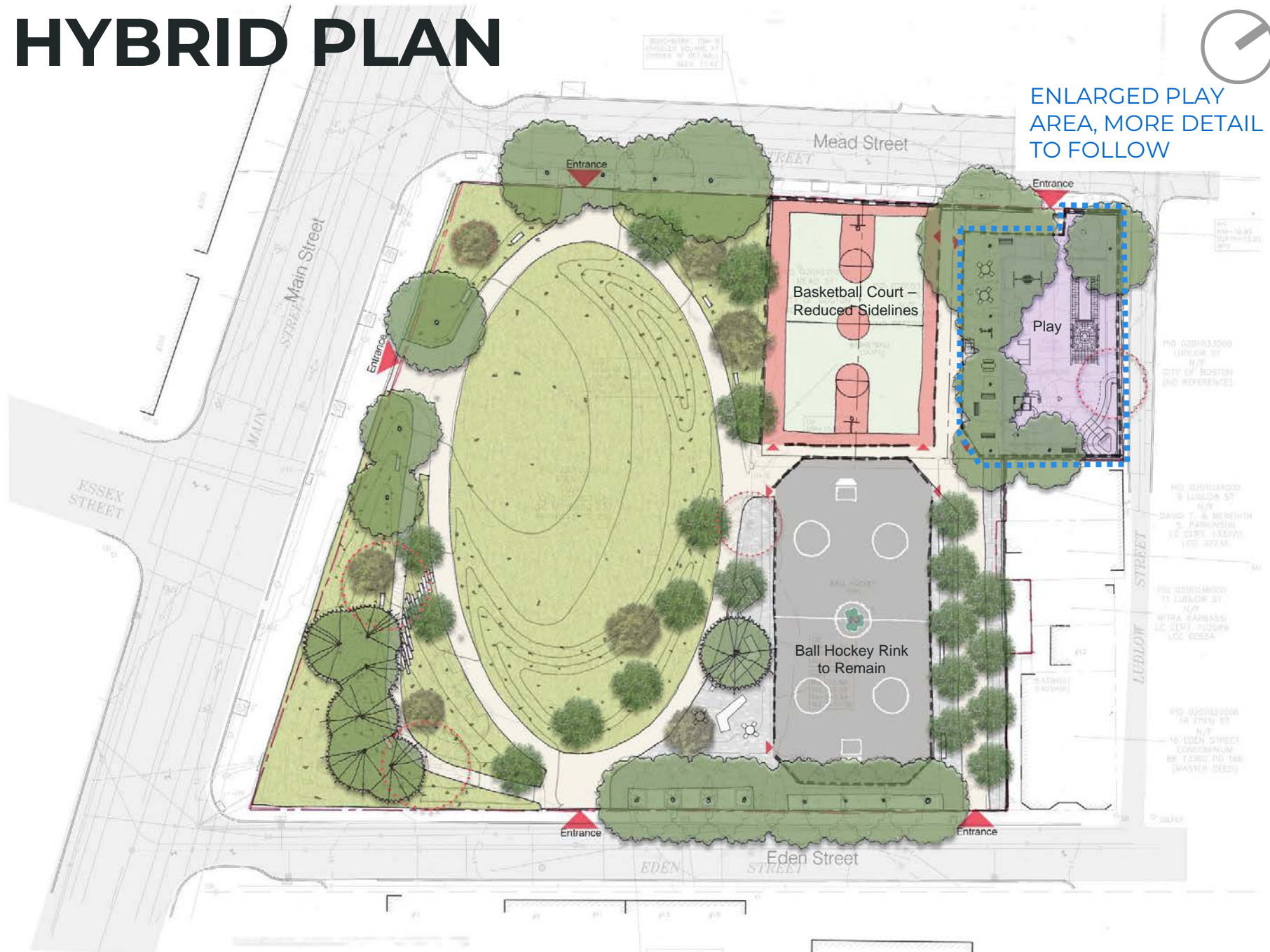

# FENCING

EXISTING

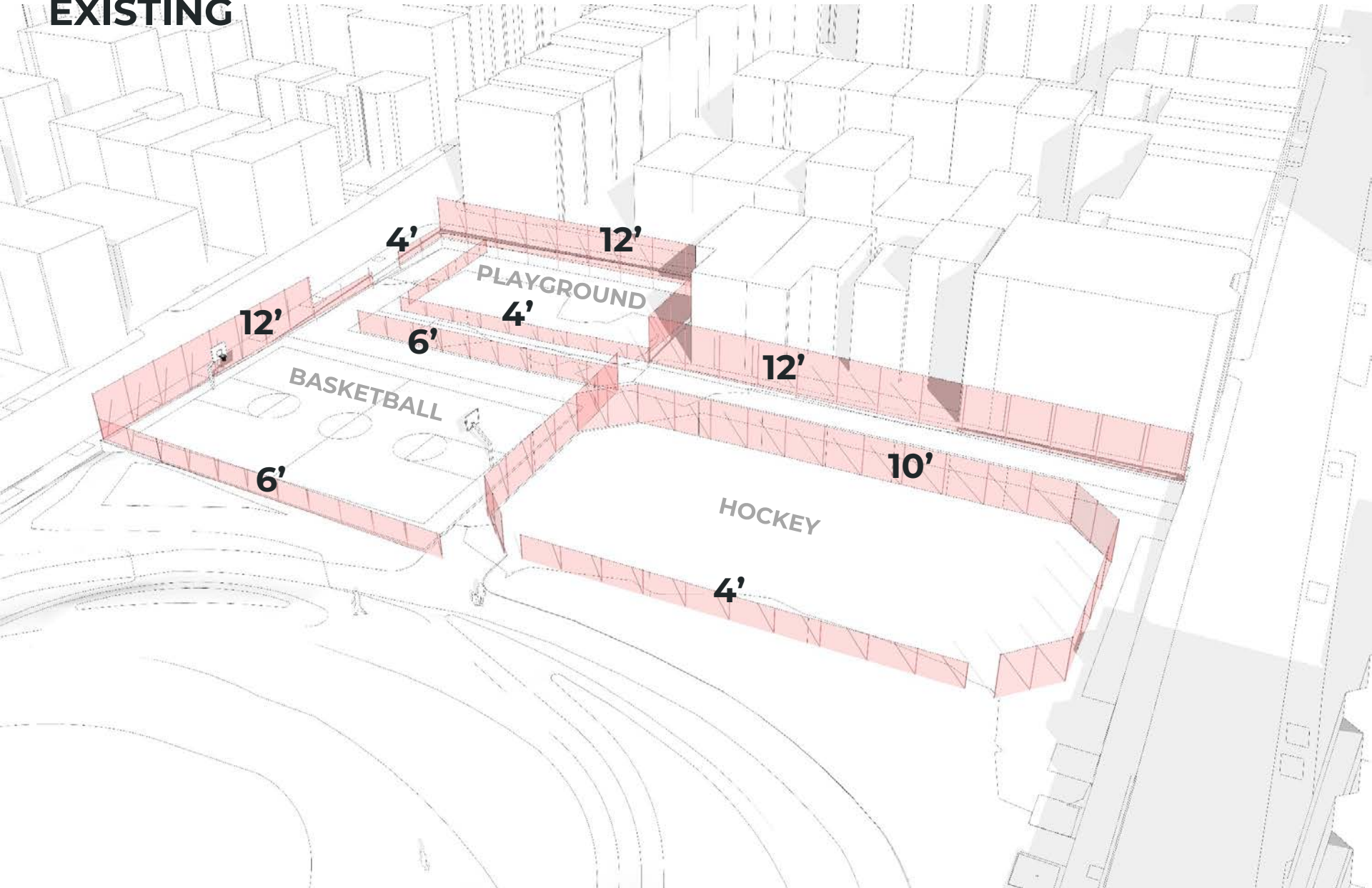

# FENCING

PORTIONS TO BE REMOVED

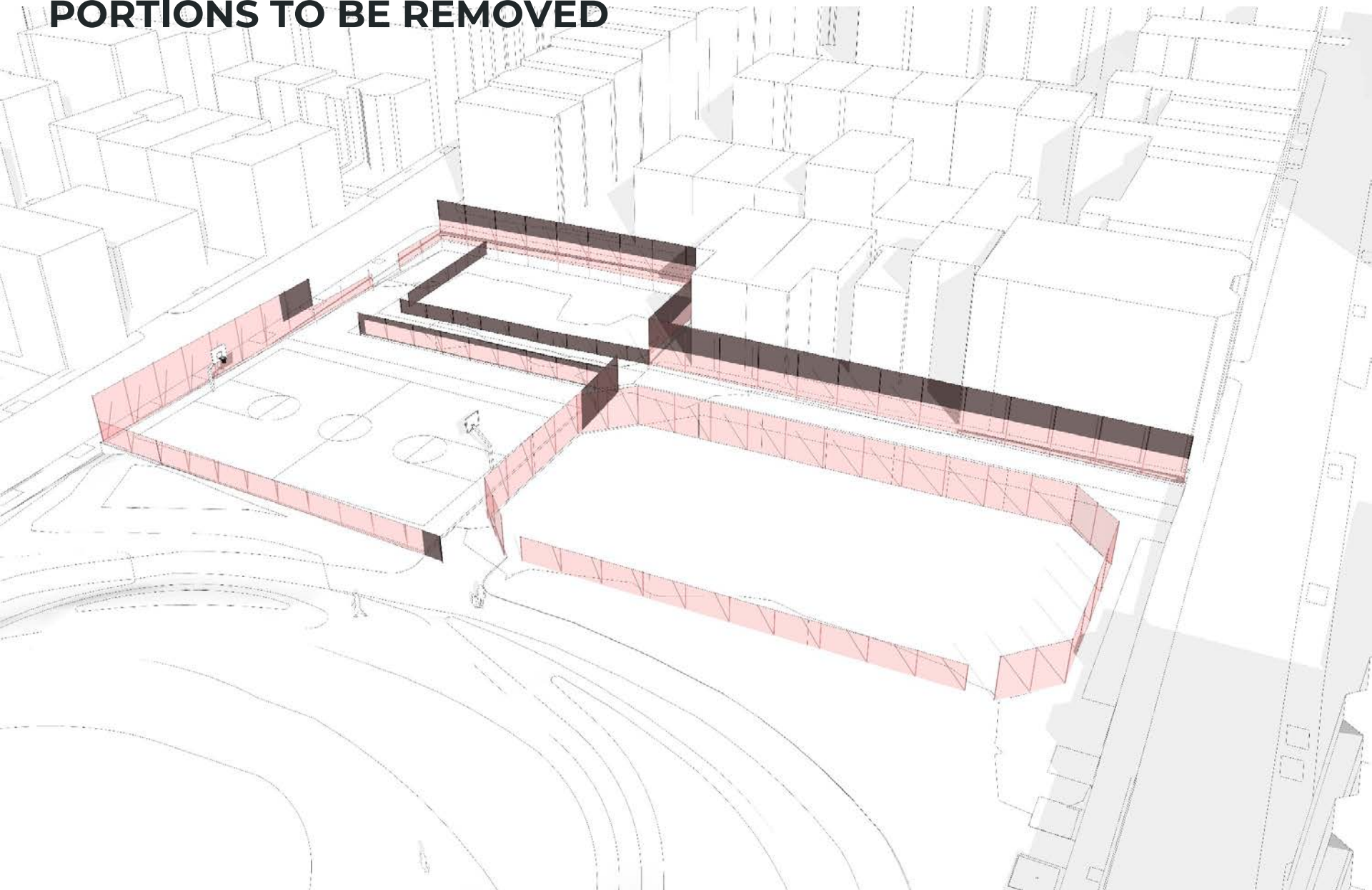

# FENCING

## ADDITIONS

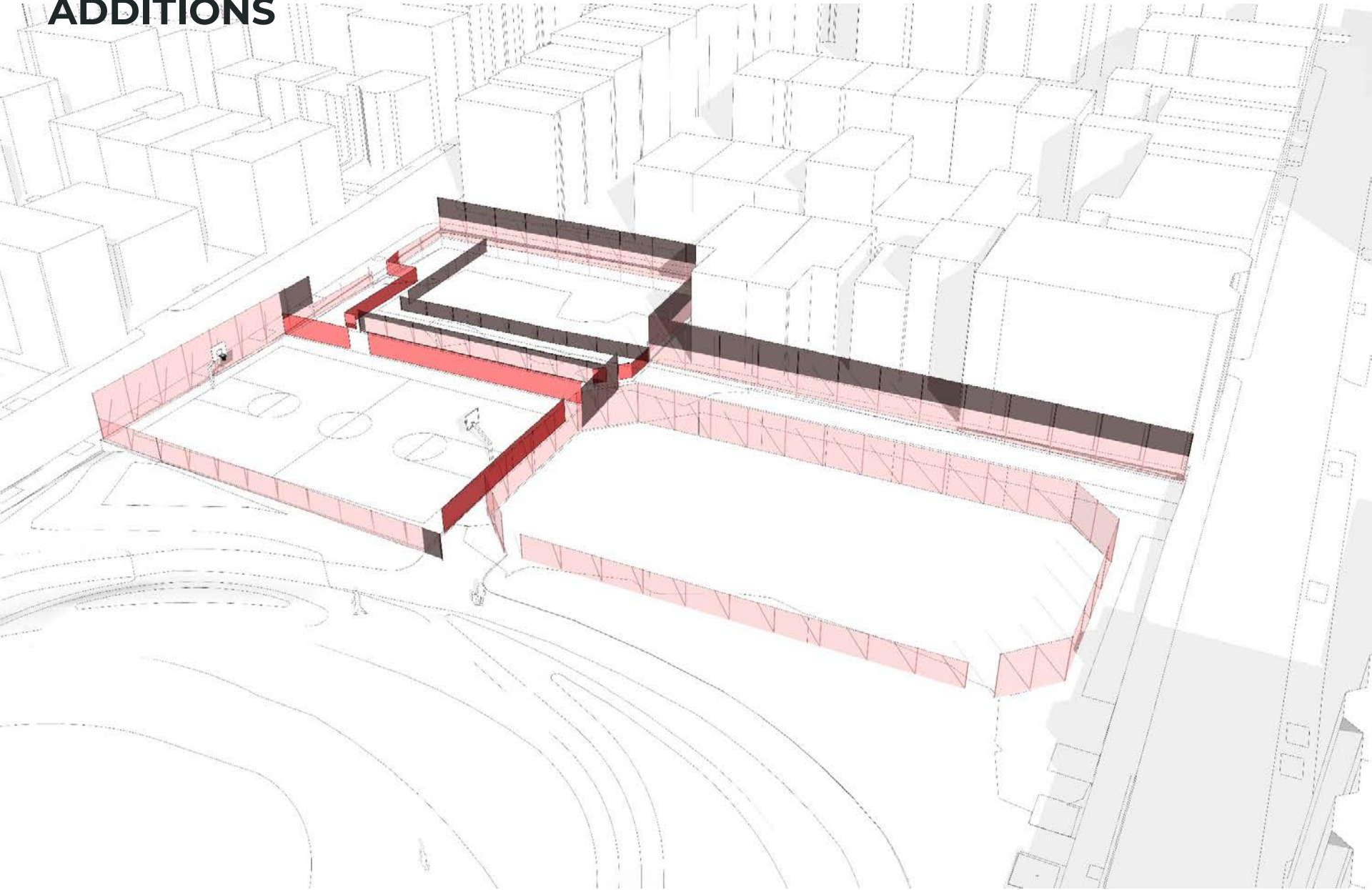

# FENCING

PROPOSED

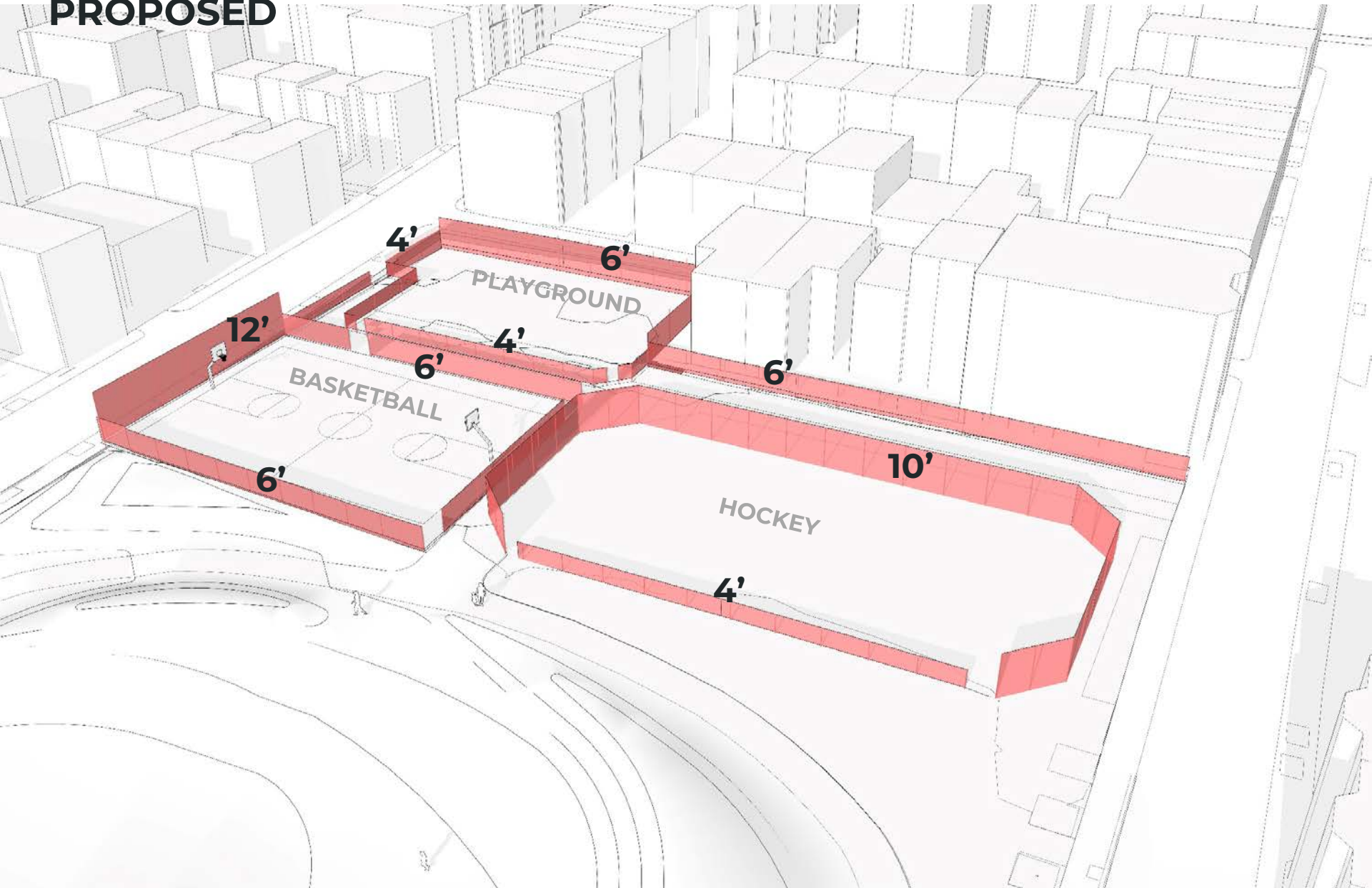

# HYBRID PLAN

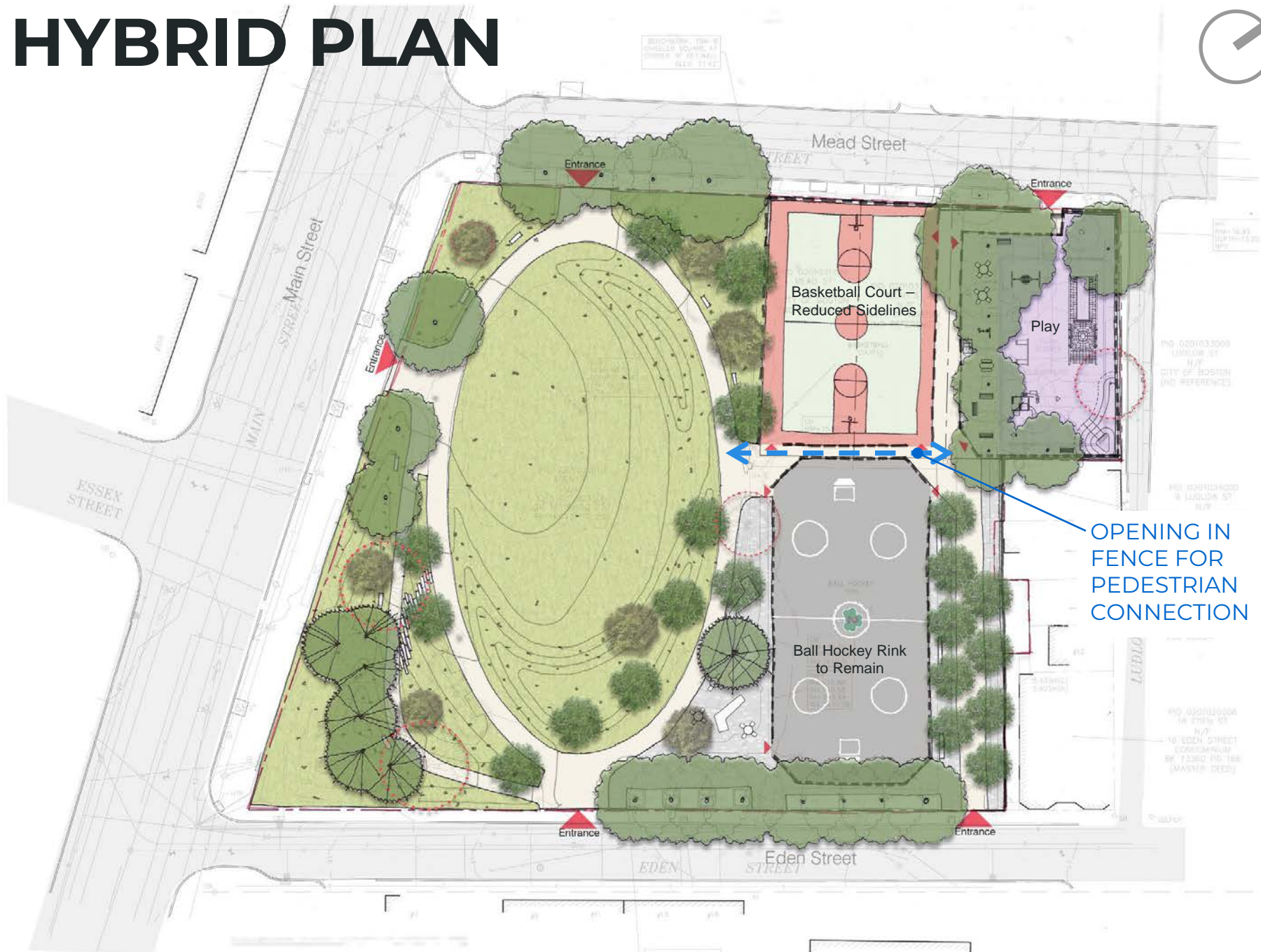



# HYBRID PLAN

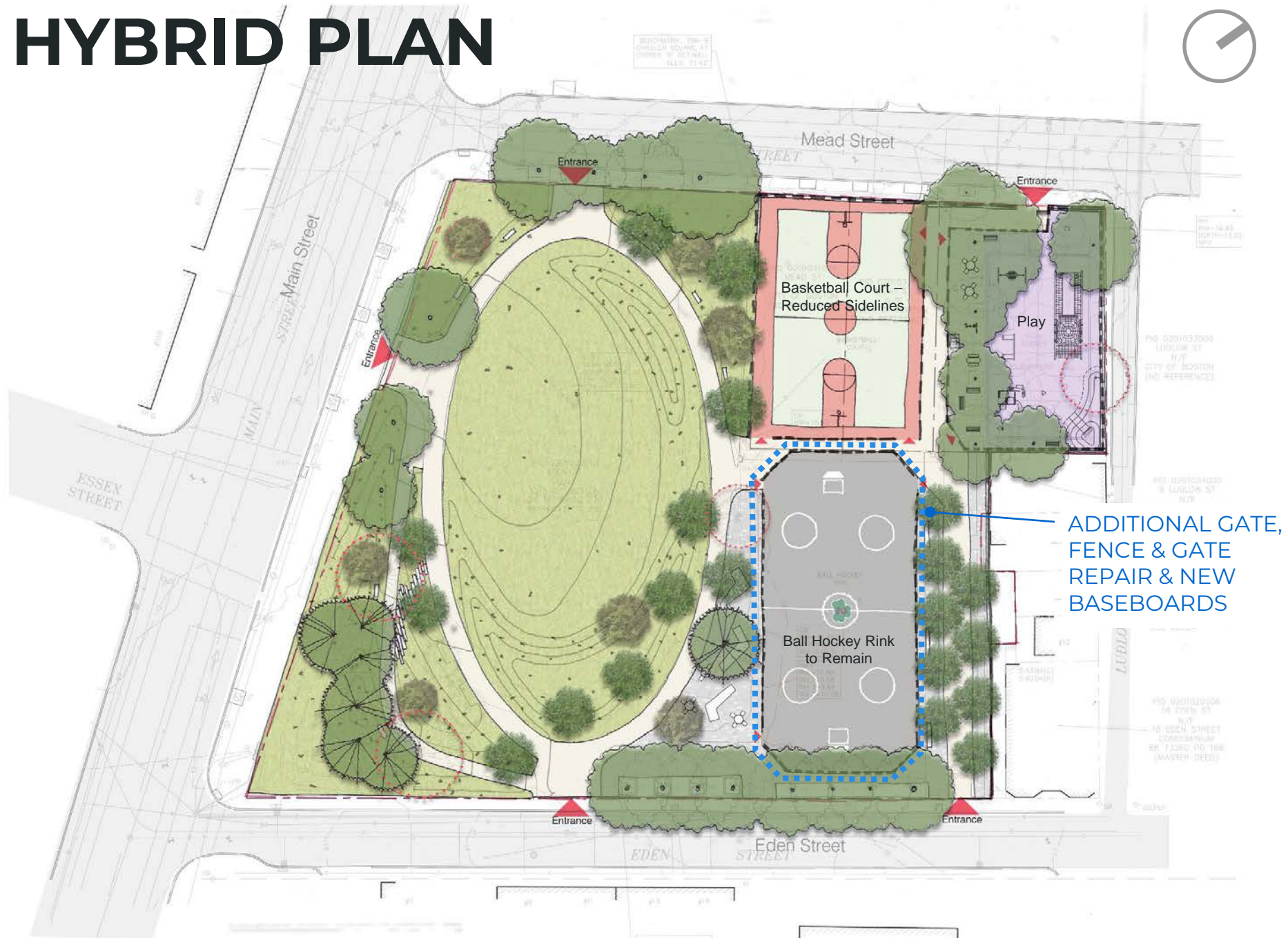

# HYBRID PLAN

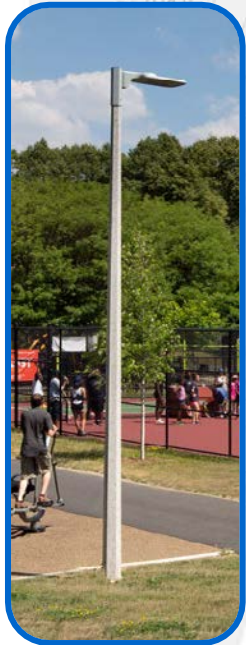

BENCHES,  
LIGHTING & TREES

# HYBRID PLAN



SEATING & TABLES



Main Street

Mead Street

Entrance

Entrance

Basketball Court –  
Reduced Sidelines

Play

Ball Hockey Rink  
to Remain

Entrance

Entrance

Eden Street

LEDLOW STREET

PD 0201033000  
100 LUDLOW ST  
N/T  
CITY OF BOSTON  
(NO REFERENCE)

PD 0201024000  
8 LUDLOW ST  
N/T  
DAVID T. & MEREDITH  
S. FARMANOW  
16 CRET. 133070  
100 422M

PD 0201024000  
11 LUDLOW ST  
N/T  
NETA BARBASS  
16 CRET. 100000  
100 4260A

PD 0201030004  
16 EDEN ST  
N/T  
10 EDEN STREET  
COMMERCIAL  
BY 13300 (NO TREE  
MASTER DEED)

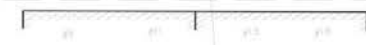

# HYBRID PLAN

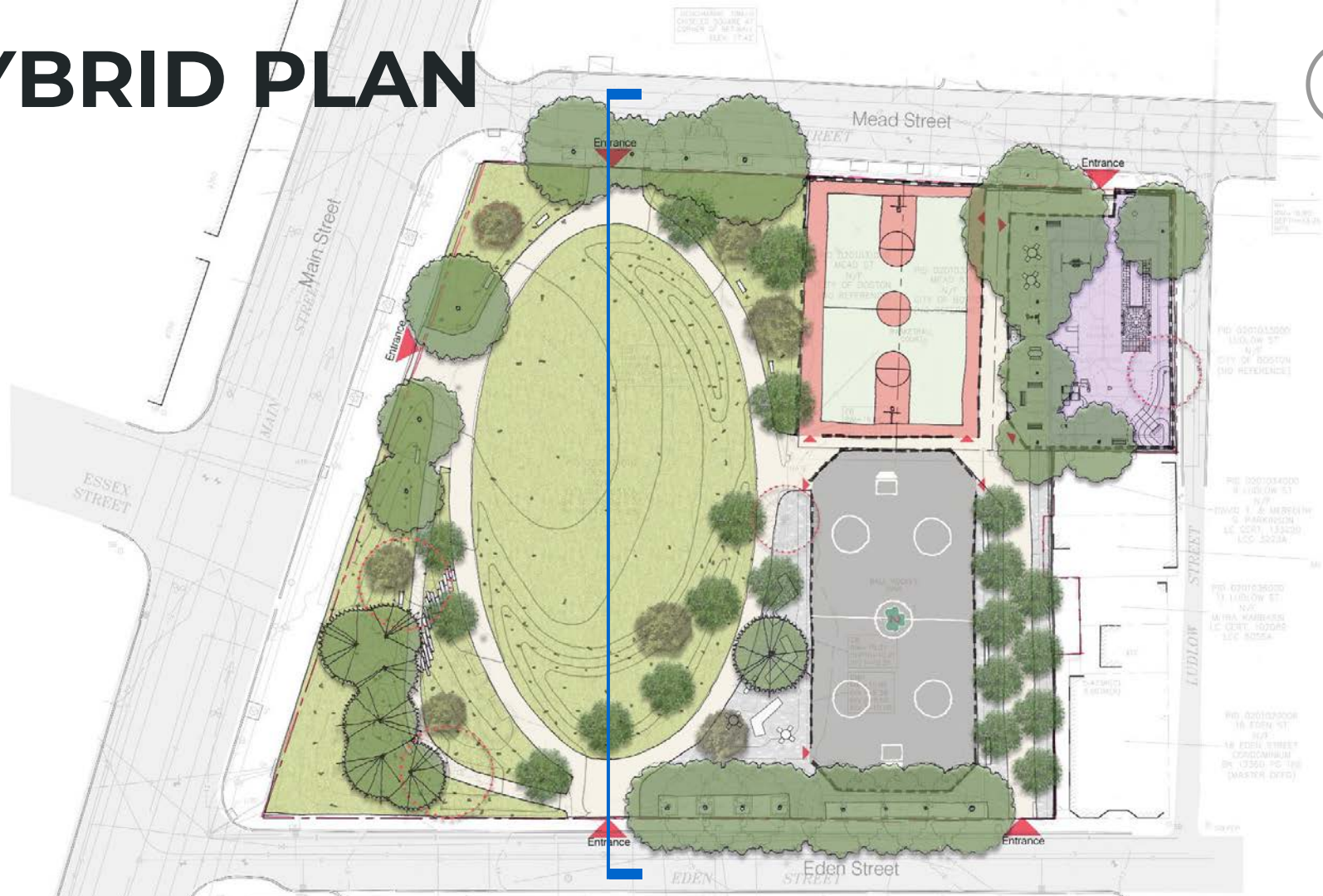

LAWN ENCLOSED WITH LOW KNOLLS

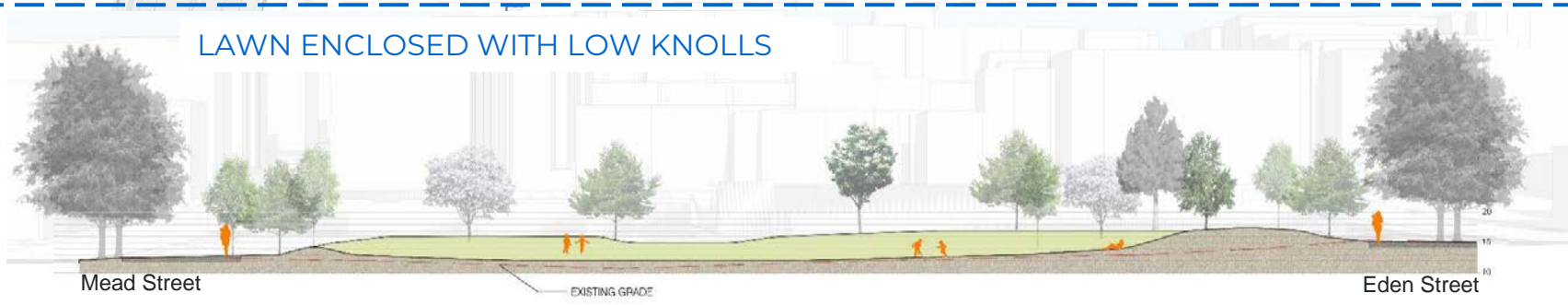

# HYBRID PLAN

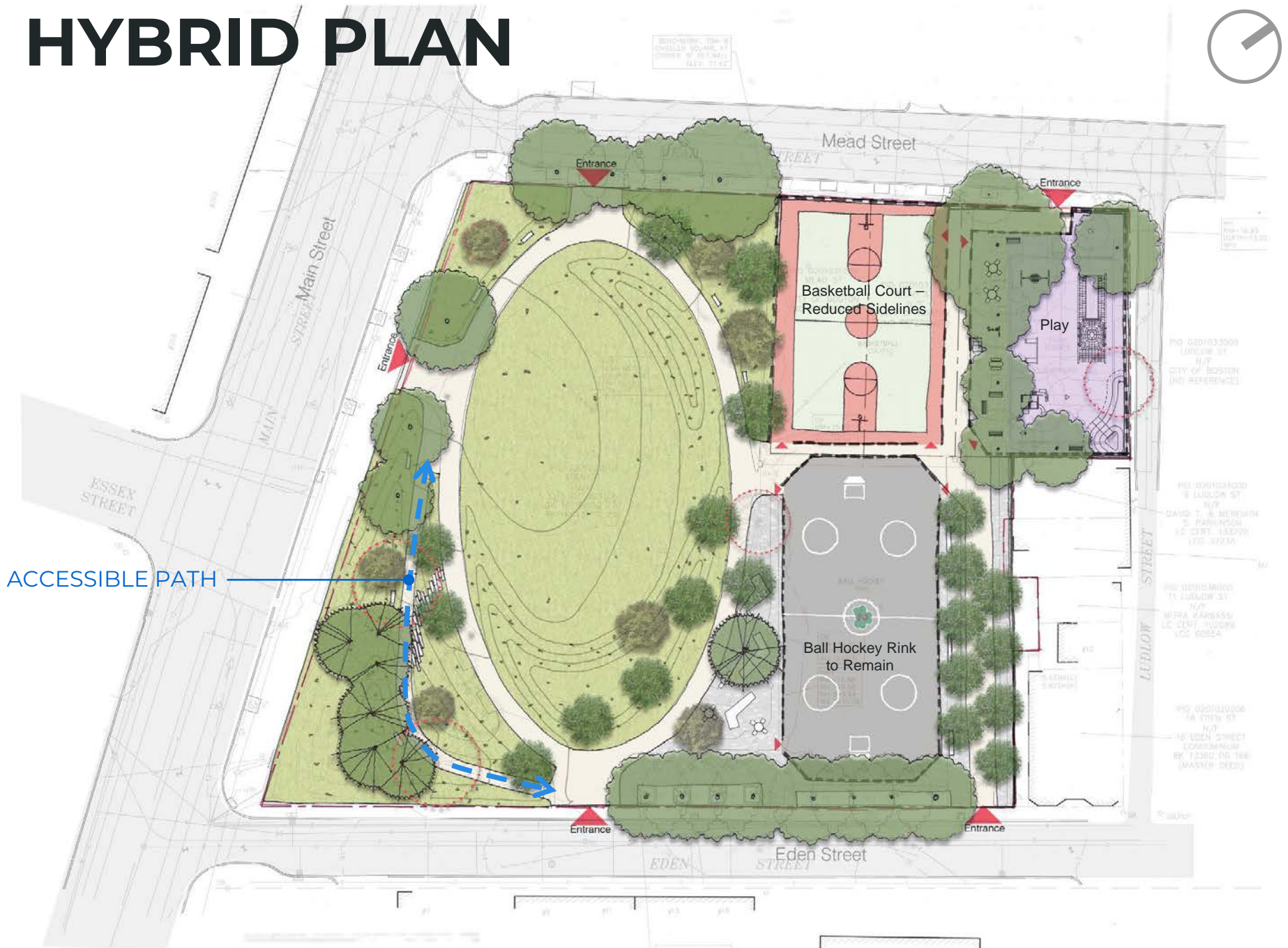

ACCESSIBLE PATH

# HYBRID PLAN



HILL SCRAMBLE



# HYBRID PLAN



BENCHES, LIGHTING & TREES



# POSSIBLE CPA-FUNDED ADDITIONS



WATER PLAY – 2 POTENTIAL LOCATIONS



GARDEN BEDS – REQUIRE FRIENDS GROUP FOR MAINTENANCE





PLAY



# PLAY

## SIZE COMPARISON

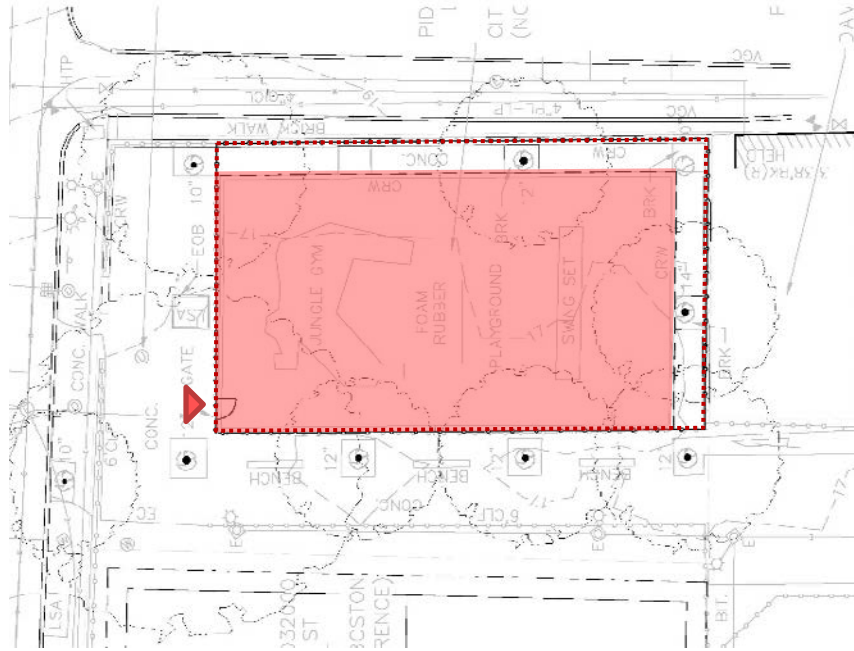

**Existing**

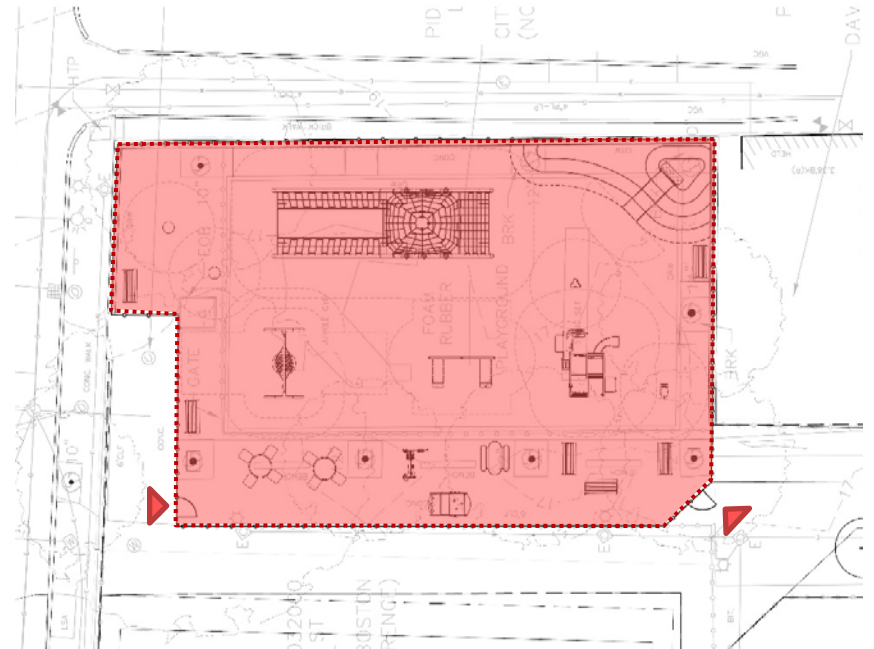

**Proposed**

# PLAY

## Hybrid Option

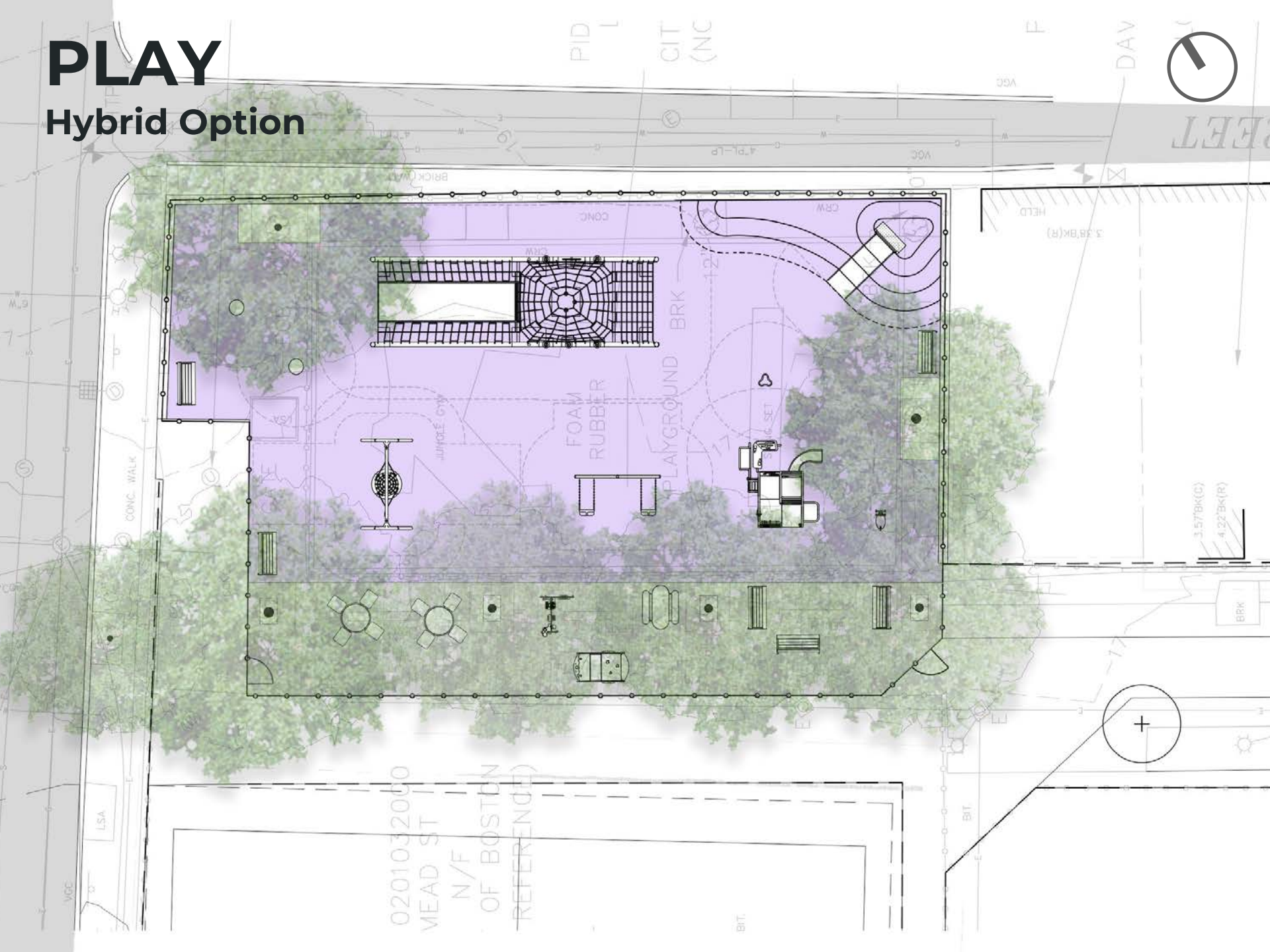

# PLAY

## Hybrid Option

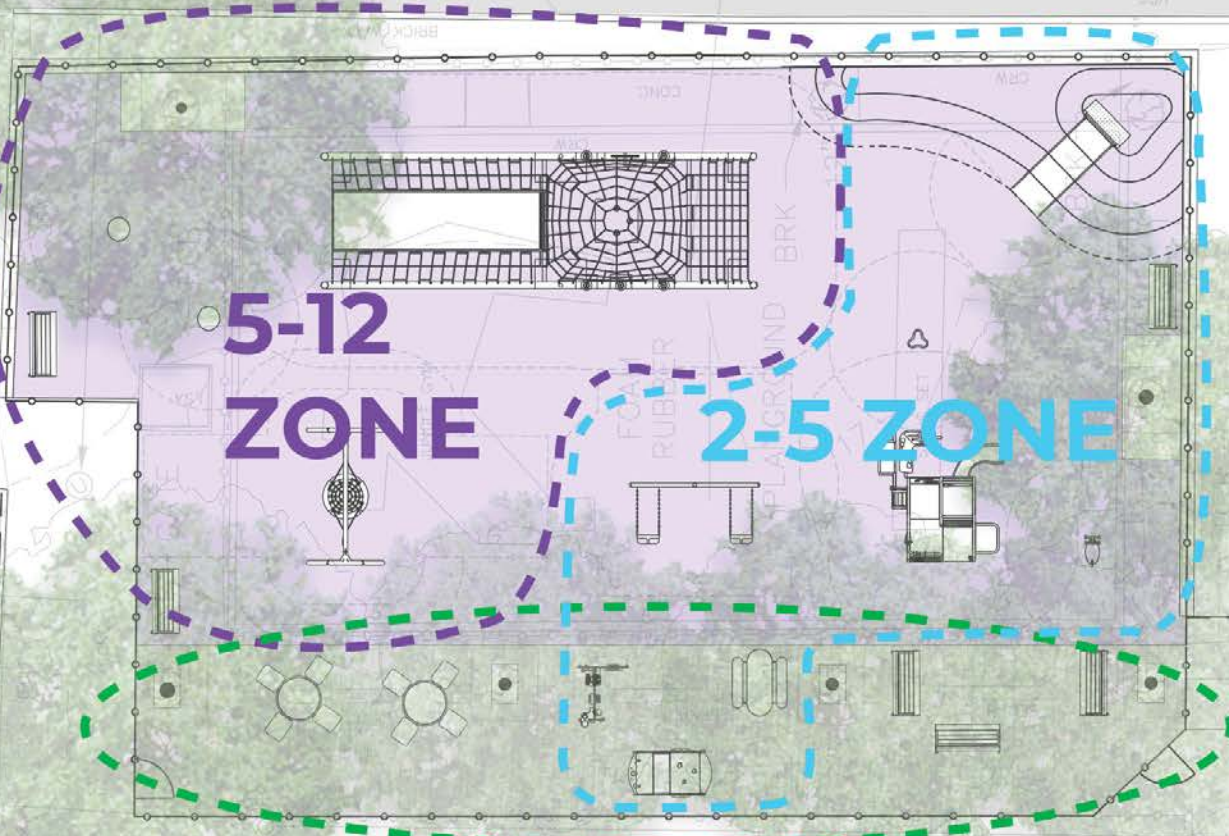

**5-12  
ZONE**

**2-5 ZONE**

**FURNISHING/QUIET PLAY**

0201032000  
WEAD ST  
N/F  
OF BOSTON  
(REFERENCE)

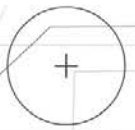

# PLAY

## 2-5 ZONE



# PLAY

## 2-5 ZONE

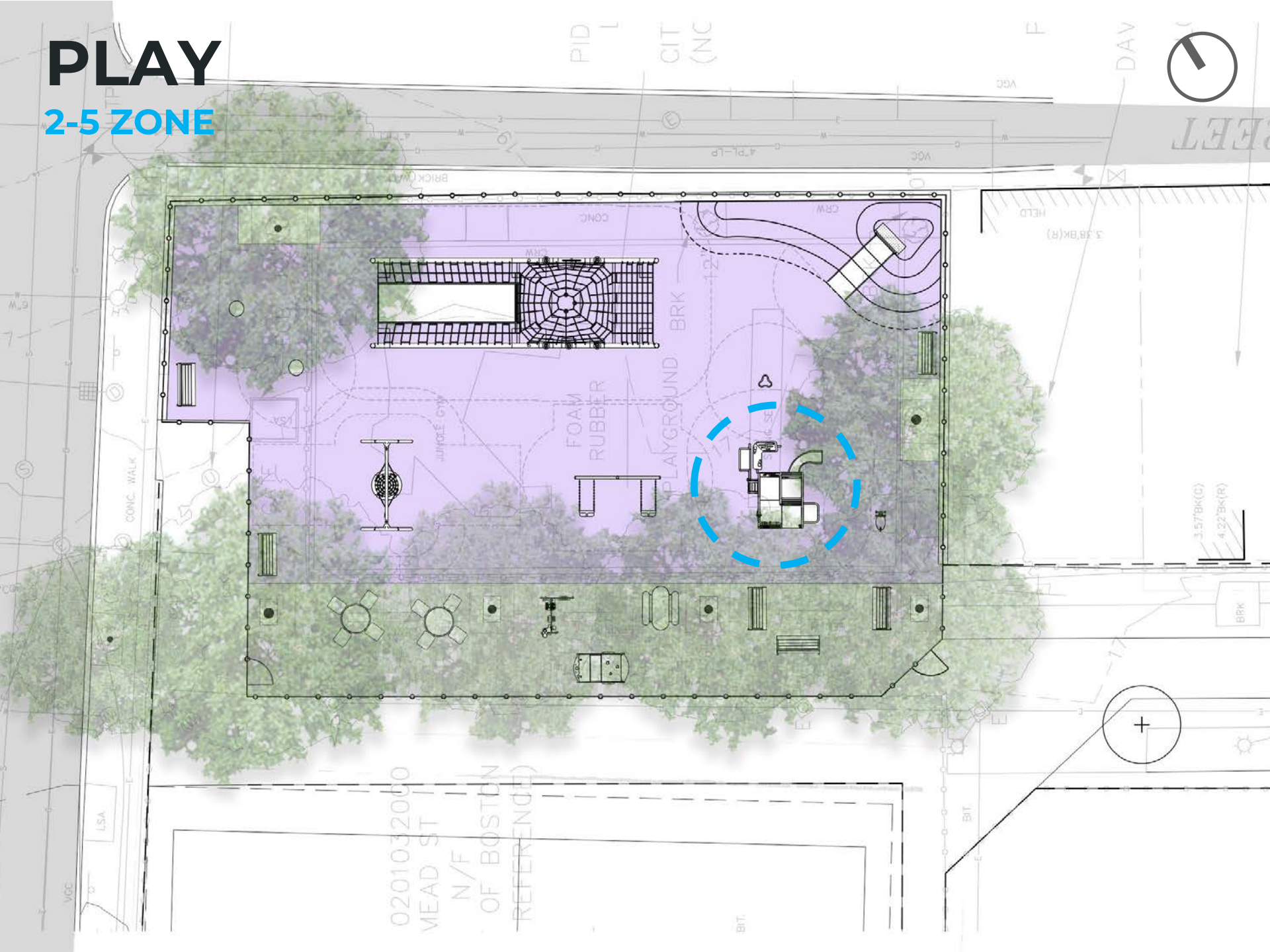

0201032000  
MEAD ST  
N/F  
OF BOSTON  
REFERENCE)

FEET

# PLAY

## 2-5 ZONE



# PLAY

## 2-5 ZONE

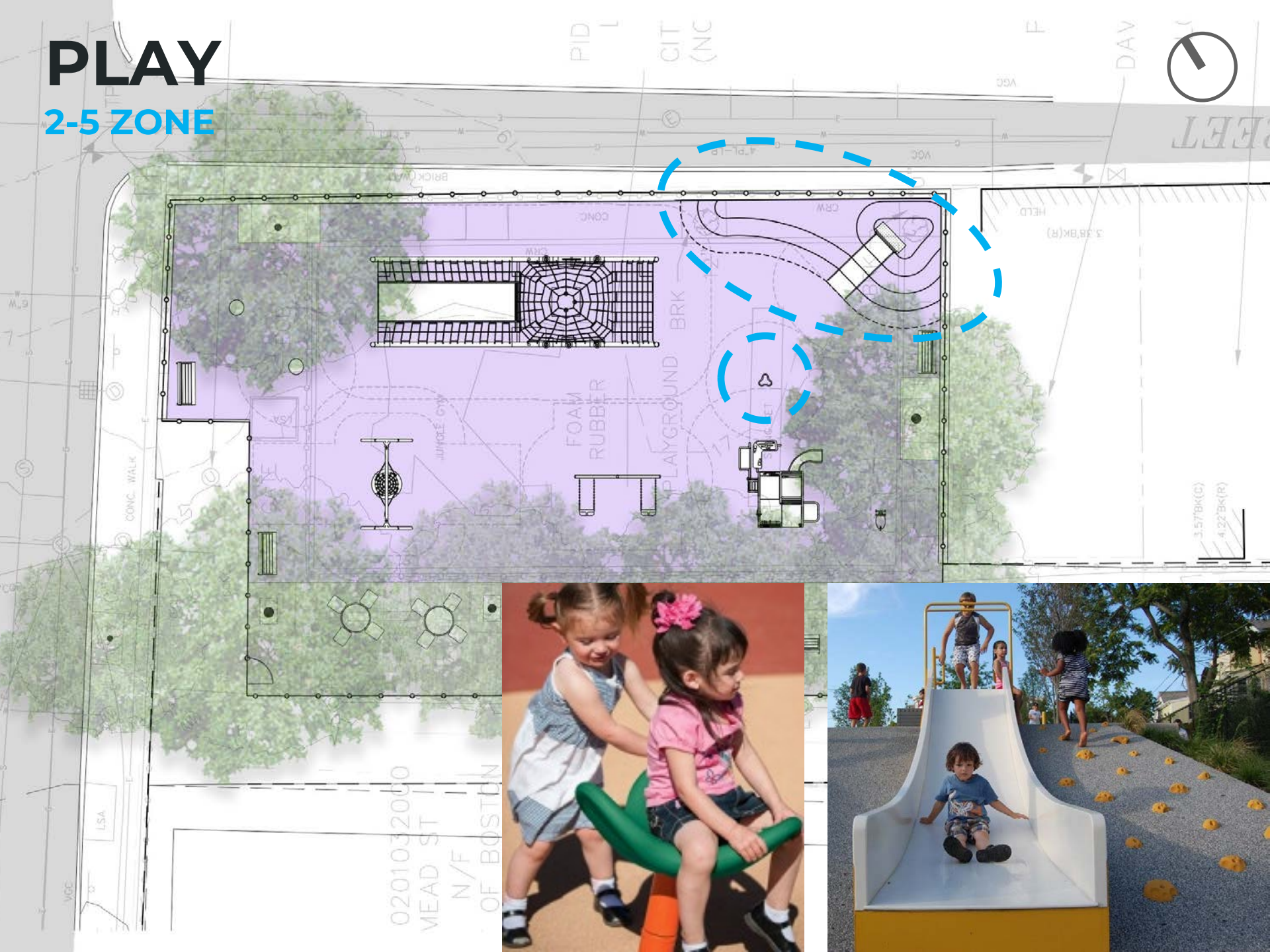



# PLAY

## 2-5 ZONE

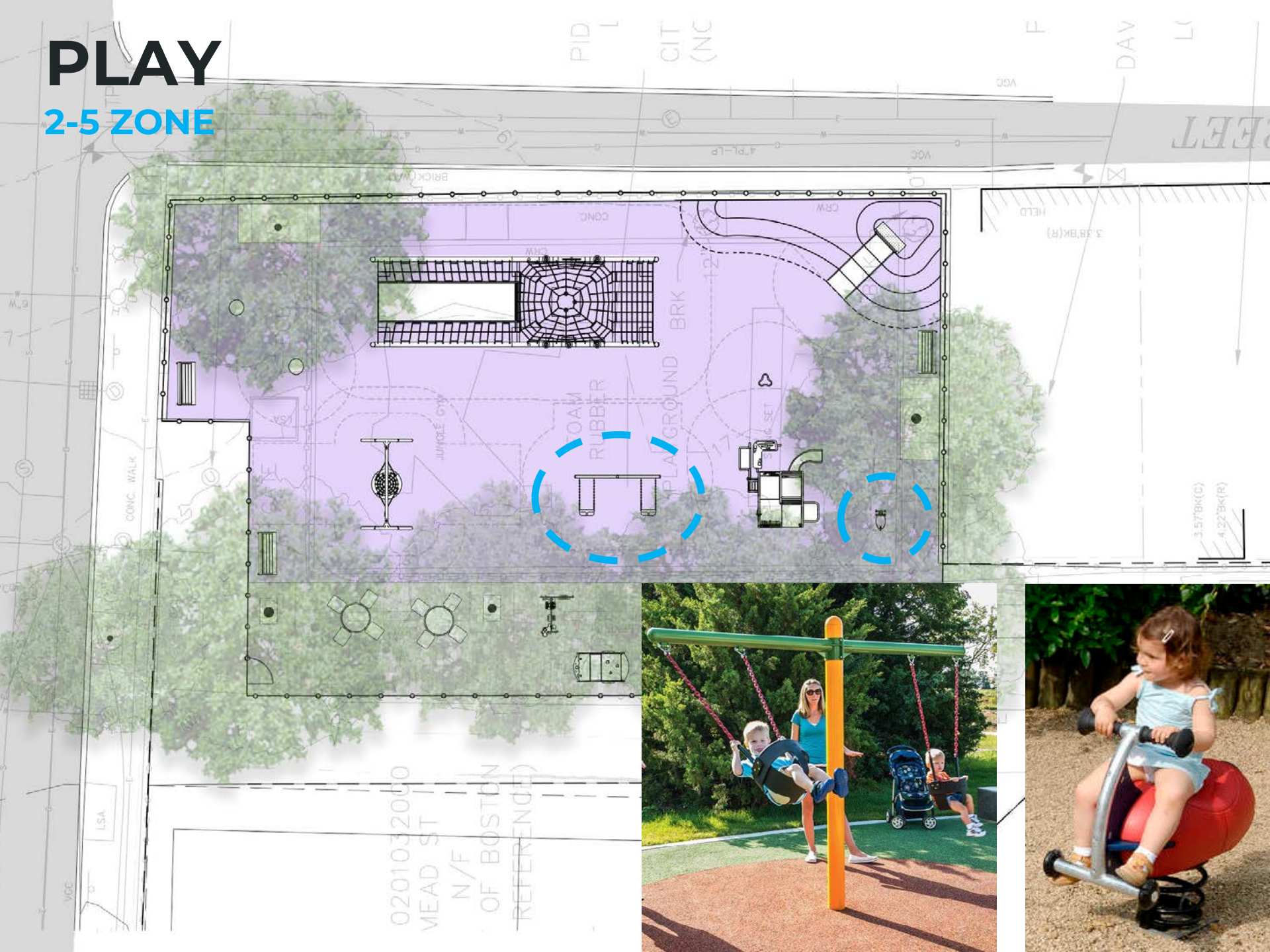

# PLAY

## 2-5 ZONE

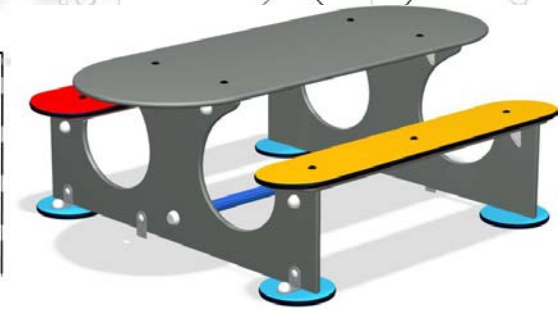
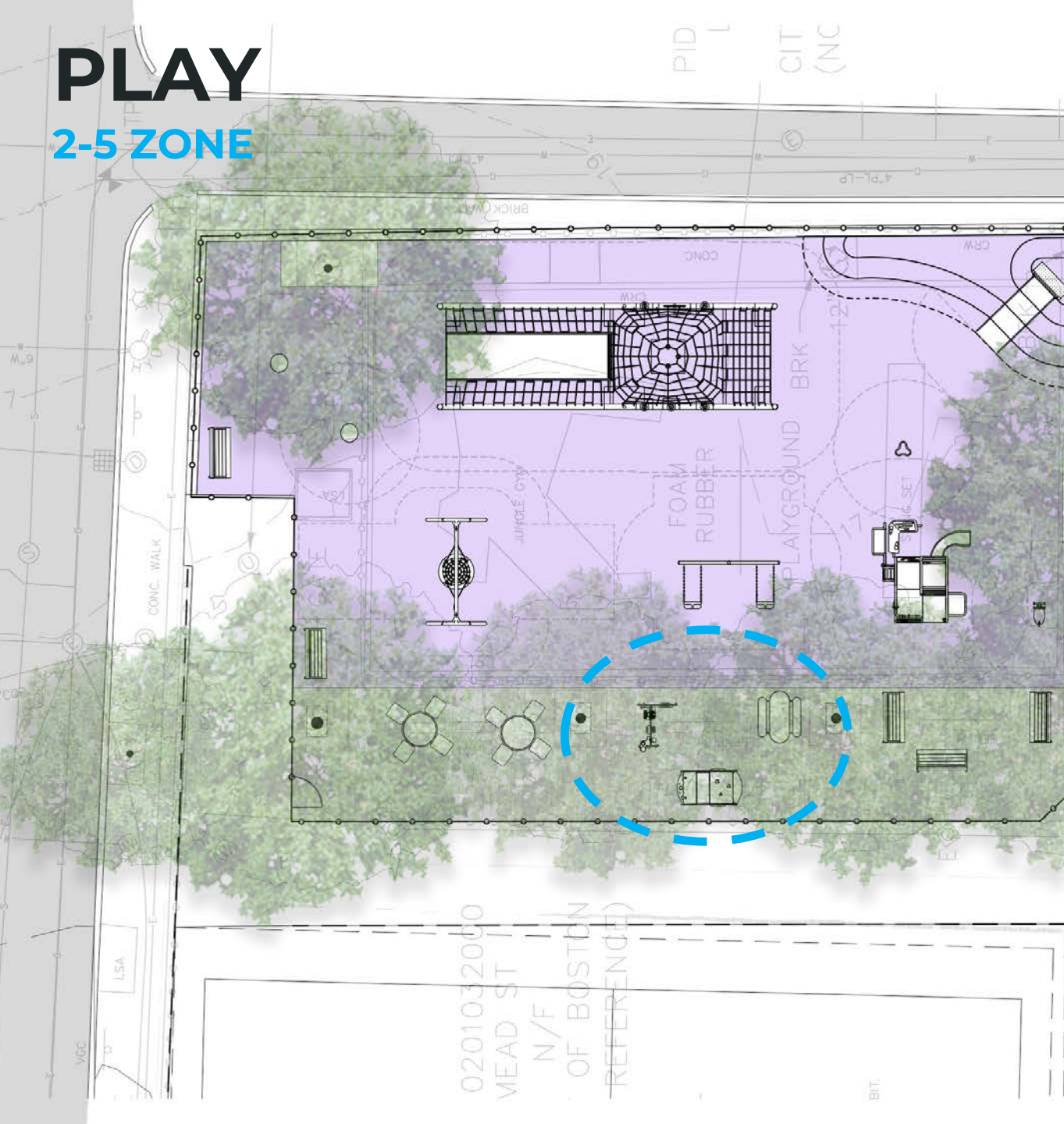

# PLAY

## 5-12 ZONE



# PLAY

## 5-12 ZONE

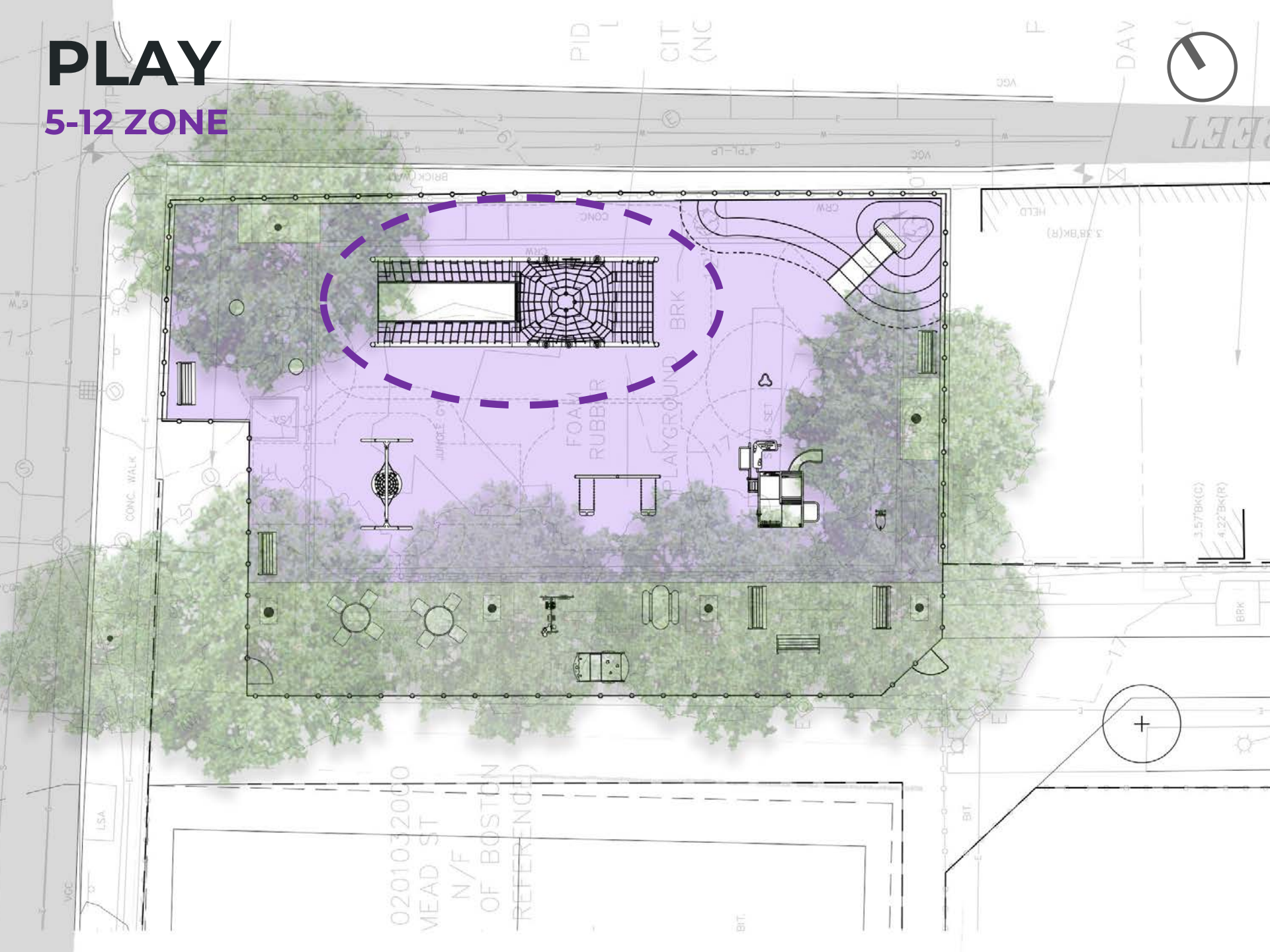

0201032000  
MEAD ST  
N/F  
OF BOSTON  
REFERENCE)

FEET

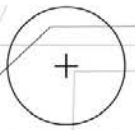

# PLAY

5-12 ZONE



# PLAY

## 5-12 ZONE



# PLAY

## FURNITURE/ QUIET PLAY ZONE

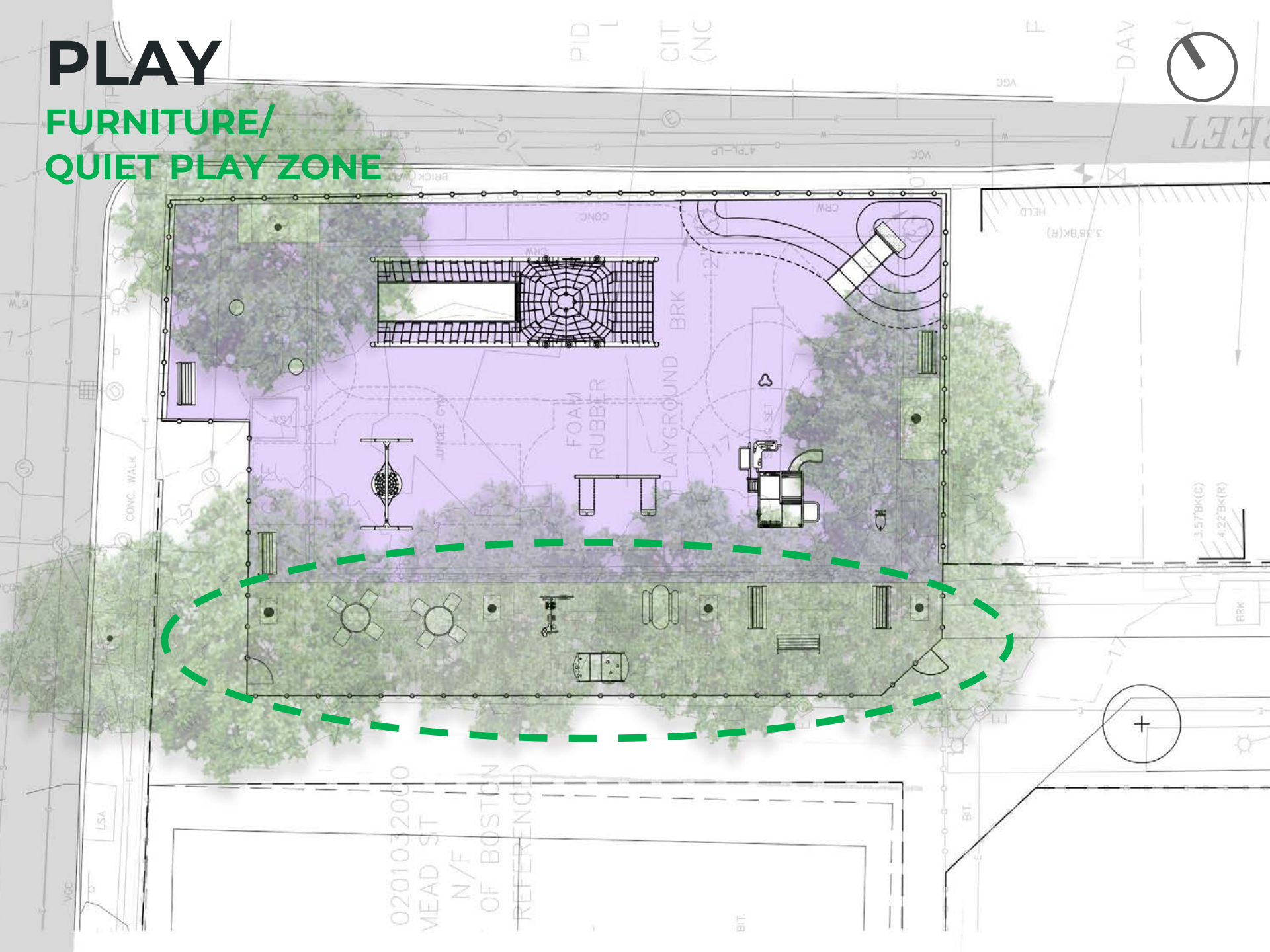

# PLAY

## FURNITURE/ QUIET PLAY ZONE

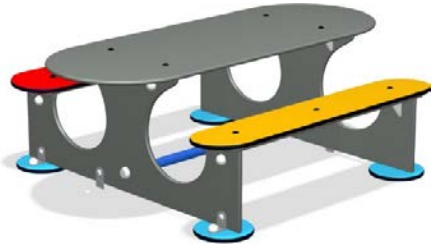

- BENCHES
- PICNIC TABLES & CHILD-SIZED TABLE
- SPACE FOR STROLLERS
- IMPROVED SOILS/PERMEABLE SURFACE TO SUPPORT TREES





# PLAY OPPORTUNITIES THROUGHOUT PARK

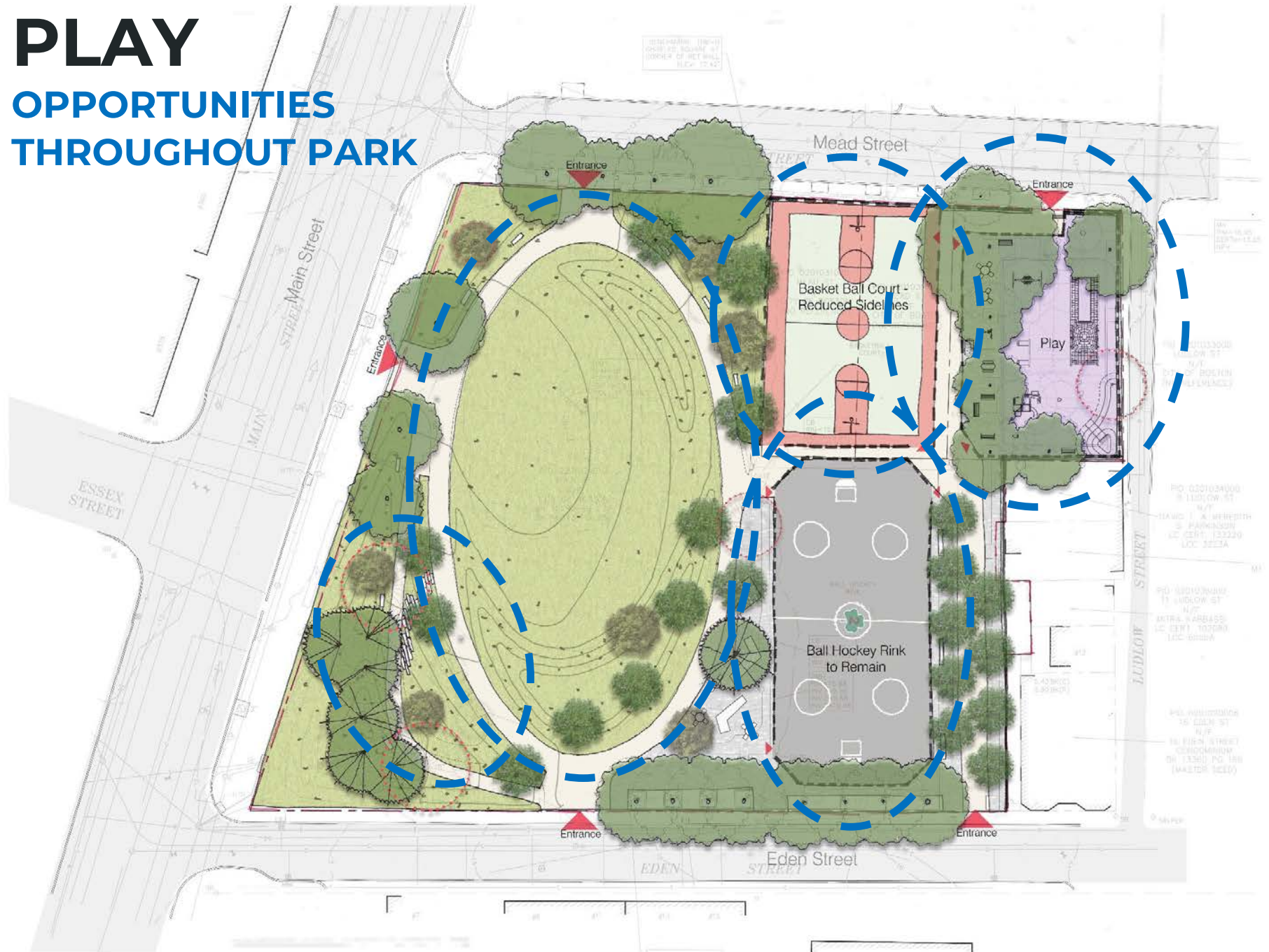



# LISTENING & DISCUSSION

Help us build great parks.  
Let us know what matters to you.



# THANK YOU!

## Construction starts Summer 2019!

For questions, maintenance requests or concerns regarding any of our parks contact 311

