

Improvements to James P. Kelleher Rose Garden

Boston, Massachusetts

HISTORIC PHOTOS



Fence was more exposed when the yews were shorter, 1932.



Hedge grew in to obscure the wire fence, 1940.



1931 Shurcliff Plan Overlaid on USGS Imagery

Improvements to James P. Kelleher Rose Garden

Boston, Massachusetts

EXISTING SITE PHOTOS

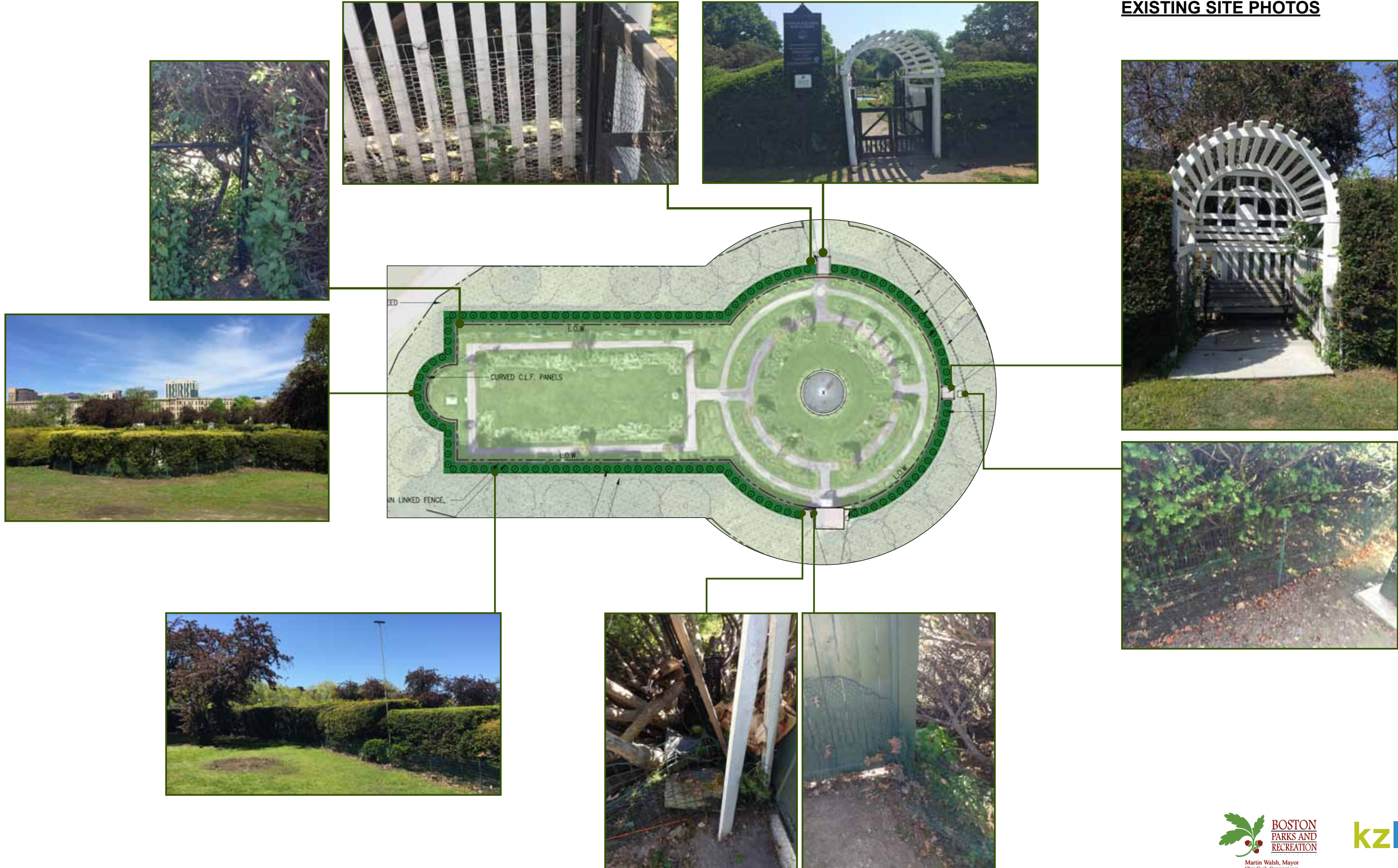

Improvements to James P. Kelleher Rose Garden

Boston, Massachusetts

