



Original deck and iron work

46 Dartmouth St

Emergency replacement of
roof that was leaking and
re-installation of the roof
deck



Original deck is not visible from the edge of opposite street corner sidewalk



The top of the original deck railing was just visible at the front from approximately 20 feet back from opposite street corner

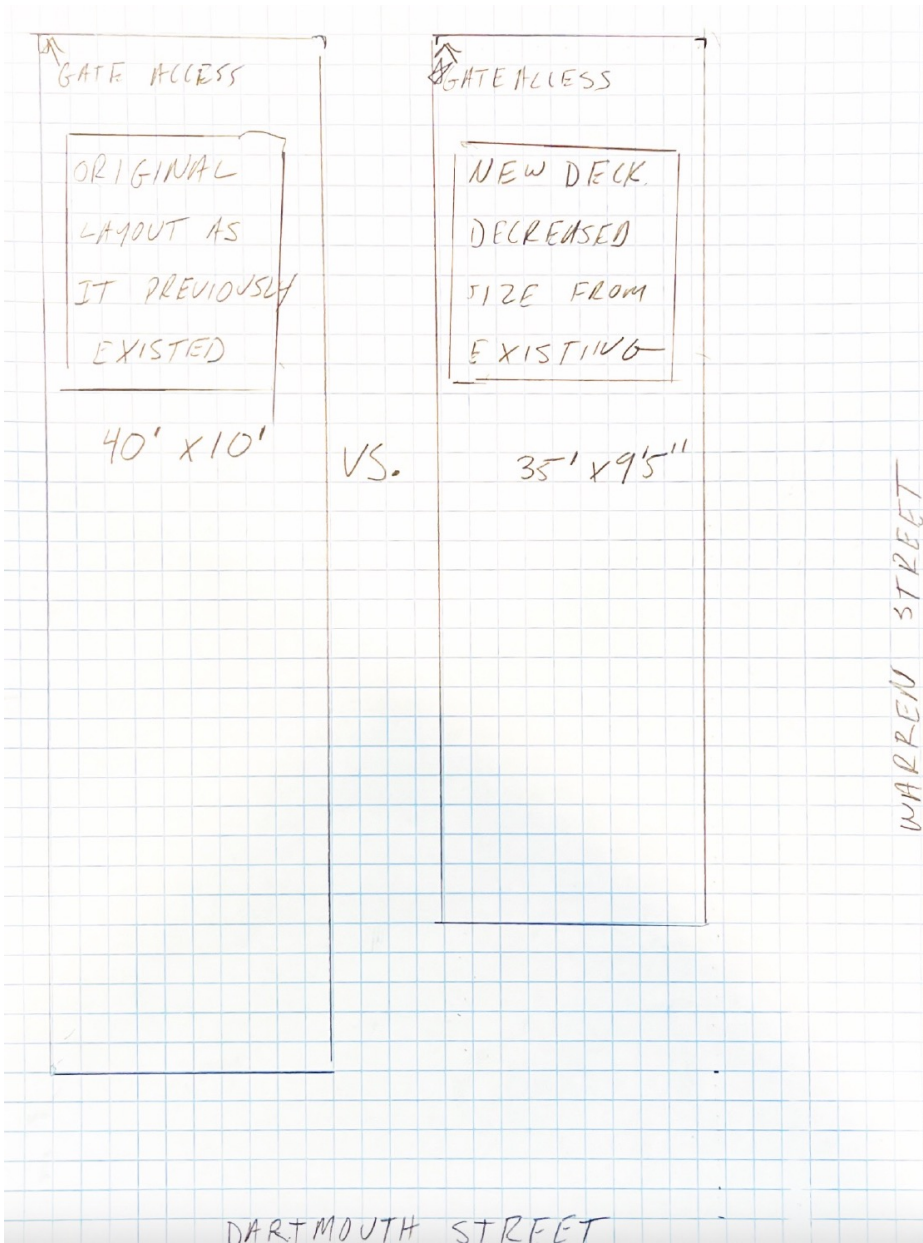

Original Deck footprint & Proposed Deck footprint



The original deck was just visible from
opposite corner - the Warren Ave sidewalk



Proposed Deck is now not visible approximately 50 feet
back down Warren Ave

- This photo shows the visibility from approximately 50 feet back from the corner of Warren and Dartmouth St's
- We worked with staff and created a mock railing using yellow tape at the proposed deck size and railing height to ensure it reduced the visibility from a public way
- We've reduced our visibility so that it is less than the neighbors



- This photo shows the visibility the opposite corner of Dartmouth and Warren from eye level of the proposed deck
- We worked with staff and created a mock railing using yellow tape at the proposed deck size and railing height to ensure it reduced the visibility from a public way



Example of visibility from corner of Dartmouth and Montgomery St (next block down)



Example of visibility from corner of Dartmouth and Montgomery St (next block down)

In Summary:

- We are requesting approval for the proposed new deck footprint to reduce visibility, or if this project can be remanded to staff we will work with them to get it to a point of minimal visibility