

Harborwalk at
5 Necco Street, Boston, MA 02210

Chapter 91 Historic Marker

Harborwalk at 5 Necco Street,
Boston, MA 02210
Historic Marker
07/11/2022

Proposed
historic marker
location.

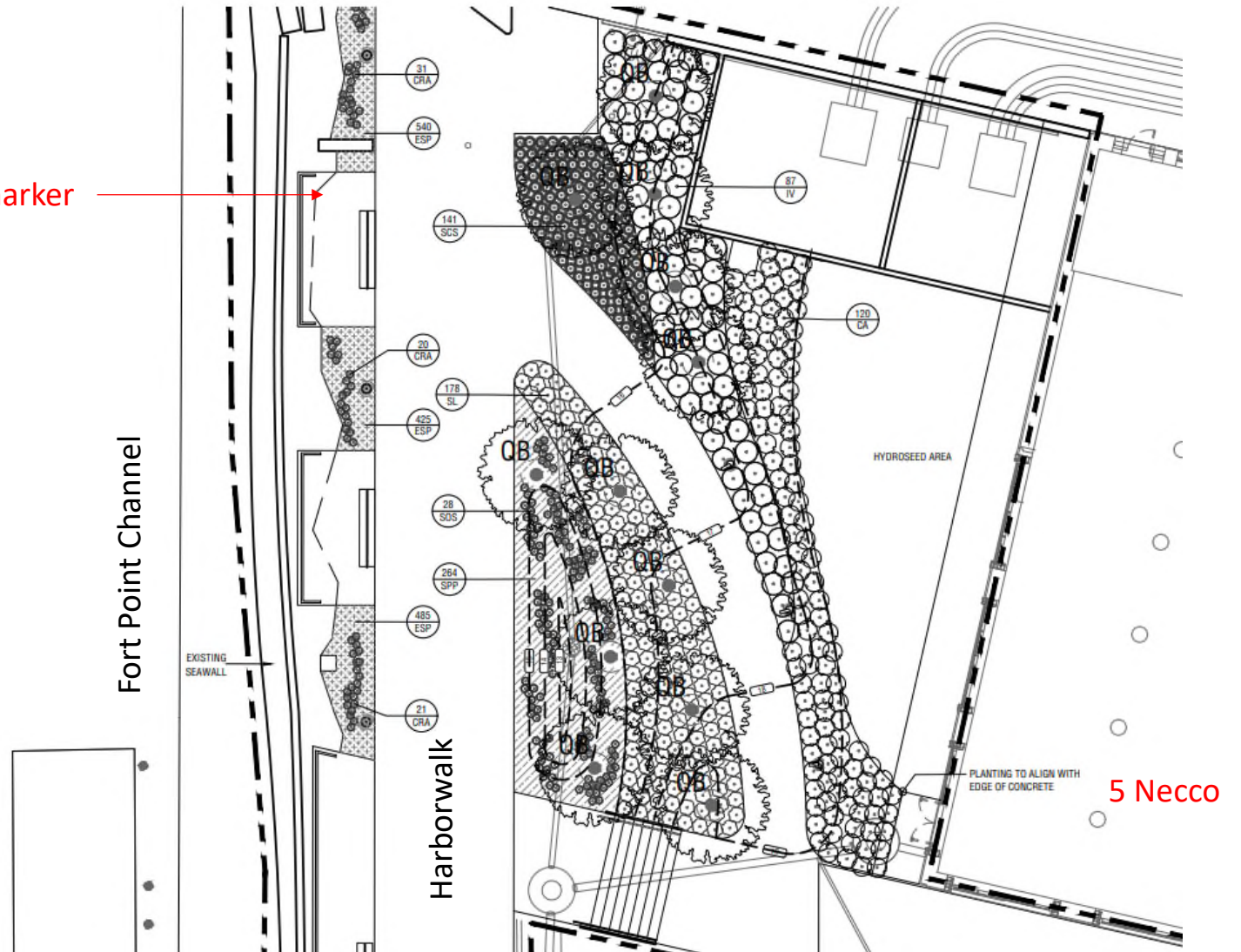

Harborwalk at 5 Necco Street,
Boston, MA 02210
Historic Marker
07/11/2022

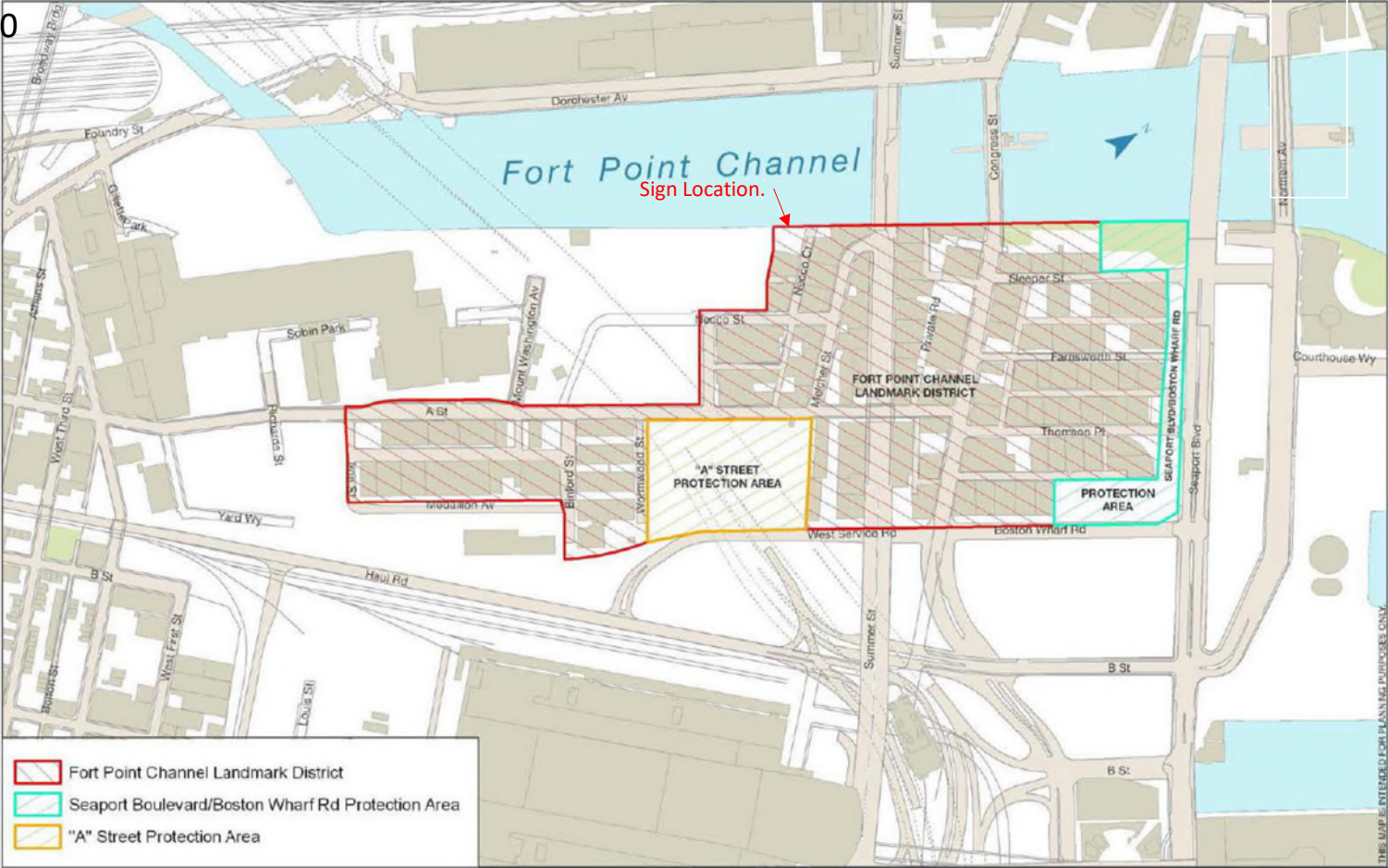

Fort Point Channel
Landmark District Boundary Map



Fort Point



05
9/20/2021
www.harborwalk.com
© 2021
Boston

A CHANGING CHANNEL

Originally a natural deep water channel, Fort Point Channel was defined in the 19th century by land created on both sides. It was a thriving industrial waterway for years before it declined in the 20th century.

Industries flocked to the newly made land. Iron foundries, sugar refineries, and machine shops clustered on this side of the channel. The leather industry settled on the other. The channel teemed with boats bringing raw materials, such as lumber, bricks, and cement, to growing industrial and residential areas. Sugar and molasses were delivered to one-story warehouses located here and nearby. Coal was distributed widely by boat and train to fuel steam engines running factory machinery and later electrical plants.

Drawbridges across the channel improved access to South Boston industries but slowed boat traffic. New rail lines and piers like Fan Pier along the harbor reduced the channel's use, as did filling South Bay. In the 1950s, when the bridges were fixed in place, shipping on the channel ended. Today, new development along this historic waterway is spurring its revitalization as a recreational and cultural destination.

TOP Traffic came to a halt as sugar boat SS Evelyn was towed through the Congress Street Bridge in 1929. Soon a bascule bridge that pivoted up replaced the swing-span bridge. The new bridge eliminated the center drum, allowing a 75-foot opening. - Courtesy of the Boston Public Library, Leslie Jones Collection

Fashionable Bostonians enjoyed strolling on the South Boston Bridge in the 1820s before heavy industry prevailed. The bridge stood between what was known as South Bay to the south and the Fort Point Channel to the north. It is now West 4th Street where the channel ends in a culvert below. - Courtesy of the Boston Athenaeum

BOTTOM IMAGES LEFT TO RIGHT This 1775 Boston Harbor chart shows a natural deep water channel between the Boston peninsula and a broad area of mudflats. The channel was named after Fort Point (f), a point of land at the base of Fort Hill. - Courtesy of the Norman B. Leventhal Map & Education Center, Boston Public Library

Boats and trains delivered iron ore and coal to industries like Cyrus Alger's South Boston Iron Works. The coal fueled furnaces that melted the iron. - Courtesy of Historic New England.

In 1903, many vessels still used the channel. They navigated through its bridges, some all the way to South Bay at upper right. - Courtesy of the Library of Congress



Harborwalk at 5 Necco Street,
 Boston, MA 02210
 Historic Marker
 07/11/2022

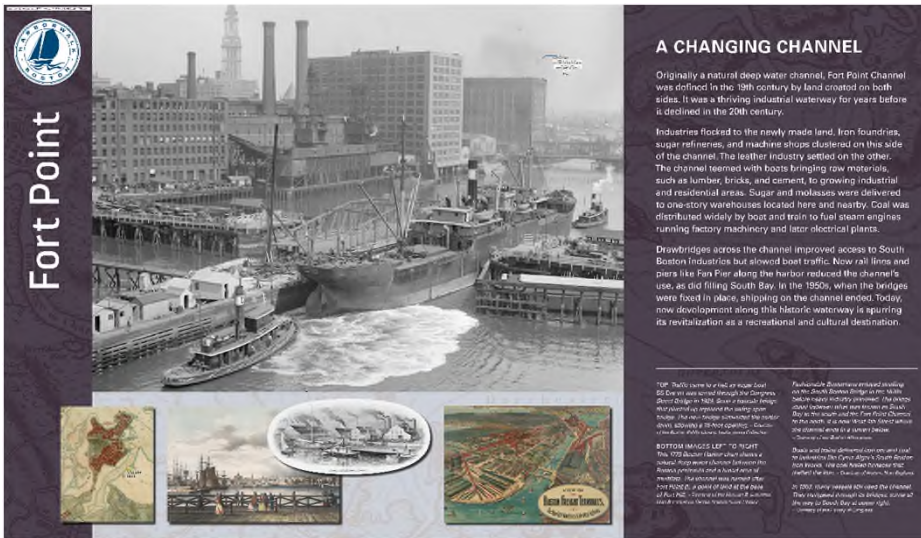

Chapter 91 Historic Marker – Graphic

Sign Dimensions:
 Graphic: 42" x 24"
 Baseplate: 6"x6"
 Mounting plate 12"x12"
 Base Height: 4'



Chapter 91 Historic Marker – Base

Harborwalk at 5 Necco Street,
 Boston, MA 02210
 Historic Marker
 07/11/2022

Sign Installation: The post will be drilled and epoxied 3" into the concrete platform base.

- ① 32 13 14 CAST IN PLACE CONCRETE PAVING; RE: PLANS AND DETAILS
- ② 03 30 55 10" DIA. CAST-IN-PLACE CONCRETE FOOTING
- ③ 05 12 00 CONTINUOUS $\frac{1}{4}$ " STEEL PLATE
- ④ 05 12 00 18" X $\frac{1}{4}$ " STEEL FASCIA
- ⑤ 05 12 00 8" X 6" X 1" STEEL BASE PLATE
- ⑥ 05 12 00 W 8 X 24
- ⑦ 03 30 55 #3 @ 12" EPOXY COATED
- ⑧ 32 14 00 MORTAR SETTING BED; 1" MAX. $\frac{1}{2}$ " MIN.
- ⑨ EDGE OF ADJACENT PAVING; REFER TO PLANS
- ⑩ 05 50 10 GUARDRAIL POST; $\frac{1}{2}$ " FILLET WELD ALL AROUND TOP OF W 8 X 24
- ⑪ 05 50 10 GUARDRAIL POST BASE PLATE
- ⑫ 32 14 00 PRECAST UNIT PAVERS; REFER TO MATERIALS SCHEDULE
- ⑬ 32 14 00 PRECAST UNIT PAVER JOINT; REFER TO MATERIALS SCHEDULE
- ⑭ 03 30 55 #5 CONT. EPOXY COATED REBAR; TYP.
- ⑮ 4-1/2" NORMAL WEIGHT 1-1/2" (6" TOTAL) COMPOSITE 16-GAUGE GALVANIZED STEEL DECK WITH #4@6" REBAR (CENTERED OVER DECK FLUTES) WITH 1 - 1/2" CLEAR COVER OVER TOP OF DECK. USE EPOXY -OCATED REBAR.
- ⑯ 05 12 00 5/8" DIA ROD BENCH DOWELS; DRILL AND EPOXY RODS INTO CONCRETE HAUNCH WITH 3" EMBEDMENT; EMBEDMENT MEASURED FROM TOP OF CIP CONCRETE

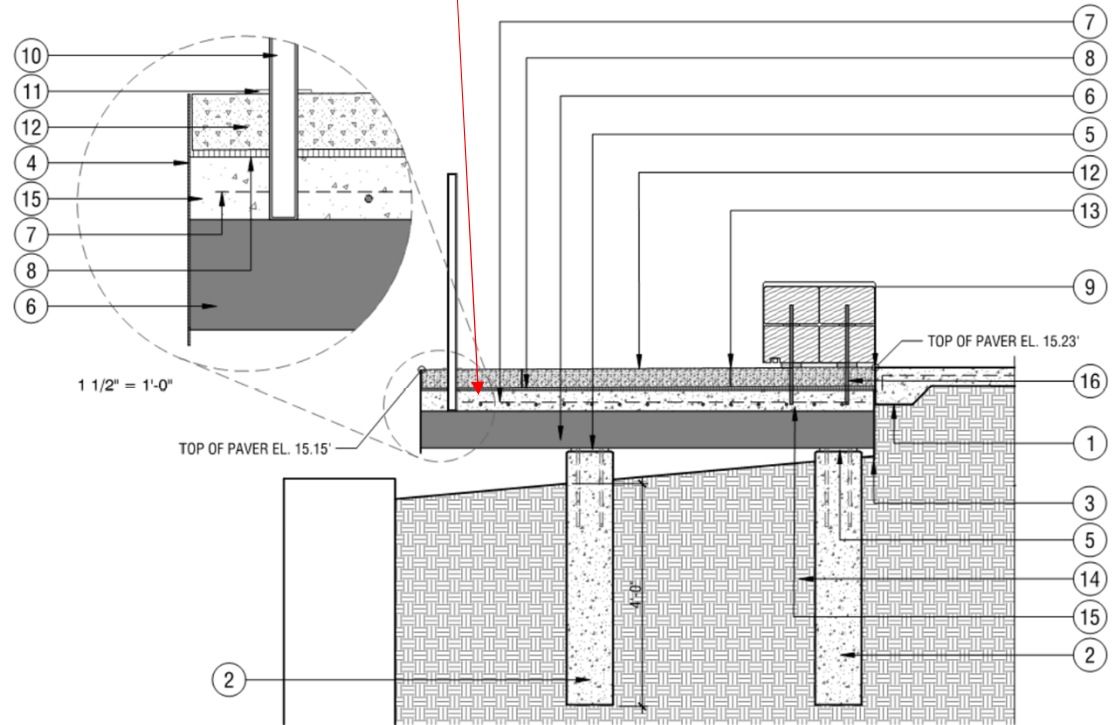

10 10 10
 SCALE: 1/2" = 1'-0"

DETAIL-UNIT PAVER OVERLOOK PAVER SECTION 02
 BP-G2.RE-117

Harborwalk at 5 Necco Street,
Boston, MA 02210
Historic Marker
07/11/2022



5 Necco Street

15 Necco Street

Existing Condition

