

Amalgamated Bank : Boston Offices @ 53 State Street

CONTEXT PHOTO - VIEW OF STATE STREET ELEVATION

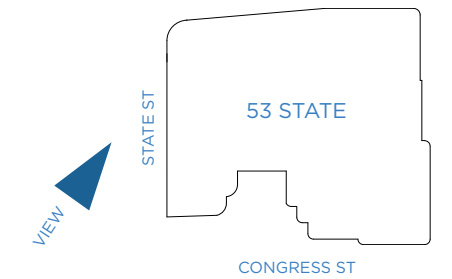

05.25.21



Amalgamated Bank : Boston Offices @ 53 State Street

EXISTING SIGNAGE AT STATE STREET ELEVATION



05.25.21

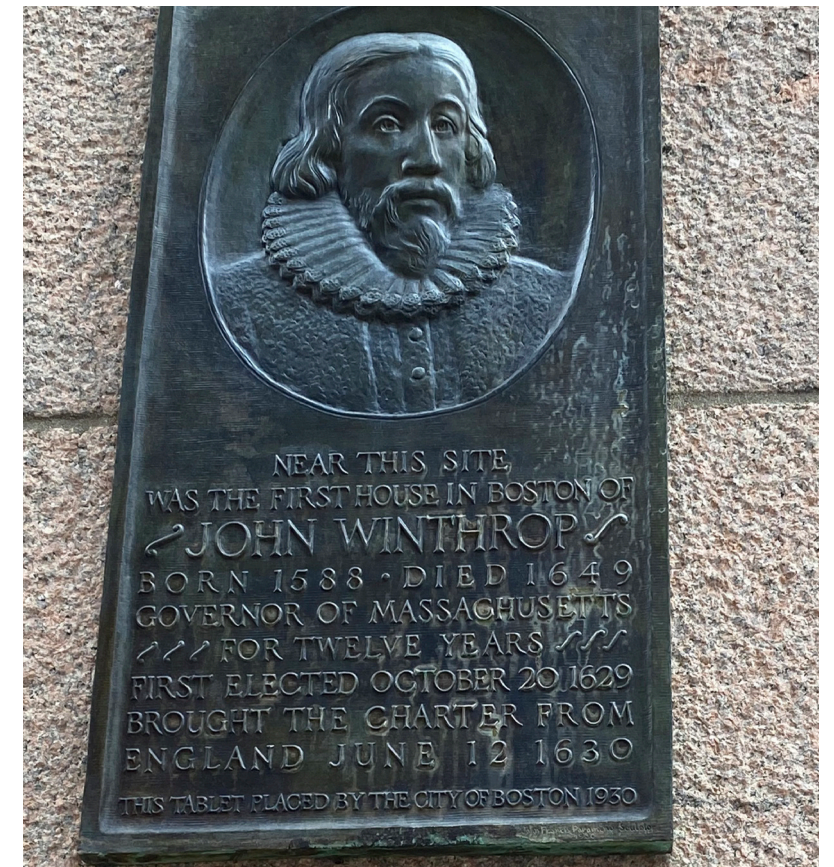

Amalgamated Bank : Boston Offices @ 53 State Street

EXISTING PLAQUES



05.25.21

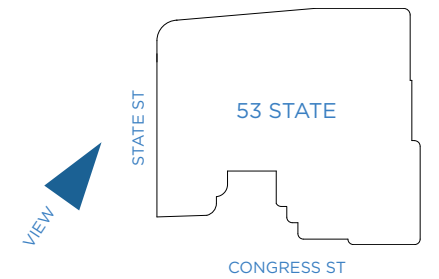

Amalgamated Bank : Boston Offices @ 53 State Street

STATE STREET ELEVATION WITH PROPOSED SIGNAGE



05.25.21

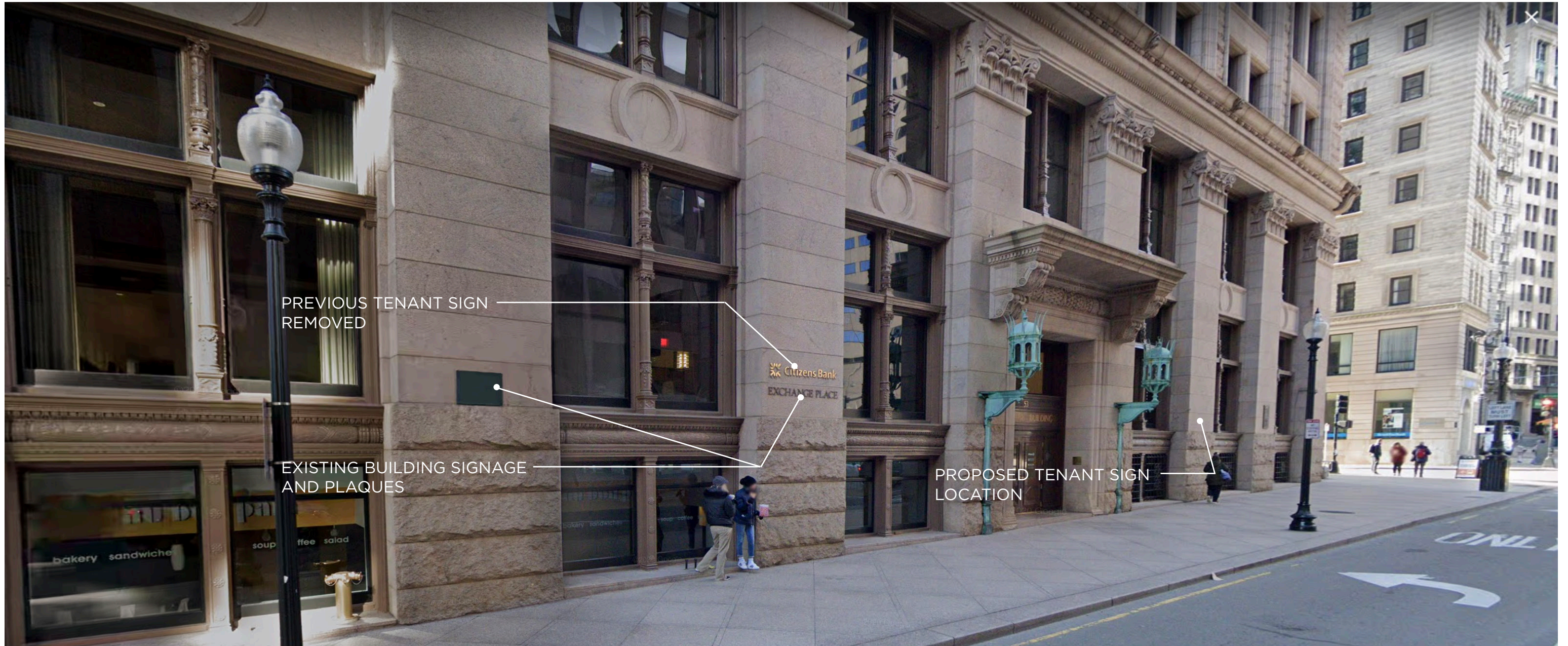

PREVIOUS TENANT SIGN
REMOVED

EXISTING BUILDING SIGNAGE
AND PLAQUES

PROPOSED TENANT SIGN
LOCATION

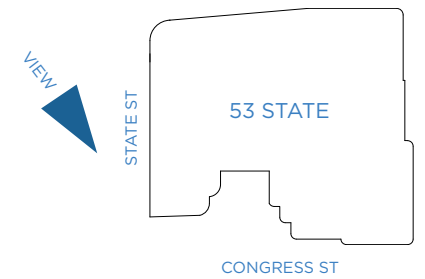

Amalgamated Bank : Boston Offices @ 53 State Street

ALTERNATE VIEW - STATE ST TOWARDS CONGRESS ST



05.25.21

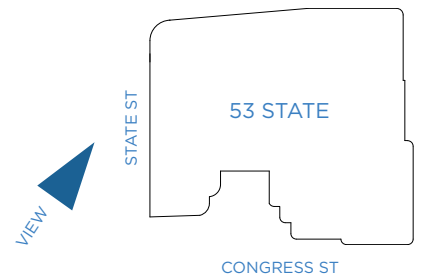

Amalgamated Bank : Boston Offices @ 53 State Street

CLOSE UP VIEW



05.25.21



EXISTING STONE COLUMN
(APPROXIMATELY 7'-6" WIDE)

PROPOSED TENANT SIGNAGE:

- OVERALL WIDTH OF SIGN TO MATCH NEARBY "EXCHANGE PLACE" SIGN (5'-4")
- FINISH TO MATCH EXISTING SIGNS AND PLAQUES ON THIS FACADE
- REFER TO SHOP DRAWING ON NEXT PAGE FOR MORE INFORMATION

Project: 0321_24 Boston Urban Places - 53 State Amalgamated Bank

Details:

- (1) 64" w x 20" h 3/8" thick stainless steel signage
- Logo and border depth = 1/8"
- 3/8" Single line border
- Dark Oxide background with Stipple texture
- (4) Rosettes

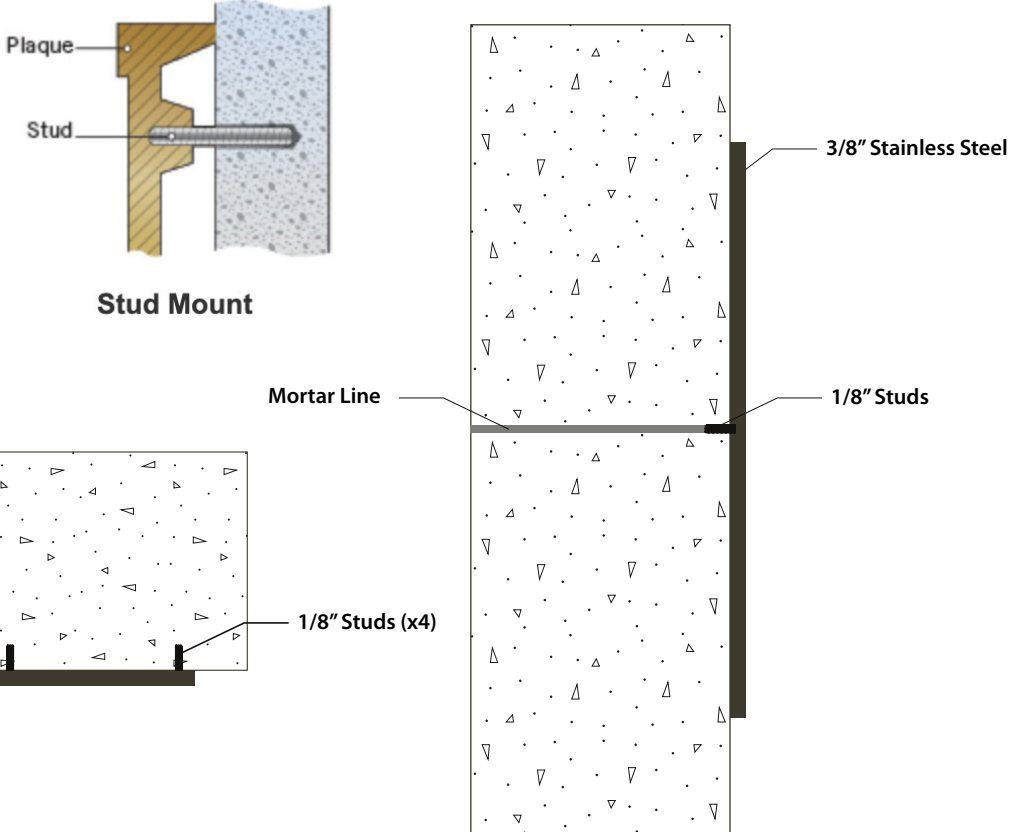
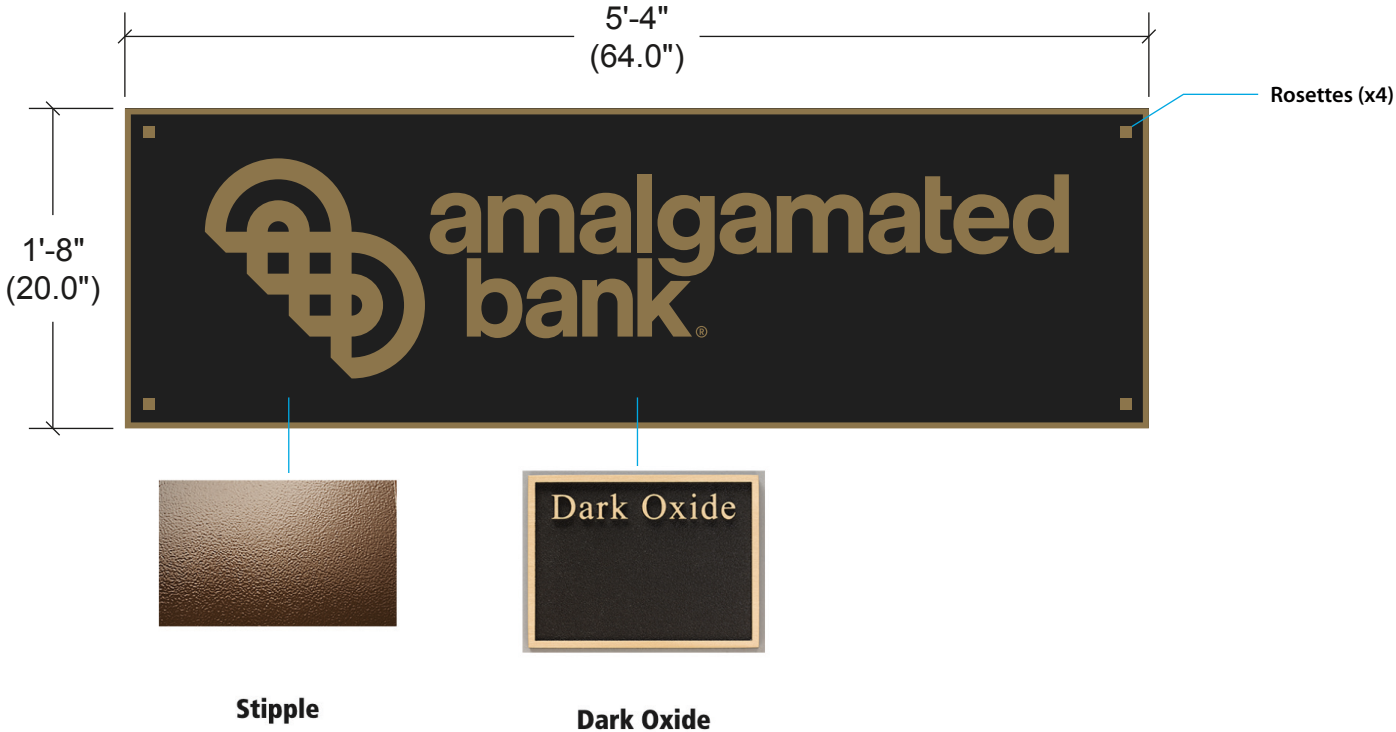

A.4 TOP-DOWN VIEW DETAIL
Scale: 1:2

Photo example of finish and color:



A.3 PERSPECTIVE VIEW
Scale: 1" = 1'0"

