

## **Details of Scope of Work for Final Phase of First Church in Roxbury Exterior Renovation** *Continued from page 1*

### ***West Entry***

#### Center Door

The center entry presently has a pair of double doors, most likely installed in 1888. They are in very poor condition and are not code compliant. The original center door, shown in historic photos of the Meeting House was a single, paneled door, flanked by columns. The width of a door replicating the original door will be code compliant. The door will be replicated with flanking columns.

#### North and South Doors

During the restoration work in the summer of 2017, the fan shutters above these doors were removed to reveal their original (1804) fanlights. When the gallery stairs were built across these doors in 1888, the doors were shortened and a wood panel inserted between the fanlight and the doors. The new doors will be full height, paneled doors that will eliminate the paneled insert and restore the original relationship of the doors and the fanlights.

### ***Brownstone Steps/Railings***

The brownstone steps appear to be original (1804) building fabric and they are in remarkably good condition. It is the intention of this scope of work to repair and disturb the existing stone as little as possible. There are several stone that will need to be re-set, notably at the center entry. All the old pointing mortar will need to be removed and replaced. There will also need to be several small dutchmen repairs to mend holes where railings were formerly anchored.

### ***Exterior Lighting***

#### Entry

The west elevation presently has a modern lighting fixture above the center entry. There were formerly two lights mounted on the pilasters that flank the center entry, but they are gone. The proposed new lamps will be placed on the pilasters and will be reproductions of historic lamps of appropriate style for the Meetinghouse. The modern fixture will be removed.

#### Gates

The gates are not lighted presently. At night, it is especially difficult to locate the entrances into the enclosed Meetinghouse property. Lighting the gates should make them more readily identifiable as points of entry and make passage through the gates safer. As described below, the restoration of the gates will involve re-building the brick piers. When the brick piers are rebuilt, they will be wired so that lamps can be mounted on their tops.

### ***Universal Access Ramp and Entry***

Although the sanctuary of the Meeting House is accessible through the Putnam Street entrance, this phase of work will provide universal access to the sanctuary through the historic west entry.

A ramp will be built along the north side of the brownstone steps and the north window in the entry hall will be modified to create a new door. The building of the ramp will be coordinated with necessary landscape modifications at the west and north sides of the Meeting House and with the designation of accessible parking.

### *Gates*

The Meetinghouse property is surrounded by an iron fence, installed in 1926. The fence has two pedestrian gates and two vehicle/pedestrian gates. The vehicle/pedestrian gates have four leaves that are hung from brick piers. The larger gates, through which the vehicles pass, have ornate ironwork.

The vehicle gates are narrow and limit access into the property by emergency vehicles. Most notably, some of the larger fire trucks cannot get through the gates. For the protection of people attending events in the Meeting House and for the protection of the historic building, the UUM is compelled to modify and restore these gates.

The proposed work will rebuild the gates using the existing ironwork, but will eliminate one of brick piers on each side of the gates. The brick piers will be disassembled and rebuilt in their new location. The ironwork will be removed and shop-treated – existing paint removed, damaged ironwork repaired, repainted and reinstalled. At the completion of the work, the gates, which currently are not operable, will open and close.

When rebuilt, the brick piers will be wired so that they will have lamps at their tops rather than cast stone finials, as was their original design. The existing cast stone finials have multiple cracks and one is missing. They are not in a condition where they can be repaired.

### *Paving*

The drives that surround the Meetinghouse are presently packed dirt and mostly surfaces that have been adopted for parking without suitable subsurface preparation. Their surfaces are uneven. They are muddy in spring and difficult to plow in winter. The poor condition of the drives precludes good maintenance of the grounds and the random parking on the property presents safety issues when events are held in the Meetinghouse.

The proposed paving will re-establish the historic drives and paths on the west elevation of the Meetinghouse. This work will include rebuilding the semi-circular drive that connects the north and south vehicle/pedestrian gates. It will re-design the parking at the west elevation (front) of the building to minimize its impact on the view of the historic Meetinghouse. It will also create additional parking on the north side of the building.

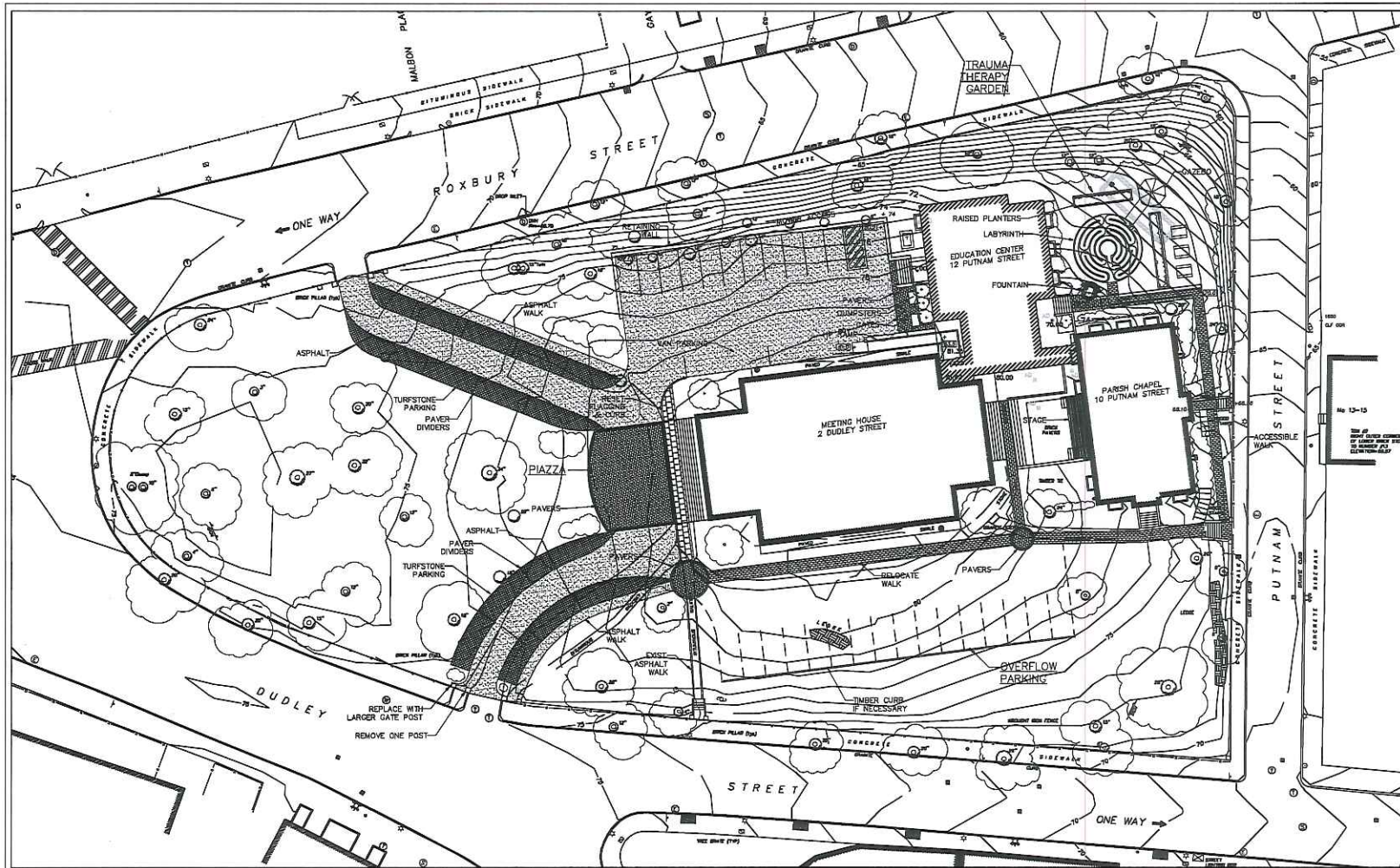

WEINMAYRJAY ASSOC. INC.  
NOVEMBER 16, 2018

FIRST CHURCH ROXBURY  
UNITARIAN UNIVERSALIST URBAN MINISTRIES

COMMUNITY OUTREACH GROUP  
FOR LANDSCAPE DESIGN

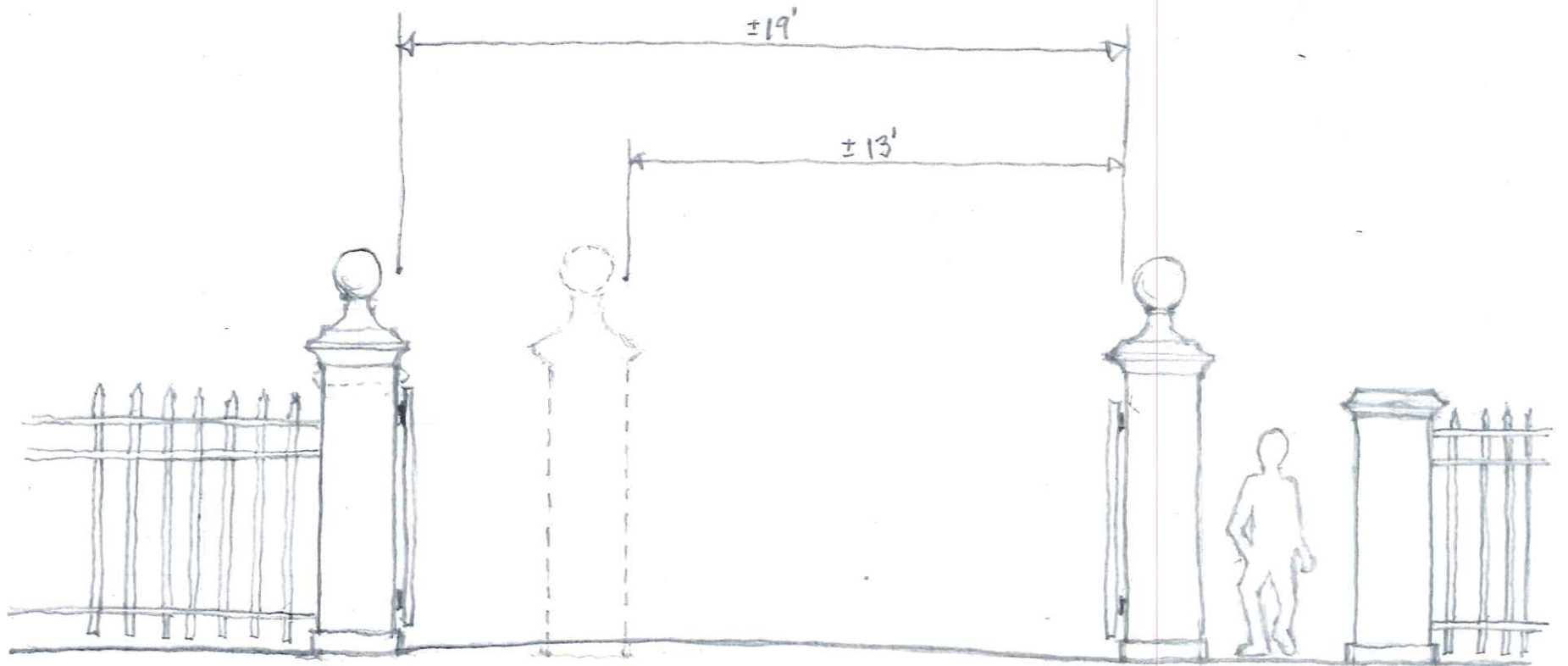

REPLACE  
EXIST. POST

EXIST. POST

DUDLEY ST. GATE  
1<sup>ST</sup> CHURCH ROXBURY

WEINMAYR/JAY ASSOC. INC.  
 $\frac{1}{4}'' = 1'$  11/20/18



CONTEMPORARY PROFESSIONAL URBAN MINISTRY  
OF THE FIRST CHURCH IN HORDLEY

Proclamation 1015  
First Church in Hordley  
The First Church in Hordley is a historic church building that has been restored and is now a modern office building. It is a landmark building in the community and is a source of pride for the people of Hordley. The building is a fine example of the architecture of the early 20th century and is a testament to the skill and craftsmanship of the builders of that time. The building is a beautiful example of the architecture of the early 20th century and is a testament to the skill and craftsmanship of the builders of that time.

Private  
Parking  
for Urban Ministry  
and Guests





First Church  
in Roxbury  
Gathered 1631