

# MASSACHUSETTS PORT AUTHORITY

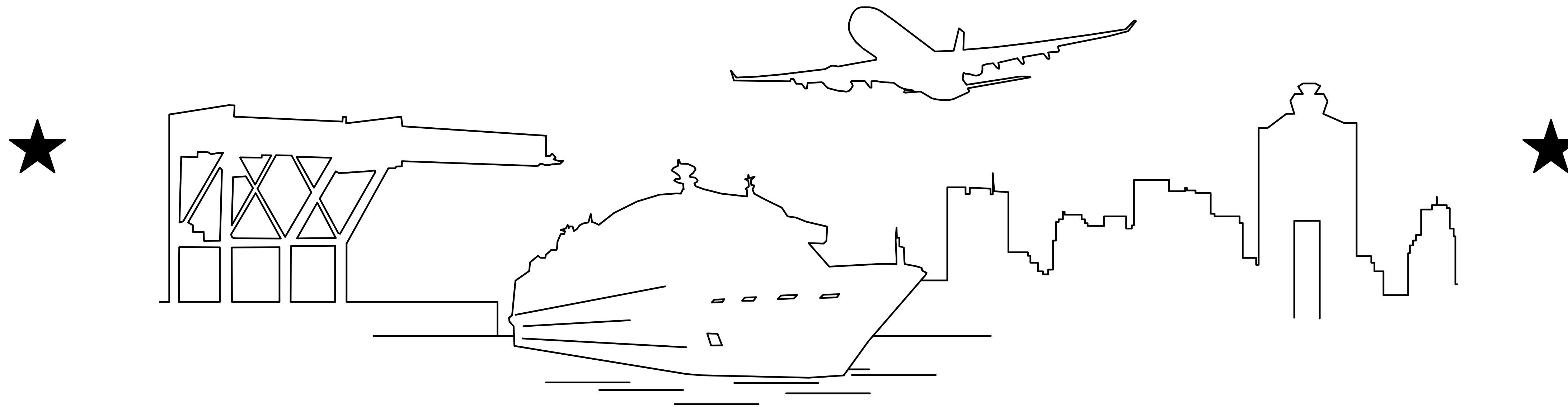

## REHABILITATE A PORTION OF TAXIWAY C AND CONSTRUCT NEW STUB TAXIWAY LOGAN INTERNATIONAL AIRPORT EAST BOSTON, MASSACHUSETTS MPA PROJECT No. L1303-C1 AIP#: 3-25-0010-XX NOI PLANS - 3/07/2018



MASSACHUSETTS PORT AUTHORITY  
APPROVAL  
CAPITAL PROGRAMS DEPARTMENT  
ONE HARBORSIDE DRIVE, SUITE 209S  
EAST BOSTON, MASSACHUSETTS 02128



WSP USA  
75 ARLINGTON STREET  
BOSTON, MA 02116



STAMPS

\_\_\_\_\_  
DIRECTOR OF CAPITAL PROGRAMS  
AND ENVIRONMENTAL AFFAIRS

\_\_\_\_\_  
DATE

### LIST OF DRAWINGS:

SHEET NUMBER:	1	OF	8	-	T001	-	TITLE SHEET
	2	OF	8	-	G001	-	GENERAL PLAN AND NOTES
	3	OF	8	-	C201	-	GRADING PLAN - 1
	4	OF	8	-	C202	-	GRADING PLAN - 2
	5	OF	8	-	C203	-	GRADING PLAN - 3
	6	OF	8	-	C801	-	EROSION AND SEDIMENT CONTROL PLAN - 1
	7	OF	8	-	C802	-	EROSION AND SEDIMENT CONTROL PLAN - 2
	8	OF	8	-	C803	-	EROSION AND SEDIMENT CONTROL DETAILS

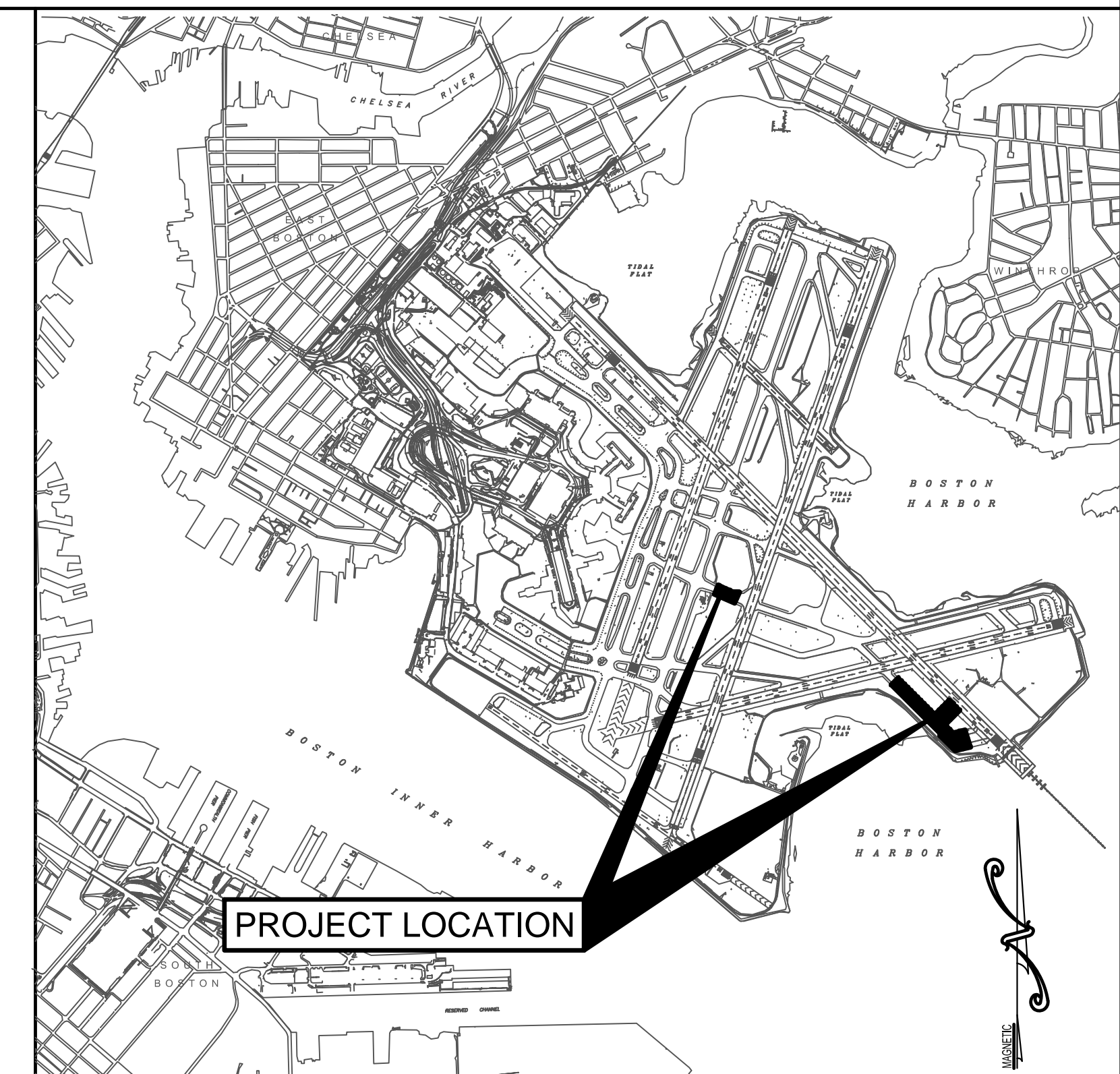



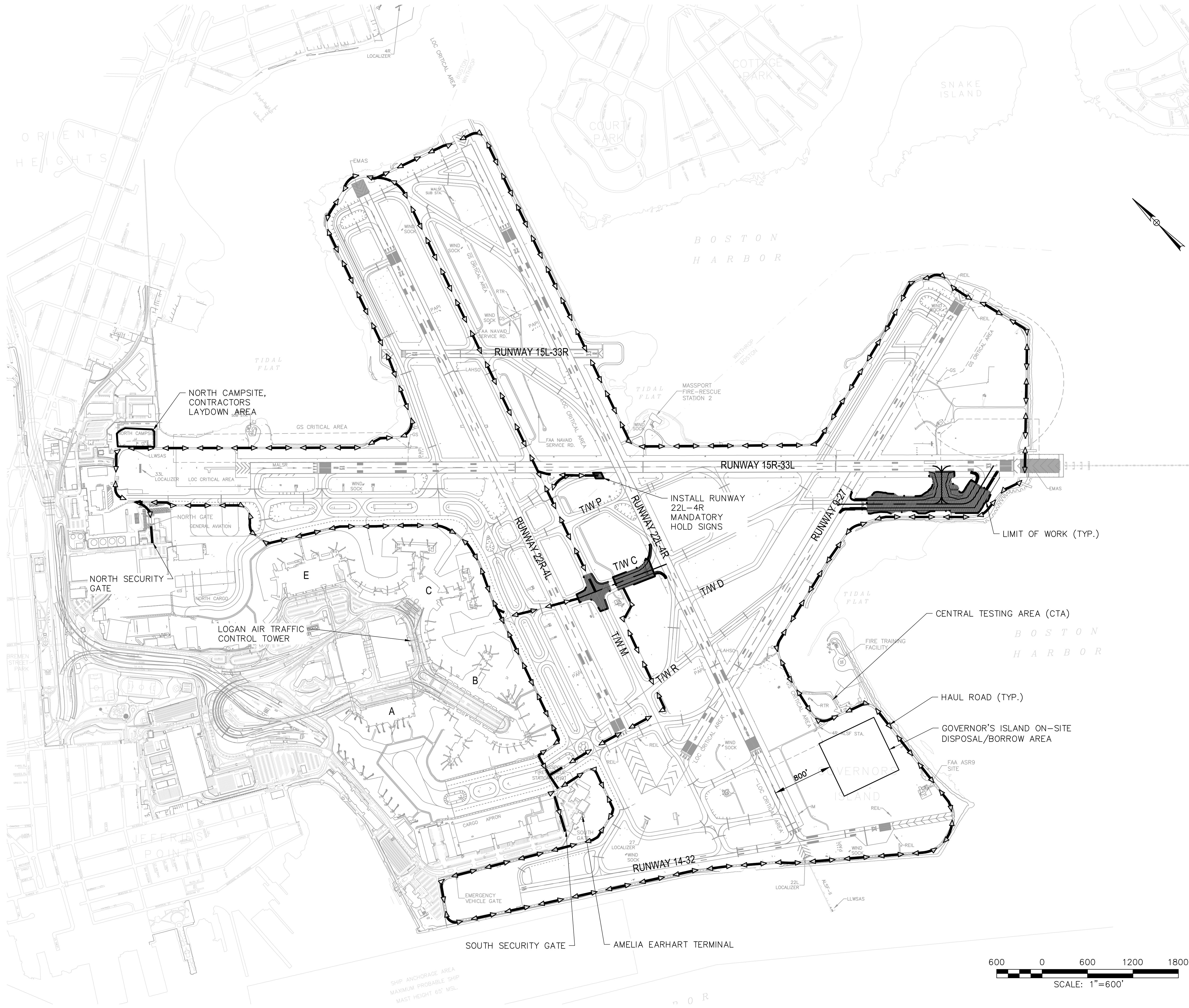

**GENERAL NOTES**

**SUMMARY OF WORK LIMITS:**

1. WORK INCLUDES REHABILITATION OF TAXIWAY CHARLIE FROM THE RUNWAY 33L HOLD BAR TO RUNWAY 9-27 AND BETWEEN TAXIWAY M AND RUNWAY 4R-22L. WORK ALSO INCLUDES THE CONSTRUCTION OF A NEW STUB TAXIWAY BETWEEN TAXIWAY C AND RUNWAY 33L.
2. STORMWATER POLLUTION PREVENTION AND EROSION CONTROLS MUST BE INSTALLED IN ALL AREAS WITHIN THE LIMIT OF WORK, STAGING AREA AND CAMPSITE AND AS DIRECTED BY THE ENGINEER.
3. CONTRACTOR IS ADVISED THAT MPA CONTRACT L1301-C1 WILL BE CONSTRUCTED CONCURRENTLY AND ADJACENT TO THIS CONTRACT. REFER TO SPECIFICATION DIVISION I, ARTICLE 33 REGARDING COOPERATION BETWEEN CONTRACTS. COORDINATION BETWEEN CONTRACTORS AND MPA OPERATIONS FOR SCHEDULING, CONSTRUCTION PHASING, AND CONSTRUCTION ACCESS SHALL BE DONE THROUGH THE ENGINEER.
4. MARKINGS PLACED ON THE GROUND SHALL BE SURVEYED AND REPRESENTED IN AN AUTOCAD DRAWING PREPARED IN MASSPORT'S LAYERING AND SYMBOLOLOGY STANDARDS AND SUBMITTED TO MASSPORT DURING CONSTRUCTION. ALL EXPOSED UTILITIES SHALL LIKEWISE BE RECORDED AND SUBMITTED.
5. NO TRENCH SHALL BE BACKFILLED UNTIL ALL EXPOSED UTILITIES ARE RECORDED BY ELECTRONIC SURVEY INSTRUMENTATION.
6. REFER TO DRAWING G005 FOR ADDITIONAL NOTES PERTAINING TO CONSTRUCTION SAFETY AND PHASING.
7. SOUTH PERIMETER ROAD WILL BE RESTRICTED FROM AMELIA EARHART TERMINAL TO GOVERNOR'S ISLAND WHEN RUNWAY 14-32 IS OPEN. ALL VEHICLES MUST ACCESS NORTH PERIMETER ROAD

**LEGEND**

T/W = TAXIWAY



MASSACHUSETTS PORT AUTHORITY  
EAST BOSTON, MASSACHUSETTS 02128

PROJECT LOCATION:  
**LOGAN INTERNATIONAL AIRPORT  
EAST BOSTON, MASSACHUSETTS**

MPA CONTRACT NO.: **L1303-C01** LOCATION CODE: **2640**

PROJECT SUBMISSION PHASE:  
**NOI PLANS**

REGISTRATION STAMP:

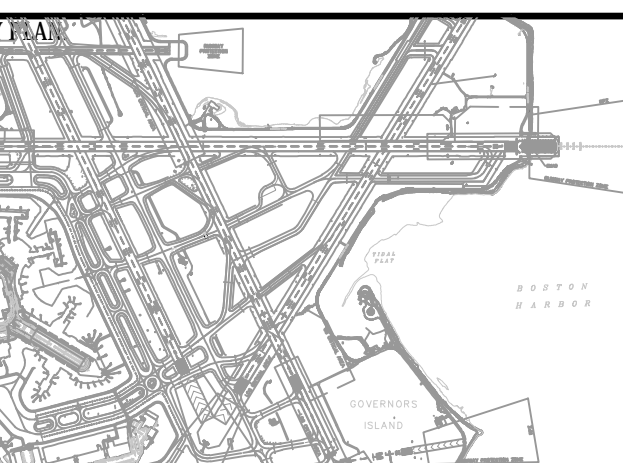

REVISIONS:

REV NO.	DATE	DESCRIPTION	BY:

PRIMARY:



WSP USA  
75 ARLINGTON STREET  
BOSTON, MA 02116

CONSULTANT:

PROJECT NUMBER AND TITLE:

**L1303-C1**  
REHABILITATE A PORTION OF T/W C  
AND CONSTRUCT NEW STUB  
TAXIWAY

SHEET TITLE:

**GENERAL PLAN AND NOTES**

DISCIPLINE:  
**CIVIL**

DRAWN BY: <b>HJH</b>	CHECKED BY: <b>CBC</b>	APPROVED BY: <b>VSM</b>
-------------------------	---------------------------	----------------------------

SCALE: <b>AS NOTED</b>	DATE: <b>3/07/18</b>
---------------------------	-------------------------

DRAWING NUMBER: SHEET NO: 2 OF 8

**G001**

T:\19665\W02-L1303-C1 Rehab a Portion of Taxiway C\1303-C1 Rehab a Portion of Taxiway C\1303-C1 Design\DWG\NOI Plans\L1303-C1.dwg, 3/2/2018 12:10:00 PM



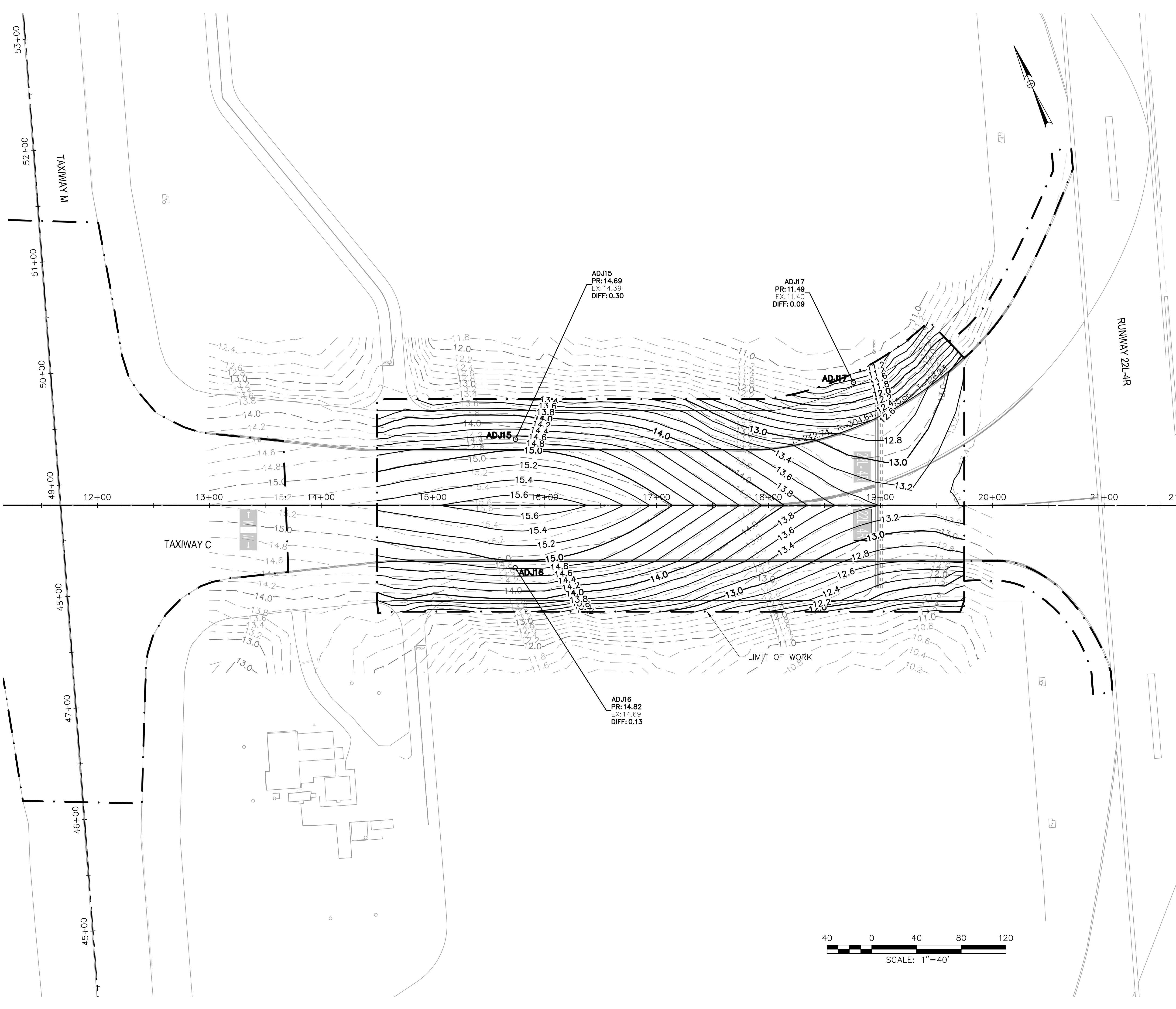

**GENERAL NOTES**

- COORDINATES SHOWN HEREON REFER TO THE NORTH AMERICAN DATUM OF 1988.
- ELEVATIONS SHOWN HEREON REFER TO THE VERTICAL DATUM OF 1988.
- EXISTING CONTOURS ARE CONSIDERED APPROXIMATE
- FOR EXISTING CONDITIONS PLAN REFER TO V101 TO V103.
- FOR PROFILE PLANS REFER TO C111 AND C112.
- FOR SPOT GRADE PLANS REFER TO C301 TO C303.
- FOR MILLING AND PAVING PLANS REFER TO C401 TO C402.
- FOR TYPICAL SECTION PLAN REFER TO C403.
- FOR MARKING PLANS AND MARKING DETAILS REFER TO C701 TO MC703 AND C704 TO C706.
- FOR EROSION CONTROL AND SEDIMENTATION PLANS AND DETAILS, REFER TO SHEETS C801, C802 AND C803.
- FOR DRAINAGE PLAN AND DETAILS, REFER TO SHEETS C501, C502 AND C503.

LEGEND	
PR. LIMIT OF WORK	———·———
PR. MAJOR CONTOUR	———17.0———
PR. MINOR CONTOUR	———16.8———
EX. MAJOR CONTOUR	———17.0———
EX. MINOR CONTOUR	———16.8———
PR. ALIGNMENT	⊕ 907+00
PR. STRUCTURE ADJUSTMENT	● ADJ-XX
PR. UNDERDRAIN STRUCTURE	● ECO/LCO



PROJECT LOCATION:  
**LOGAN INTERNATIONAL AIRPORT  
EAST BOSTON, MASSACHUSETTS**

MPA CONTRACT NO.: **L1303-C01** LOCATION CODE: **2640**

PROJECT SUBMISSION PHASE:  
**NOI PLANS**

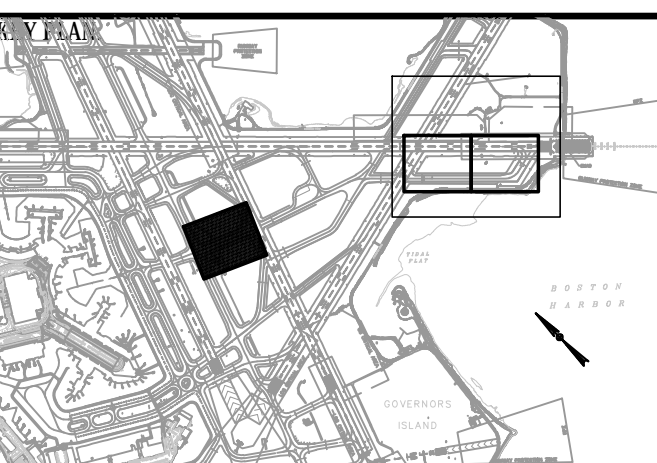
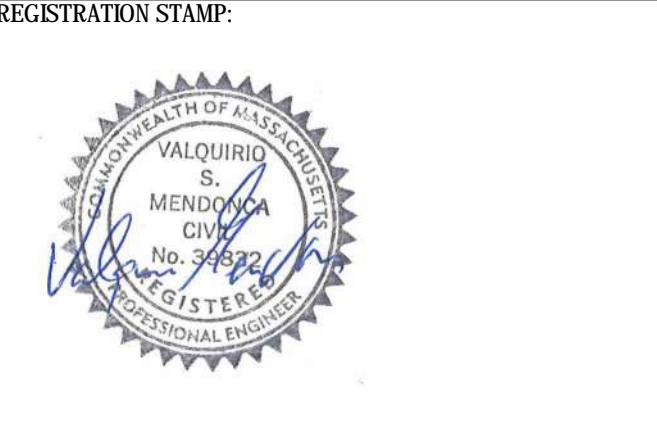

REVISIONS:

REV NO.	DATE	DESCRIPTION	BY

PRIMARY:

WSP USA  
75 ARLINGTON STREET  
BOSTON, MA 02116

CONSULTANT:

PROJECT NUMBER AND TITLE:  
**L1303-C1  
REHABILITATE A PORTION OF T/W C  
AND CONSTRUCT NEW STUB  
TAXIWAY**

SHEET TITLE:  
**GRADING PLAN - 1**

DISCIPLINE:  
**CIVIL**

DRAWN BY:	CHECKED BY:	APPROVED BY:
HJH	CBC	VSM

SCALE:	DATE:
AS NOTED	3/07/18

DRAWING NUMBER: **C201** SHEET NO: 3 OF 8

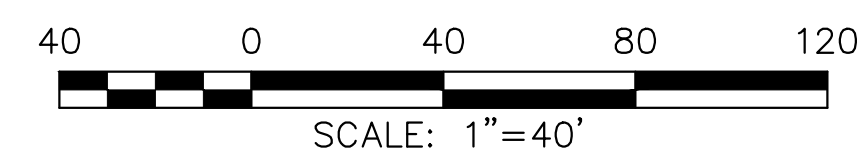

T:\18665\W02-L1303-C1 Rehab a Portion of Taxiway C\1303-C1\_Plans\L1303-C1\_C201.dwg, 3/2/2018, 2:08:14 PM

MPA - 3/2/2018 2:06:03 PM - T:\18665\W02-L1303-C1 Rehab a Portion of Taxiway C\1303-C1\_Plans\L1303-C1\_C201.dwg



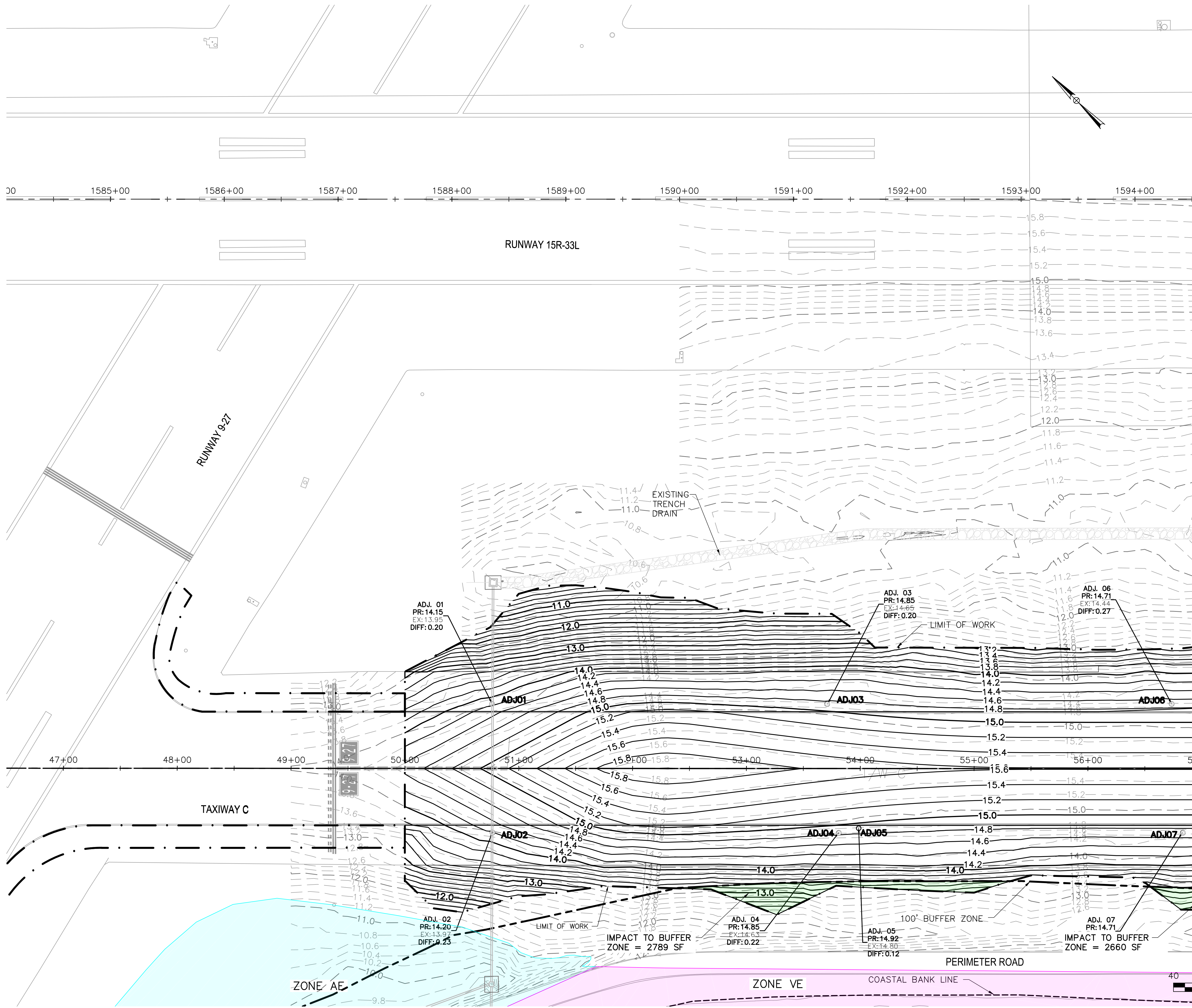

- GENERAL NOTES**
- COORDINATES SHOWN HEREON REFER TO THE NORTH AMERICAN DATUM OF 1988.
  - ELEVATIONS SHOWN HEREON REFER TO THE VERTICAL DATUM OF 1988.
  - EXISTING CONTOURS ARE CONSIDERED APPROXIMATE FOR EXISTING CONDITIONS PLAN REFER TO V101 TO V103.
  - FOR PROFILE PLANS REFER TO C111 AND C112.
  - FOR SPOT GRADE PLANS REFER TO C301 TO C303.
  - FOR MILLING AND PAVING PLANS REFER TO C401 TO C402.
  - FOR TYPICAL SECTION PLAN REFER TO C403.
  - FOR MARKING PLANS AND MARKING DETAILS REFER TO C701 TO MC703 AND C704 TO C706.
  - FOR EROSION CONTROL AND SEDIMENTATION PLANS AND DETAILS, REFER TO SHEETS C801, C802 AND C803.
  - FOR DRAINAGE PLAN AND DETAILS, REFER TO SHEETS C501, C502 AND C503.
  - TOTAL PROJECT IMPACT TO BUFFER ZONE = 9,161 SF.

**LEGEND**

PR. LIMIT OF WORK	— · —
PR. MAJOR CONTOUR	— 17.0 —
PR. MINOR CONTOUR	— 16.8 —
EX. MAJOR CONTOUR	— 17.0 —
EX. MINOR CONTOUR	— 16.8 —
PR. ALIGNMENT	— 907+00 —
PR. STRUCTURE ADJUSTMENT	· ADJ-XX
PR. UNDERDRAIN STRUCTURE	· ECO/LCO

(FOR CONTINUATION SEE DRAWING C203)



MASSACHUSETTS PORT AUTHORITY  
EAST BOSTON, MASSACHUSETTS 02128

PROJECT LOCATION:  
**LOGAN INTERNATIONAL AIRPORT  
EAST BOSTON, MASSACHUSETTS**

MPA CONTRACT NO.: **L1303-C01** LOCATION CODE: **2640**

PROJECT SUBMISSION PHASE:  
**NOI PLANS**

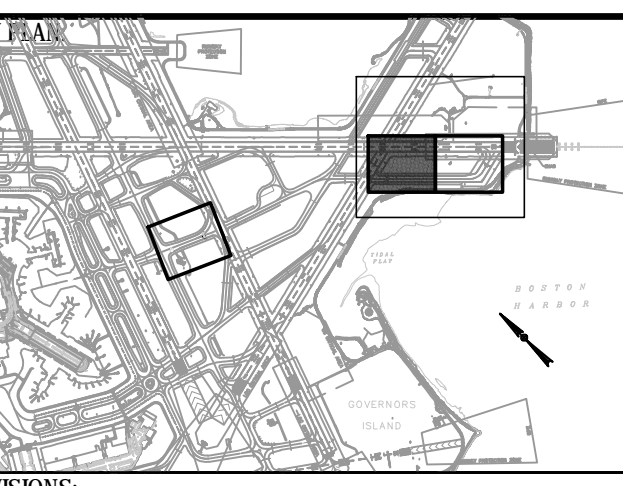
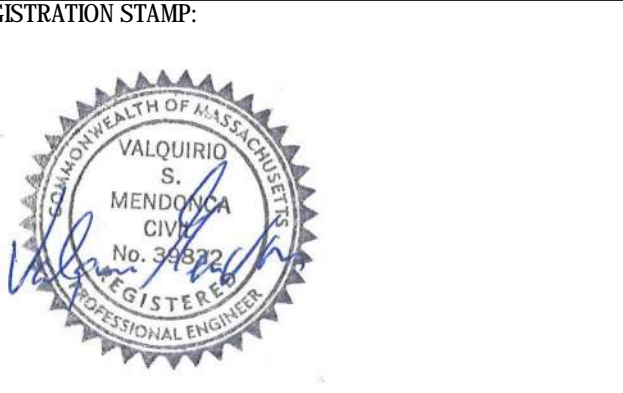

REVISIONS:

REV NO.	DATE	DESCRIPTION	BY

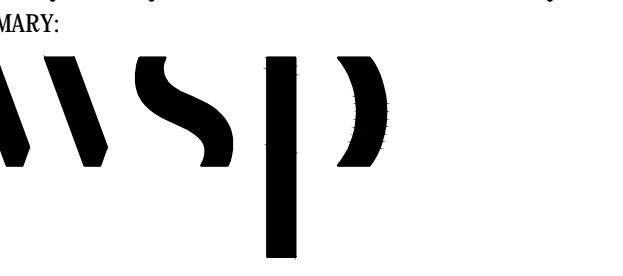

WSP USA  
75 ARLINGTON STREET  
BOSTON, MA 02116

CONSULTANT:

PROJECT NUMBER AND TITLE:

**L1303-C1**  
REHABILITATE A PORTION OF T/W C  
AND CONSTRUCT NEW STUB  
TAXIWAY

SHEET TITLE:

GRADING PLAN - 2

DISCIPLINE:  
CIVIL

DRAWN BY: **HJH** CHECKED BY: **CBC** APPROVED BY: **VSM**

SCALE: **AS NOTED** DATE: **3/07/18**

DRAWING NUMBER: **C202** SHEET NO: 4 OF 8

T:\159625\W02-L1303-C1\RehabA Portion of Taxiway C\1303-C01\_Design\DWG\NOI Plans\L1303-C01\_C202.dwg, 3/2/2018 2:41:54 PM  
MPA - 3/2/2018 2:22:37 PM - T:\159625\W02-L1303-C1\RehabA Portion of Taxiway C\1303-C01\_Design\DWG\NOI Plans\L1303-C01\_C202.dwg



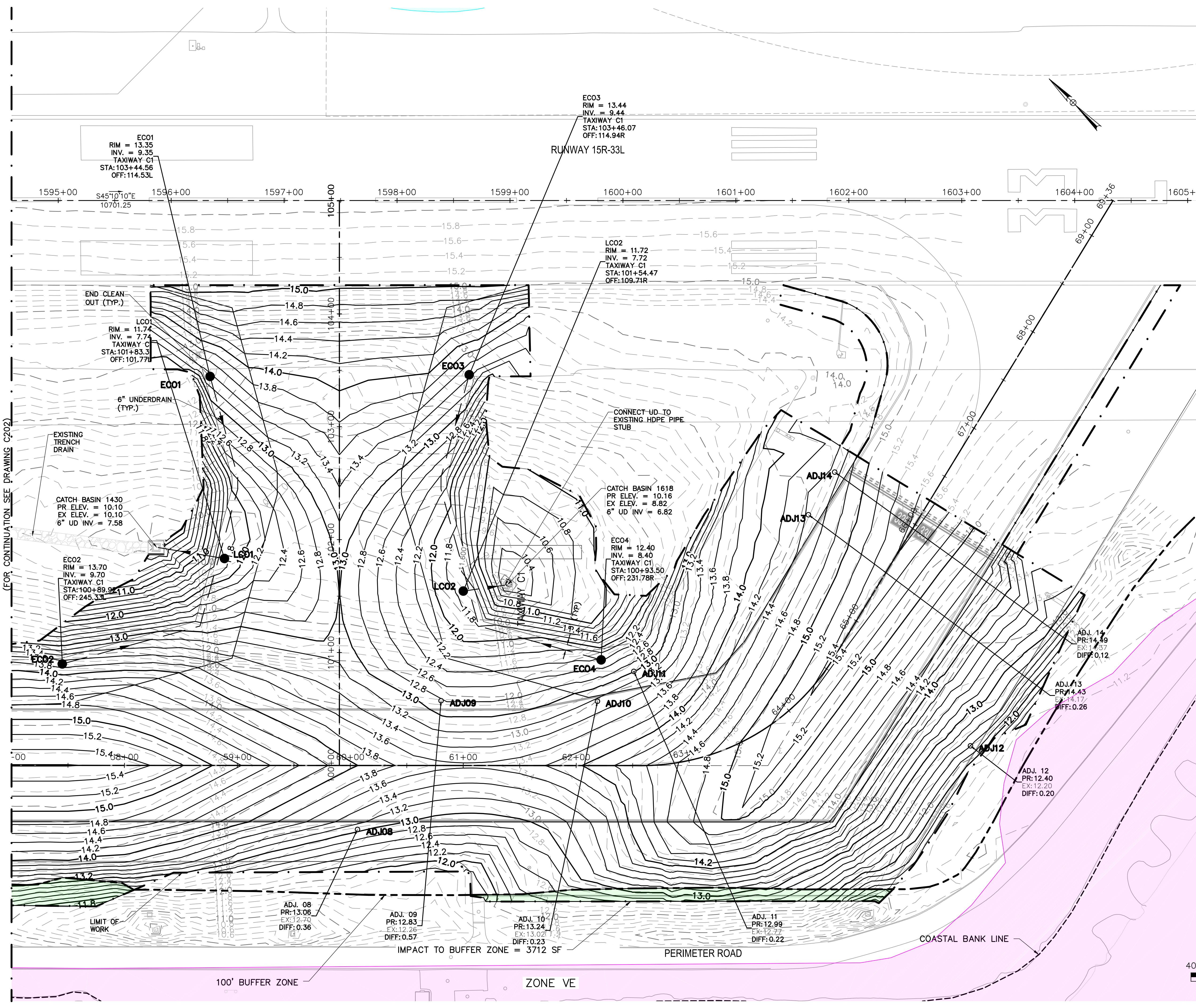

**GENERAL NOTES**

- COORDINATES SHOWN HEREON REFER TO THE NORTH AMERICAN DATUM OF 1988.
- ELEVATIONS SHOWN HEREON REFER TO THE VERTICAL DATUM OF 1988.
- EXISTING CONTOURS ARE CONSIDERED APPROXIMATE
- FOR EXISTING CONDITIONS PLAN REFER TO V101 TO V103.
- FOR PROFILE PLANS REFER TO C111 AND C112.
- FOR SPOT GRADE PLANS REFER TO C301 TO C303.
- FOR MILLING AND PAVING PLANS REFER TO C401 TO C402.
- FOR TYPICAL SECTION PLAN REFER TO C403.
- FOR MARKING PLANS AND MARKING DETAILS REFER TO C701 TO MC703 AND C704 TO C706.
- FOR EROSION CONTROL AND SEDIMENTATION PLANS AND DETAILS, REFER TO SHEETS C801, C802 AND C803.
- FOR DRAINAGE PLAN AND DETAILS, REFER TO SHEETS C501, C502 AND C503.
- TOTAL PROJECT IMPACT TO BUFFER ZONE = 9,161 SF.

**LEGEND**

PR. LIMIT OF WORK	— · —
PR. MAJOR CONTOUR	— 17.0 —
PR. MINOR CONTOUR	— 16.8 —
EX. MAJOR CONTOUR	— 17.0 —
EX. MINOR CONTOUR	— 16.8 —
PR. ALIGNMENT	⊕ — 907+00 —
PR. STRUCTURE ADJUSTMENT	• ADJ-XX
PR. UNDERDRAIN STRUCTURE	• ECO/LCO



MASSACHUSETTS PORT AUTHORITY  
EAST BOSTON, MASSACHUSETTS 02128

PROJECT LOCATION:  
**LOGAN INTERNATIONAL AIRPORT  
EAST BOSTON, MASSACHUSETTS**

MPA CONTRACT NO.: **L1303-C01** LOCATION CODE: **2640**

PROJECT SUBMISSION PHASE:  
**NOI PLANS**

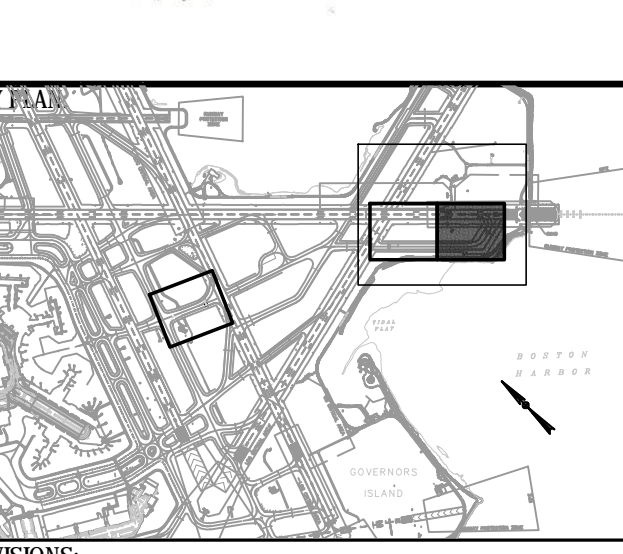
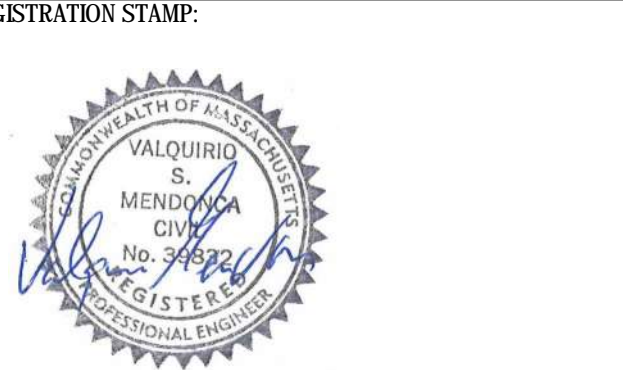

REVISIONS:

REV NO.	DATE	DESCRIPTION	BY:



CONSULTANT:

PROJECT NUMBER AND TITLE:  
**L1303-C1  
REHABILITATE A PORTION OF T/W C  
AND CONSTRUCT NEW STUB  
TAXIWAY**

SHEET TITLE:  
**GRADING PLAN - 3**

DISCIPLINE:  
**CIVIL**

DRAWN BY: **HJH** CHECKED BY: **CBC** APPROVED BY: **VSM**

SCALE: **AS NOTED** DATE: **3/07/18**

DRAWING NUMBER: SHEET NO. 5 OF 8

**C203**

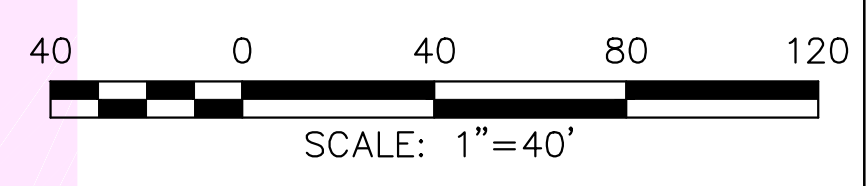

MPA - 2/15/2018 8:58:57 AM - T:\180652\W02\L1303-C1\Rehab a Portion of Taxiway C1\L1303-C1\_Rehab a Portion of Taxiway C1\L1303-C1\_Design\DWG\NOI Plans\L1303-C1\_Plan\L1303-C1\_C203.dwg, 3/2/2018 2:36:19 PM



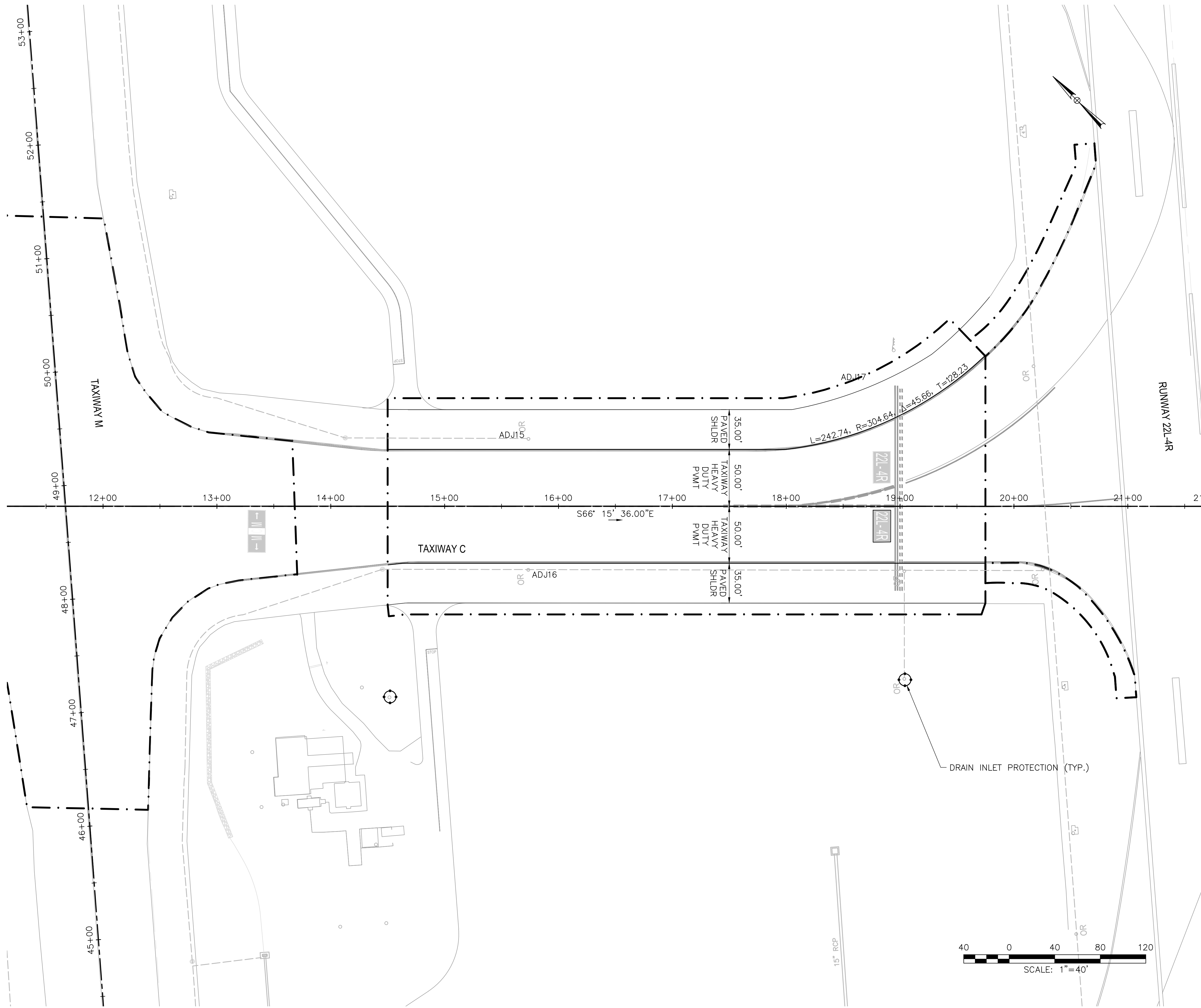

LEGEND	
PR. LIMIT OF WORK	---
DRAIN INLET PROTECTION DETAIL	
FIBER ROLL	.....



MASSACHUSETTS PORT AUTHORITY  
EAST BOSTON, MASSACHUSETTS 02128

PROJECT LOCATION:  
**LOGAN INTERNATIONAL AIRPORT**  
EAST BOSTON, MASSACHUSETTS

MPA CONTRACT NO.: **L1303-C01** LOCATION CODE: **2640**

PROJECT SUBMISSION PHASE:  
**NOI PLANS**

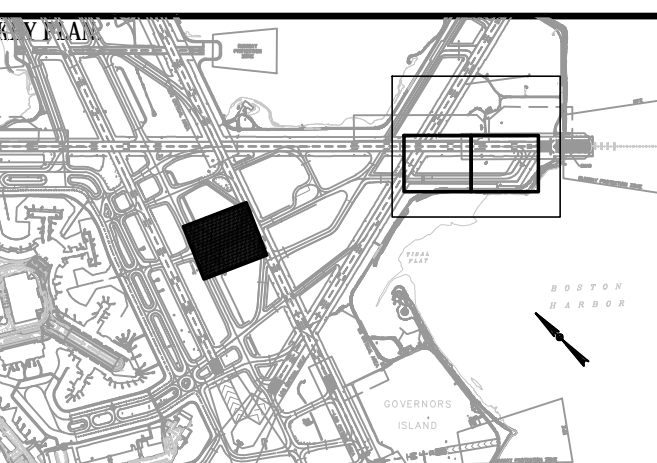
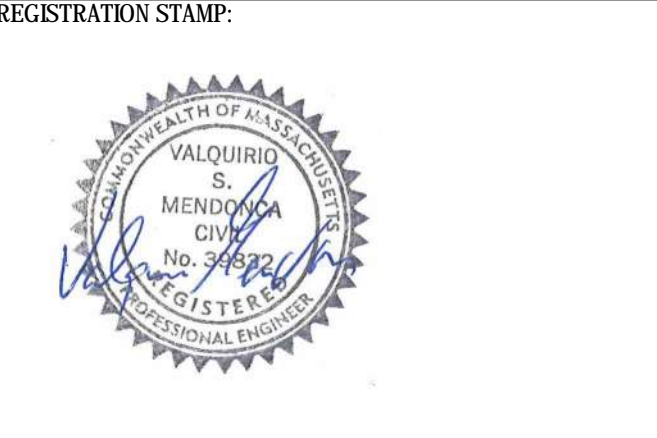

REVISIONS:

REV NO.	DATE	DESCRIPTION	BY:

PRIMARY:

WSP USA  
75 ARLINGTON STREET  
BOSTON, MA 02116

CONSULTANT:

PROJECT NUMBER AND TITLE:  
**L1303-C1**  
**REHABILITATE A PORTION OF T/W C**  
**AND CONSTRUCT NEW STUB**  
**TAXIWAY**

SHEET TITLE:  
**EROSION AND SEDIMENT CONTROL PLAN - 1**

DISCIPLINE:  
**CIVIL**

DRAWN BY:	CHECKED BY:	APPROVED BY:
HJH	CBC	VSM

SCALE:	DATE:
AS NOTED	3/07/18

DRAWING NUMBER: SHEET NO: 6 OF 8

**C801**

T:\19665W02-L1303-C1 Rehab a Portion of Taxiway C\L1303-C01\_Design\DWG\NOI Plans\L1303-C01\_Plan1\L1303-C01.dwg, 3/2/2018 2:52:17 PM



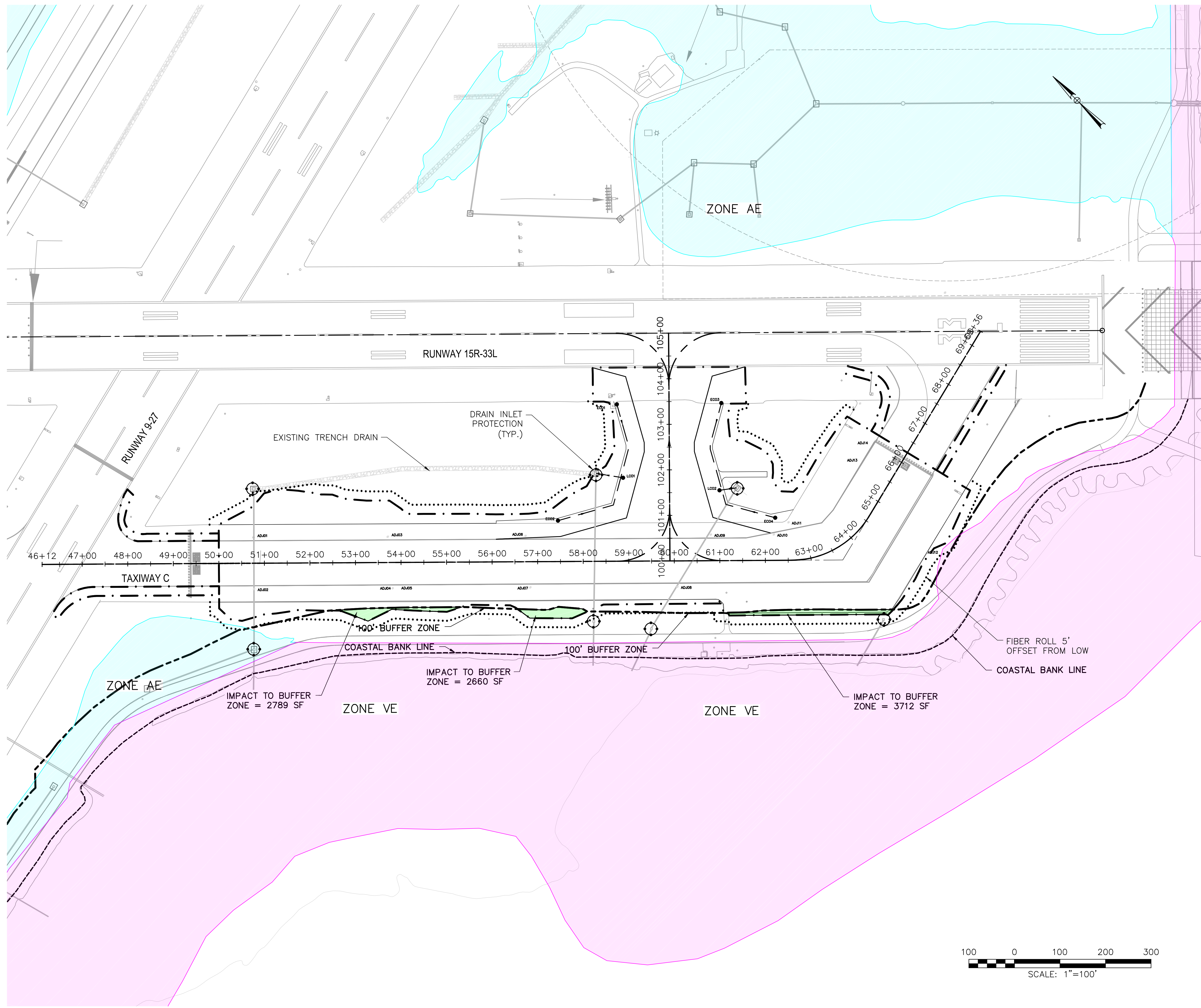

LEGEND	
PR. LIMIT OF WORK	---
DRAIN INLET PROTECTION DETAIL	
FIBER ROLL	.....

- GENERAL NOTES**
- NO EQUIPMENT OR MATERIALS SHALL BE STAGED OR STOCKPILED WITHIN THE BUFFER ZONE.
  - TOTAL PROJECT IMPACT TO BUFFER ZONE = 9,161 SF.



MASSACHUSETTS PORT AUTHORITY  
EAST BOSTON, MASSACHUSETTS 02128

PROJECT LOCATION:  
**LOGAN INTERNATIONAL AIRPORT  
EAST BOSTON, MASSACHUSETTS**

MPA CONTRACT NO.: **L1303-C01** LOCATION CODE: **2640**

PROJECT SUBMISSION PHASE:  
**NOI PLANS**

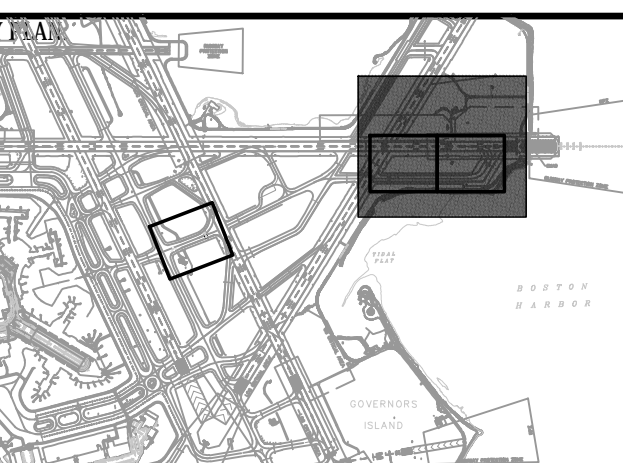
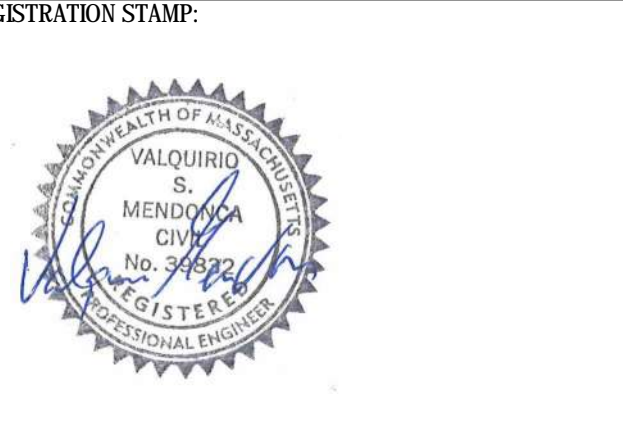

REVISIONS:

REV NO.	DATE	DESCRIPTION	BY:



WSP USA  
75 ARLINGTON STREET  
BOSTON, MA 02116

CONSULTANT:

PROJECT NUMBER AND TITLE:  
**L1303-C1  
REHABILITATE A PORTION OF T/W C  
AND CONSTRUCT NEW STUB  
TAXIWAY**

SHEET TITLE:  
**EROSION AND SEDIMENT CONTROL PLAN - 2**

DISCIPLINE:  
**CIVIL**

DRAWN BY:	CHECKED BY:	APPROVED BY:
HJH	CBC	VSM

SCALE:	DATE:
AS NOTED	3/07/18

DRAWING NUMBER: \_\_\_\_\_ SHEET NO: 7 OF 8

**C802**

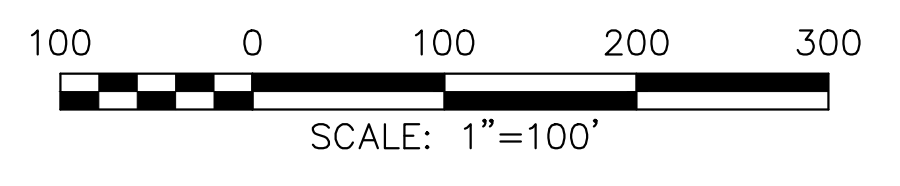

T:\19665W02-L1303-C1 Rehab a Portion of Taxiway C\L1303-C1\_Rehab a Portion of Taxiway C\L1303-C1\_Design\DWG\NOI Plans\L1303-C1\_Plan1\L1303-C1\_C802.dwg, 3/2/2018 3:07:08 PM





MASSACHUSETTS PORT AUTHORITY  
EAST BOSTON, MASSACHUSETTS 02128

PROJECT LOCATION:  
**LOGAN INTERNATIONAL AIRPORT  
EAST BOSTON, MASSACHUSETTS**

MPA CONTRACT NO.: **L1303-C01** LOCATION CODE: **2640**

PROJECT SUBMISSION PHASE:

**NOI PLANS**

REGISTRATION STAMP:

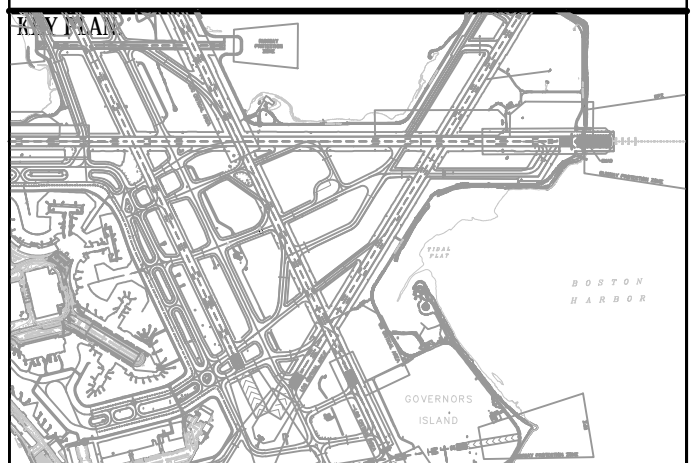

REVISIONS:

REV NO.	DATE	DESCRIPTION	BY:

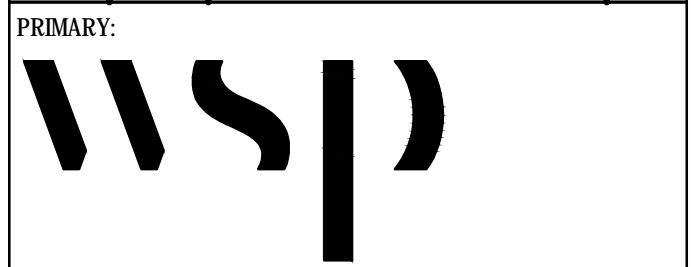

WSP USA  
75 ARLINGTON STREET  
BOSTON, MA 02116

CONSULTANT:

PROJECT NUMBER AND TITLE:

**L1303-C1**  
**REHABILITATE A PORTION OF T/W C  
AND CONSTRUCT NEW STUB  
TAXIWAY**

SHEET TITLE:

EROSION AND SEDIMENT CONTROL DETAILS

DISCIPLINE:  
**CIVIL**

DRAWN BY: **HJH** CHECKED BY: **CBC** APPROVED BY: **VSM**

SCALE: **NOT TO SCALE** DATE: **3/07/18**

DRAWING NUMBER: SHEET NO: 8 OF 8

**C803**

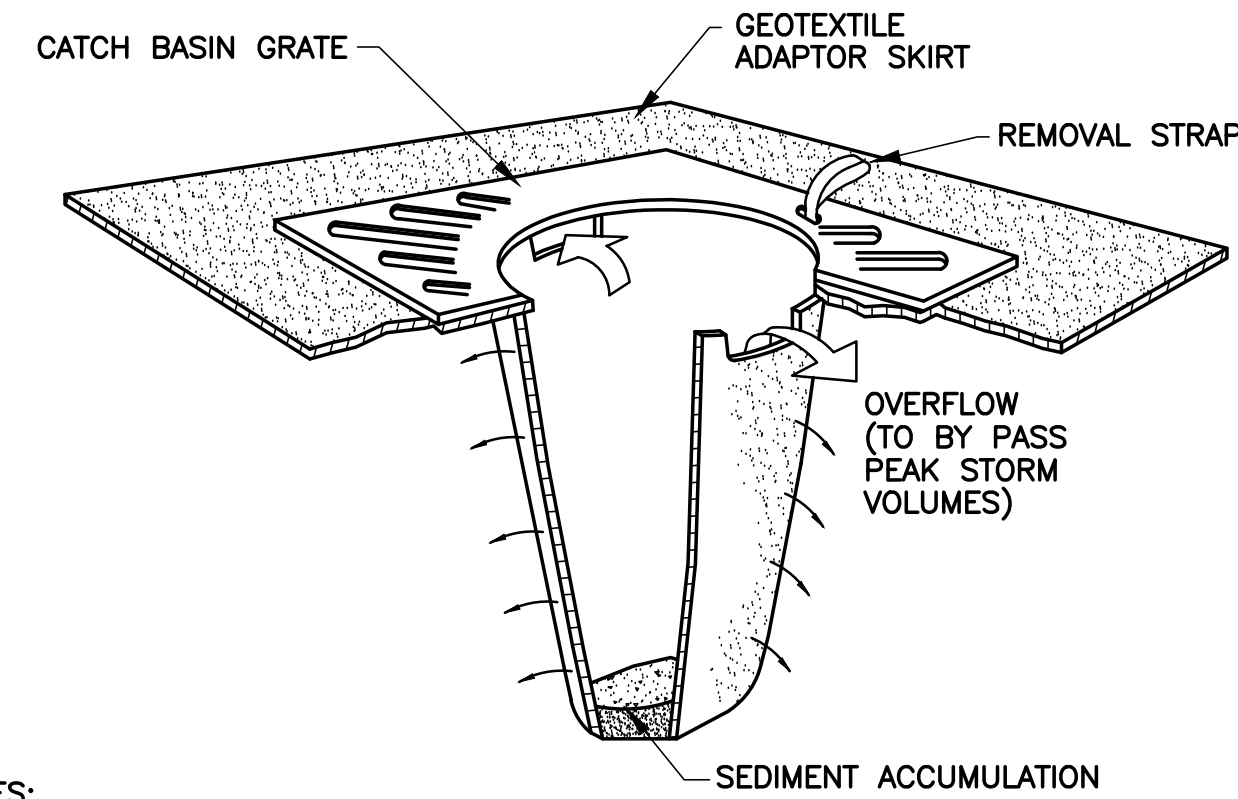

NOTES:

1. INSERT TO BE EMPTIED IN AN APPROVED MANNER WHEN IT IS 1/2 FULL OF SEDIMENT.
2. INSPECT INSERT AFTER ALL RAINFALL EVENTS, REPAIR AND MAINTAIN AS REQUIRED.
3. USE AT ALL EXISTING AND PROPOSED CATCH BASINS.
4. SEE TECHNICAL SPEC. SECTION P-156 FOR FURTHER DETAILS.

**DRAIN INLET PROTECTION**  
NO SCALE

DEWATERING SEDIMENT CONTROL NOTES:

1. DISCHARGE DEWATERING ON GRADE TO ALLOW EXISTING TURF TO FILTER SEDIMENT. WHERE SHOWN ON PLANS OR AS DIRECTED BY THE ENGINEER, INSTALL CATCH BASIN PROTECTION AND FIBER ROLL EROSION CONTROL MEASURES.
2. THE CONTRACTOR SHALL ANTICIPATE DEWATERING ALL TRENCHES. CONTRACTOR SHALL FURNISH ALL LABOR, EQUIPMENT, EROSION CONTROL, MATERIAL AND INCIDENTALS NECESSARY FOR DEWATERING. DEWATERING SHALL NOT BE SEPARATELY MEASURED, BUT SHALL BE CONSIDERED INCIDENTAL TO THE VARIOUS PAY ITEMS.
3. ADVISE THE OWNER OF IF ANY CONTAMINATED WATER IS FOUND. PROCESS CONTAMINATED WATER IN ACCORDANCE WITH GROUNDWATER MANAGEMENT AND HEALTH AND SAFETY PLAN.
4. THE CONTRACTOR SHALL INCORPORATE THESE EROSION DETAILS AS A MINIMUM IN THE SWPP PLAN TO BE APPROVED BY THE AUTHORITY.

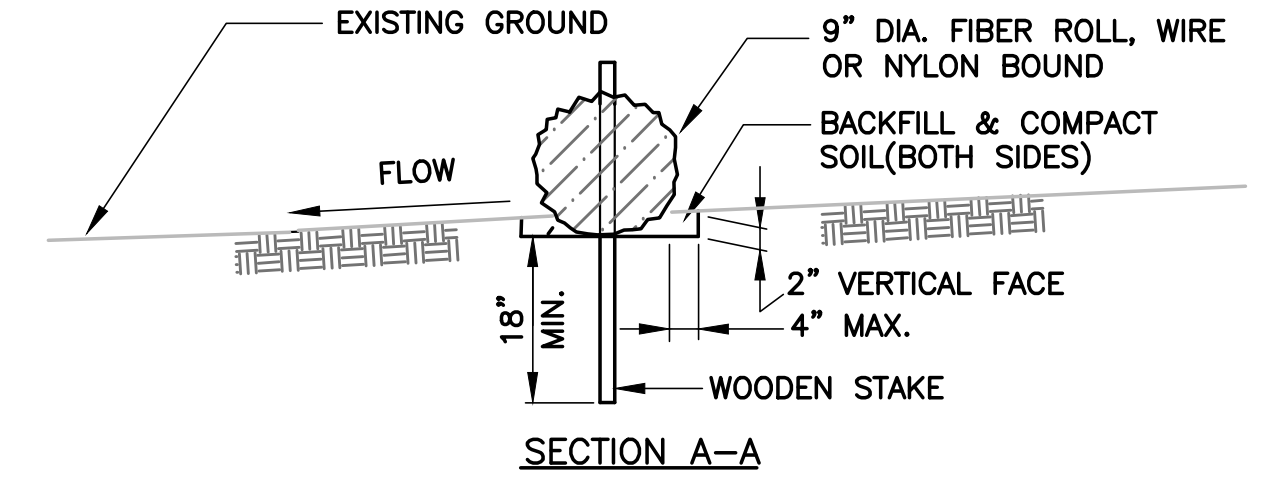

A

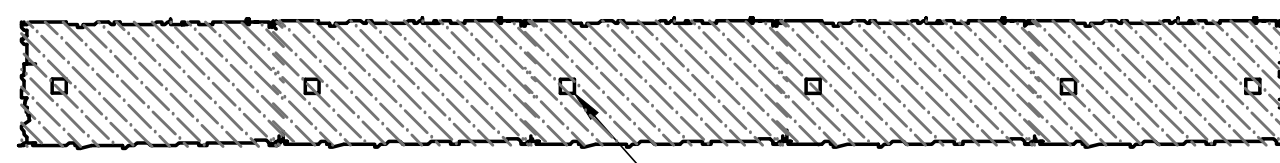

A

NOTE:

1. AREAS DISTURBED BY EROSION BARRIERS SHALL BE STABILIZED AFTER REMOVAL

**FIBER ROLL DETAIL**  
NO SCALE

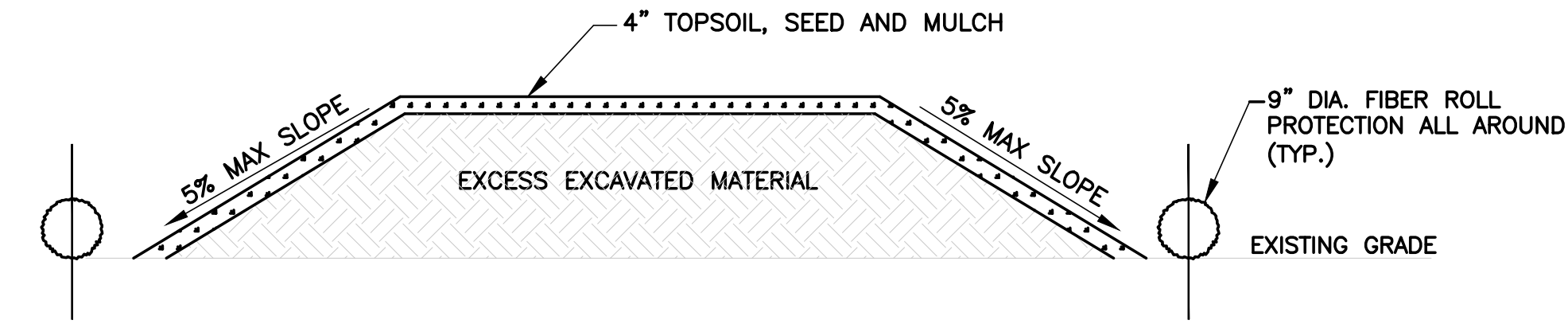

NOTE:

1. EXCESS MATERIAL SHALL BE HAULED TO AND DISPOSED OF AT GOVERNOR'S ISLAND OR AS DIRECTED BY THE ENGINEER.
2. TOPSOIL, SEEDING AND MULCHING SHALL BE CONSIDERED INCIDENTAL TO THOSE ITEMS FOR WHICH THE EXCAVATION IS ASSOCIATED WITH.
3. TEMPORARY STOCKPILES SHALL BE MAINTAINED IN ACCORDANCE WITH PROJECT SPECIFICATIONS.

**ON-SITE DISPOSAL DETAIL**  
NO SCALE

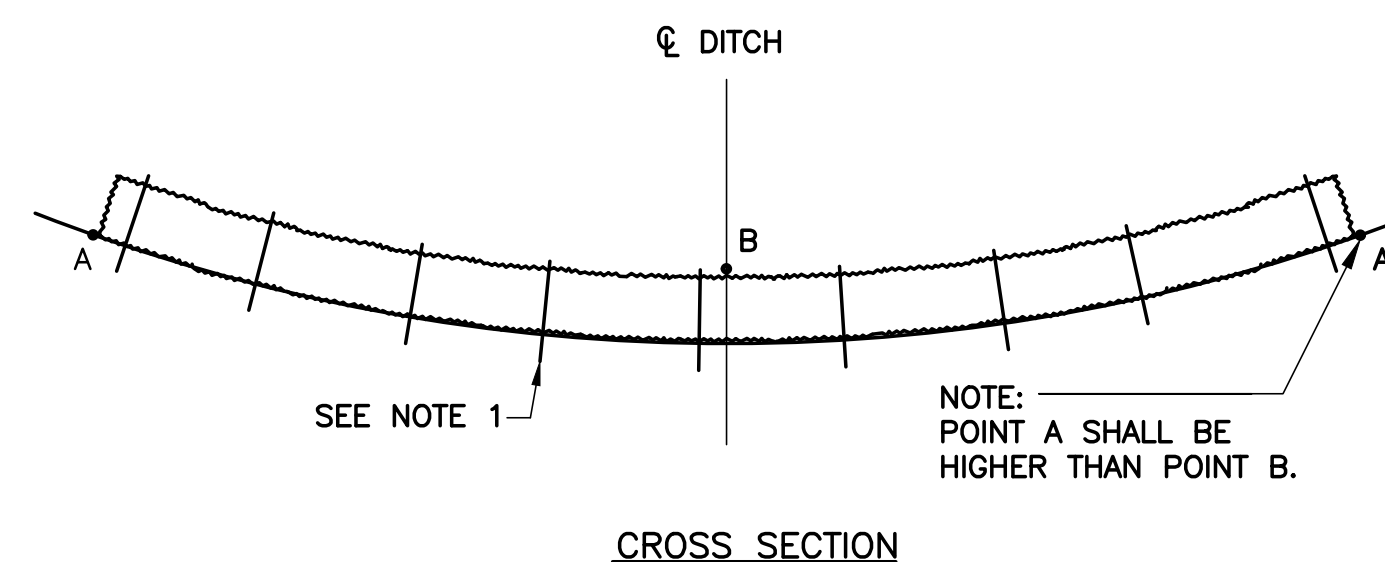

NOTE:

1. SECURE FIBER ROLL WITH 2" SQUARE, 36" LONG WOODEN STAKES, 3'-4" O.C.

**FIBER ROLL - DITCH CHECK DAM**  
NO SCALE