

273 Newbury Street, Boston, Ma, 02116  
Current Conditions

9/6/2017





273 Newbury Street, Boston, Ma, 02116

9/6/2017

Current Conditions





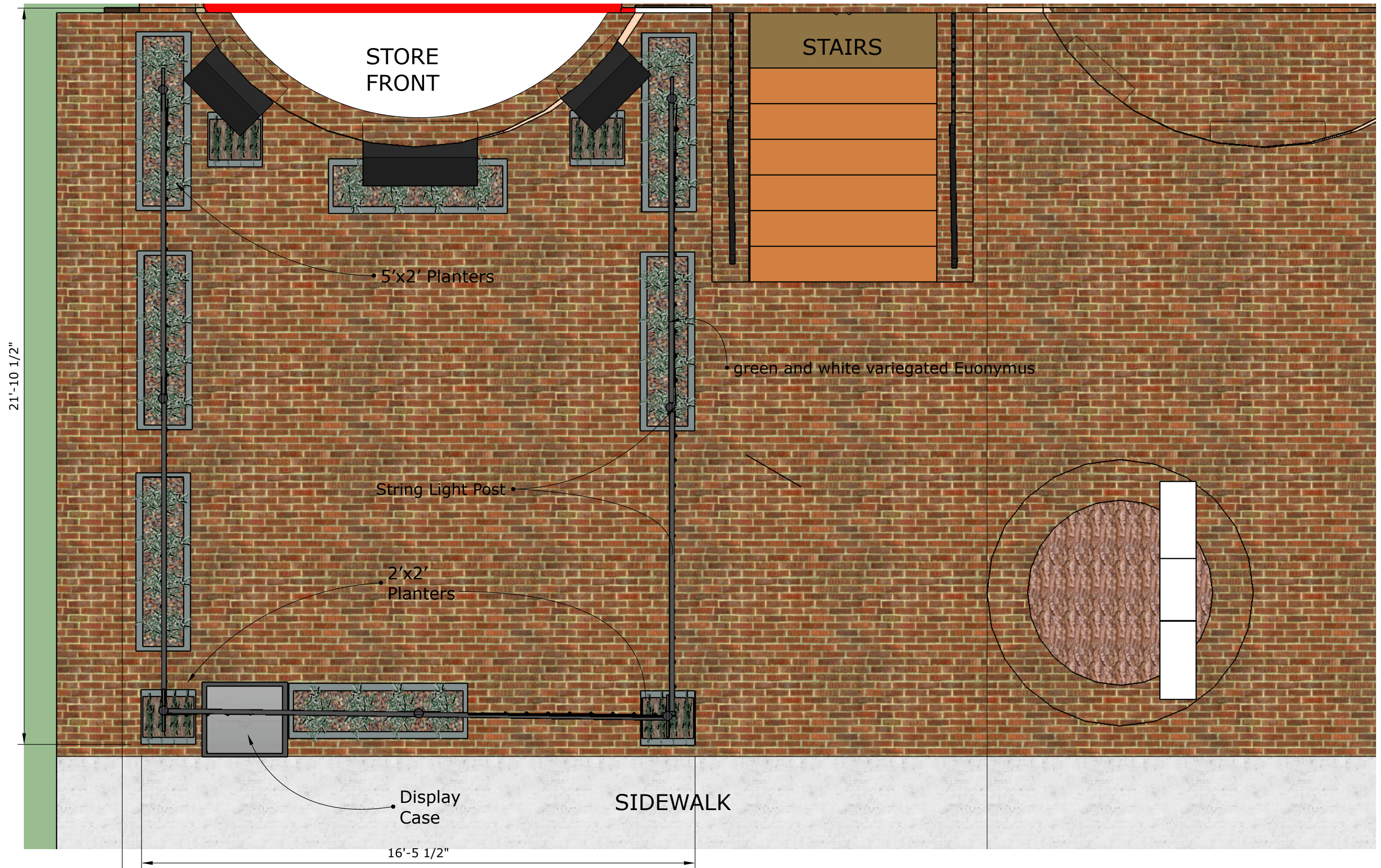



273 Newbury Street, Boston, Ma, 02116

9/6/2017

Removable metal poles to hold string lighting, Matte Black,  
84" L x 3" W

Amount: 7



Description: These poles will be placed inside a cement bucket, inside the planter. The poles will be able to be removed and they will be used for seasonal occasions. There will be poles in-between to connect them for structural purposes.



273 Newbury Street, Boston, Ma, 02116

9/6/2017

Removable metal poles to hold string lighting, Matte Black,  
84" L x 3" W

Amount: 7



Description: The poles will be able to be removed and a similar cement bucket will be able to receive the pole. The bucket will be concealed by the planter, soil, and plants.



273 Newbury Street, Boston, Ma, 02116  
Examples of display Cases

9/6/2017

Hotel Tabard Inn

Itadaki, 269 Newbury Street



Examples of outdoor display cases we took as inspiration.



273 Newbury Street, Boston, Ma, 02116  
Display Case

8/17/2017

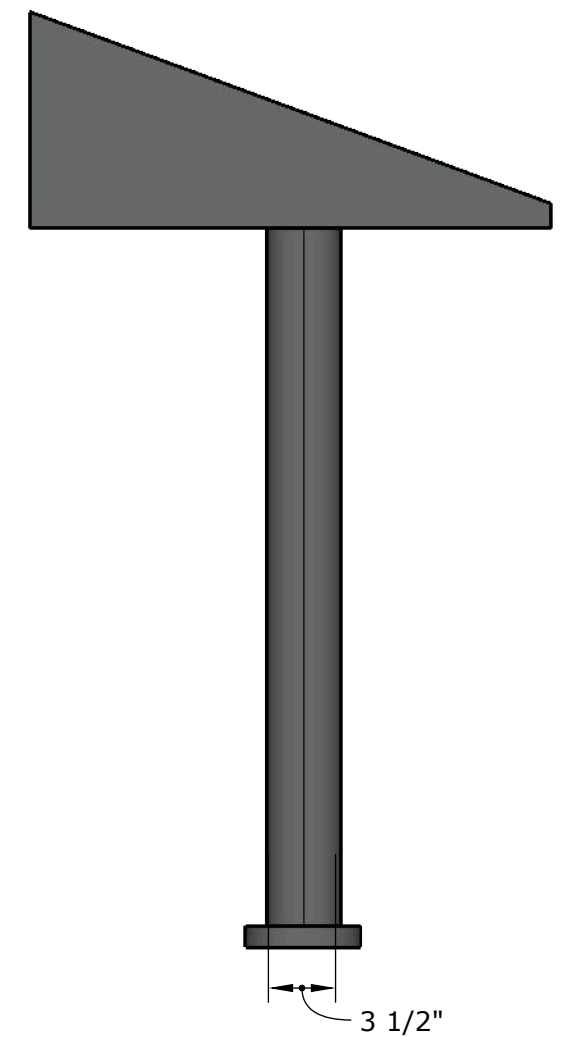
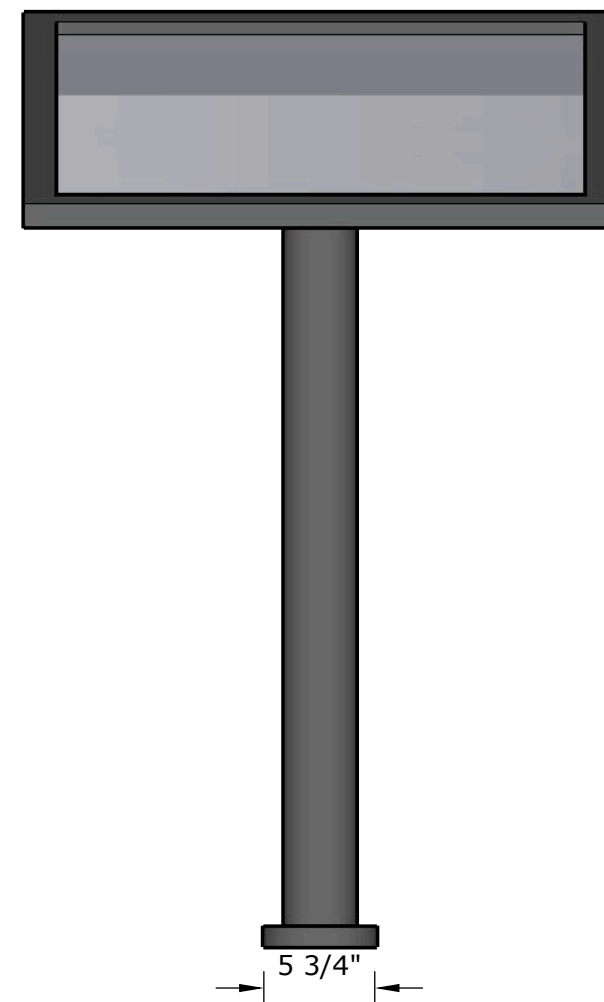
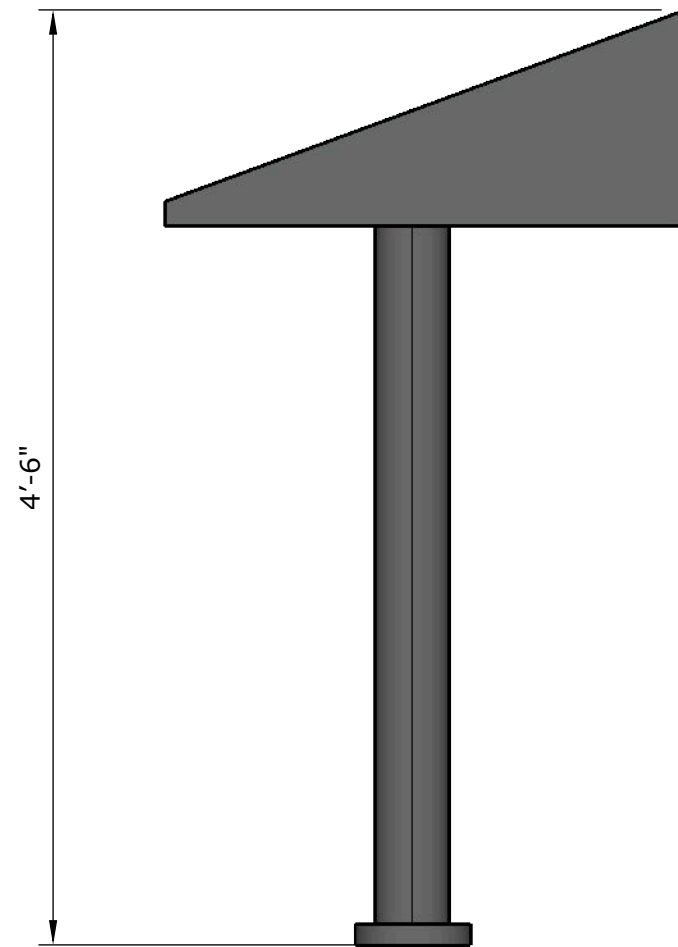
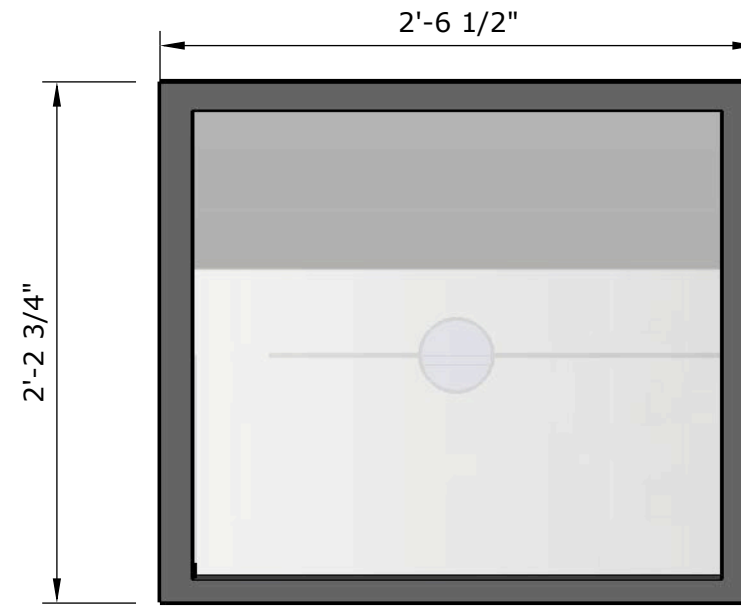

Description: The Display case will be made out of metal and glass. There will be minimal battery powered lighting inside. The glass box will be locked and secured to the brick patio with four fasteners. We will be displaying brand imagery, newsletters, and inexpensive products.







273 Newbury Street, Boston, Ma, 02116

9/6/2017

Coral Coast Aster Wood Patio Raised Planter Box

Rectangle: 70L x 21D x 17H in.

Square: 21L x 21D x 17H in.

green and white variegated  
Euonymus



Description: Placing seven 5'x2' planters and four 2'x2' planters designated in the layout drawing on page 3. They will be 3' tall and filled with green and white variegated Euonymus shown in the photo on the right.







