





Proviso 1: That the profile of the rooftop addition on the Archer Building be reduced as much as possible.

Proviso 2: That the details of the entrance, including how the columns are engaged, the color between the columns and the recessed entry way materials to improve the depths, and so the Donahue Addition reads as the main entrance with the possibility of adding a canopy.

Proviso 3: That the window details be restudied including the size of the openings, configuration, operation, profiles, and the details of the corner windows.

Proviso 4: That a final lighting plan be submitted, including for the Ridgeway Lane facade.

Proviso 5: That detailed drawings for the replacement doors and transoms including cutsheets for the hardware be submitted.

Proviso 6: That the materials be restudied, including the number of materials and finishes.

Proviso 7: That the configuration of the infill at the entrances on the passageway (North) Facade be restudied.

Proviso 8: And that the shape, size and materials of the planters at the passageway be restudied.



Temple Street Existing Elevation

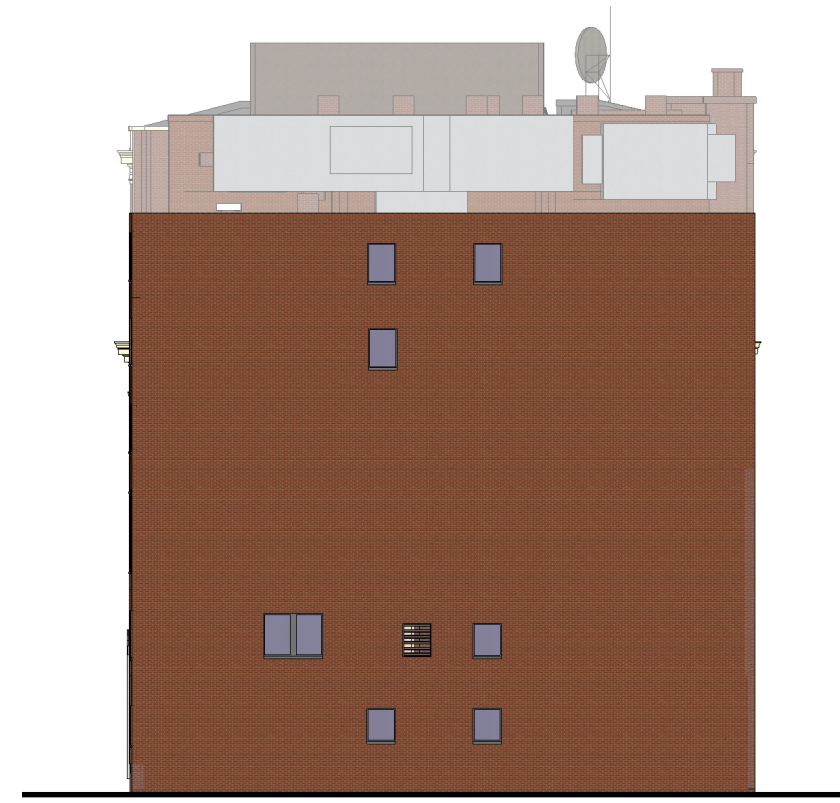

Alley (North) Existing Elevation



Temple Street Elevation



Alley (North) Elevation



Ridgeway Lane Existing Elevation



Derne Street Existing Elevation



Ridgeway Lane Elevation



Derne Street Elevation



Temple Street Existing Elevation

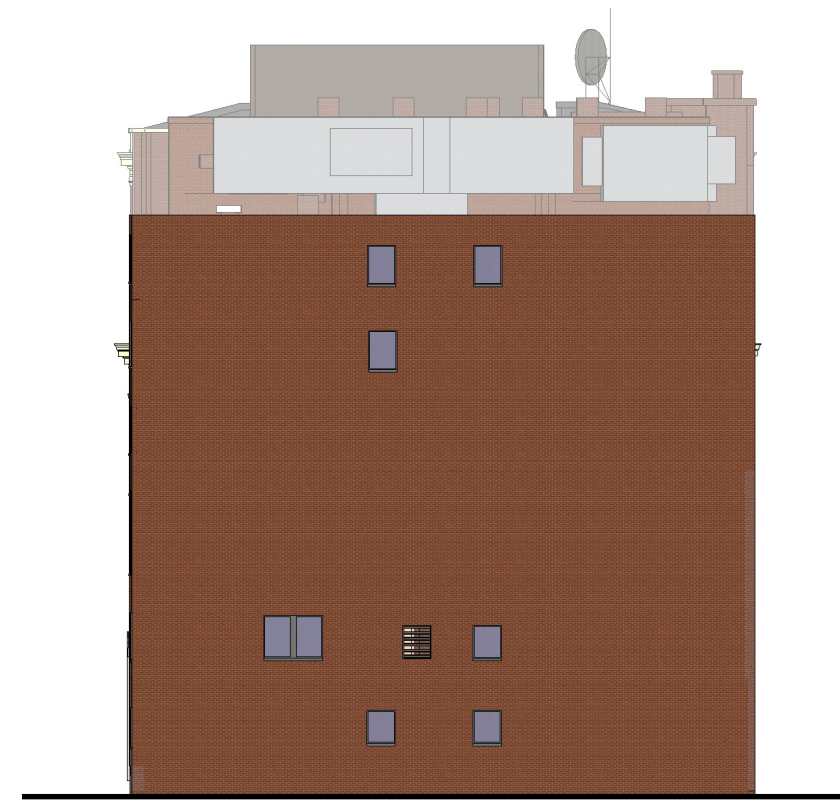

Alley (North) Existing Elevation



Temple Street Elevation



Alley (North) Elevation



Ridgeway Lane Existing Elevation



Derne Street Existing Elevation



Ridgeway Lane Elevation



Derne Street Elevation

Proviso 1: That the profile of the rooftop addition on the Archer Building be reduced as much as possible.

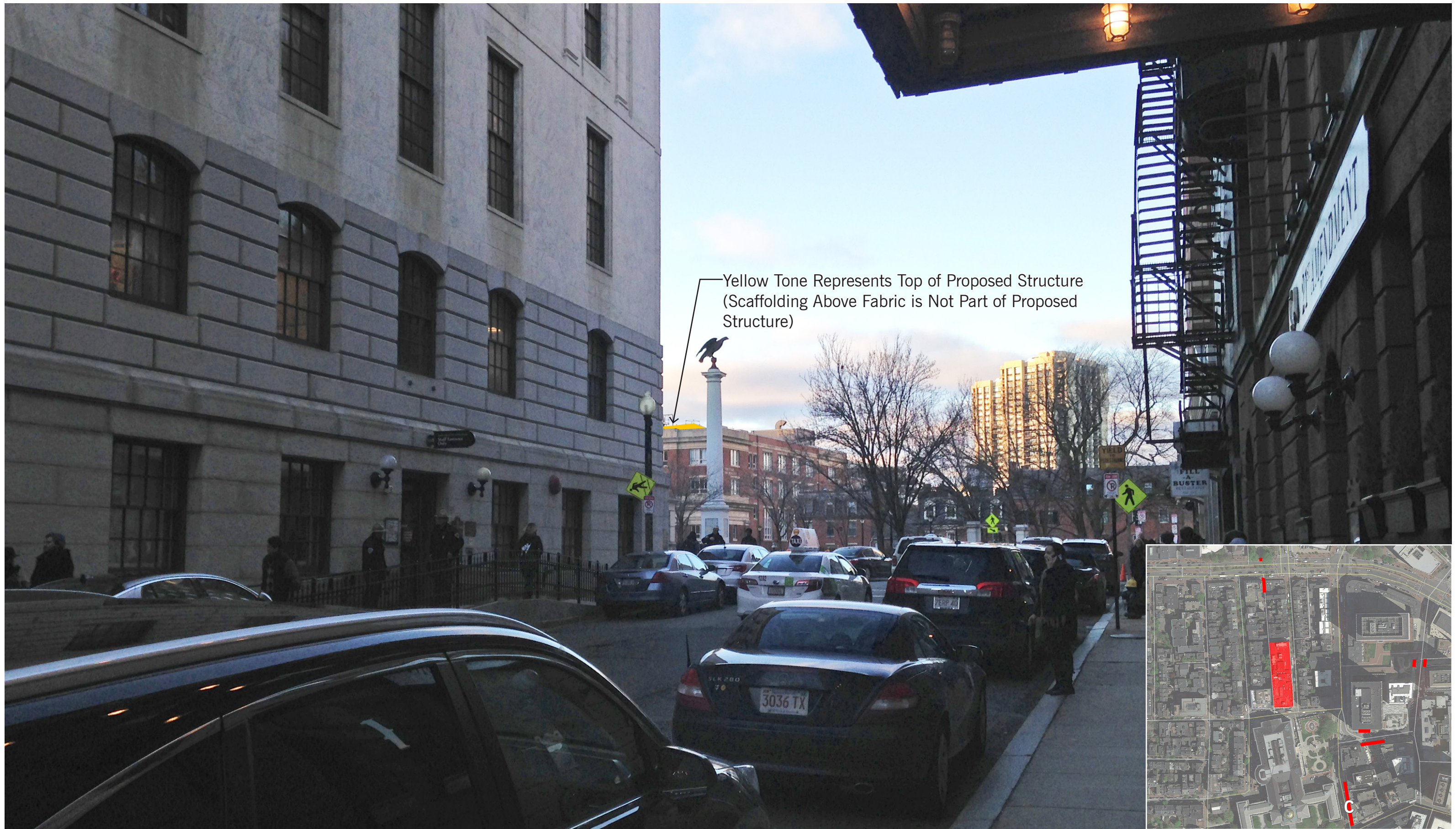

Yellow Tone Represents Top of Proposed Structure
(Scaffolding Above Fabric is Not Part of Proposed Structure)



Yellow Tone Represents Top of Proposed Structure

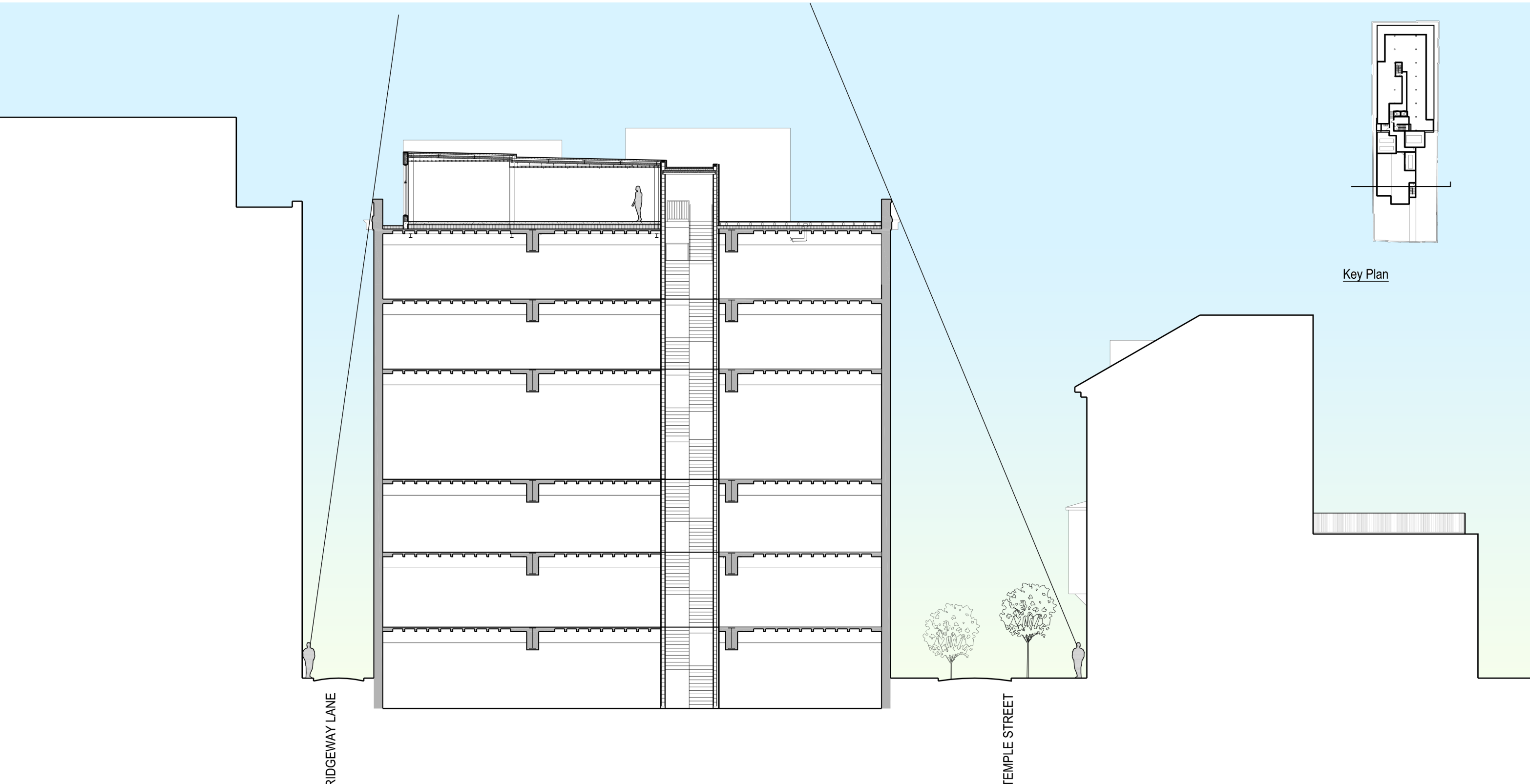

RIDGWAY LANE

TEMPLE STREET

Key Plan

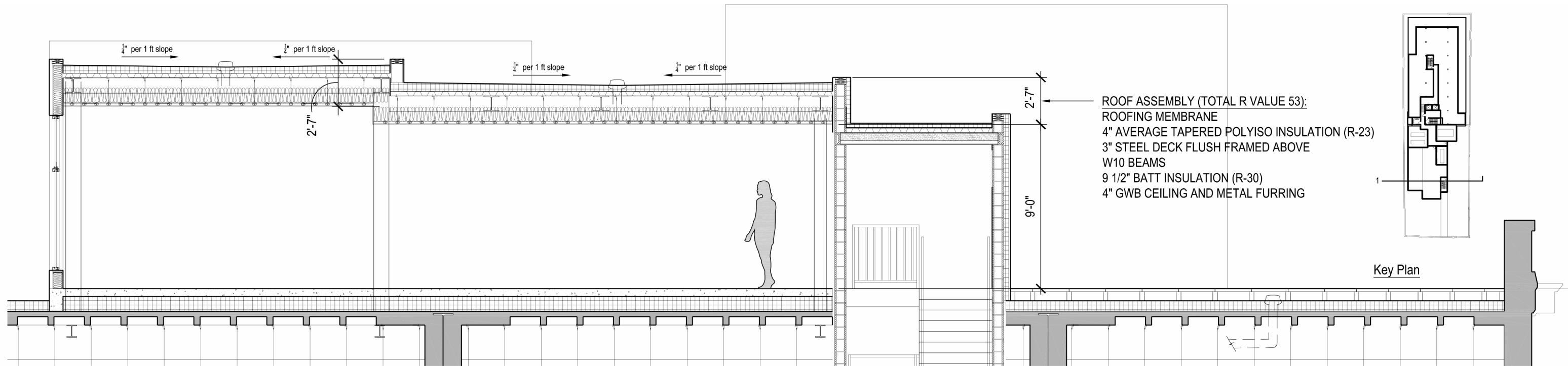

2 Archer Rooftop Addition February Section
 SCALE: 3/16" = 1'-0"

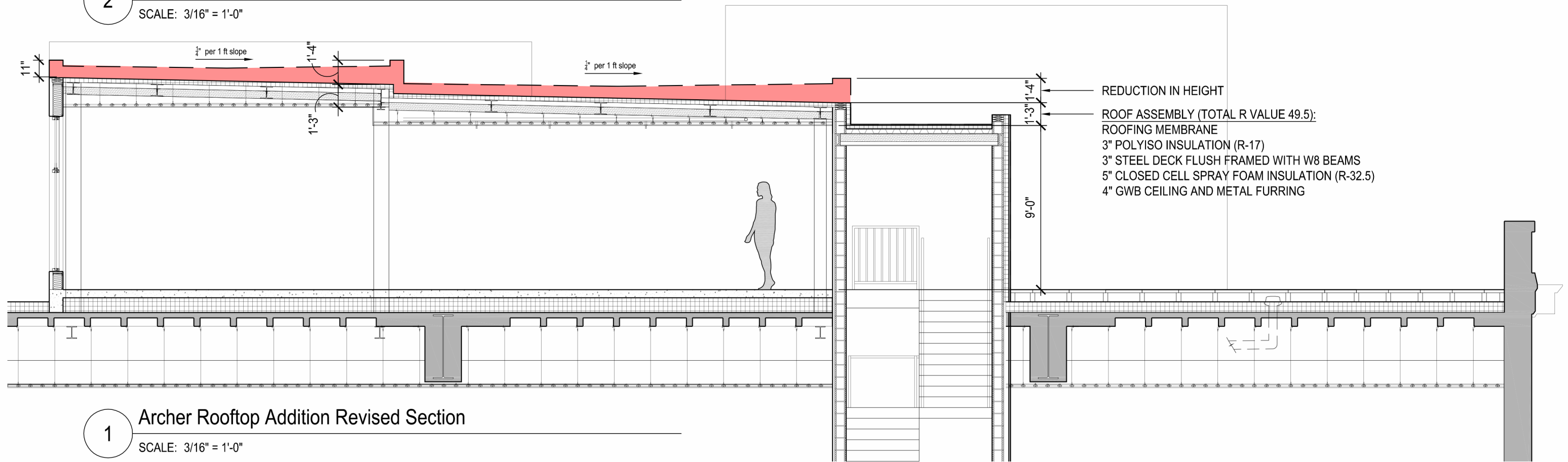

1 Archer Rooftop Addition Revised Section
 SCALE: 3/16" = 1'-0"

Proviso 2: That the details of the entrance, including how the columns are engaged, the color between the columns and the recessed entry way materials to improve the depths, and so the Donahue Addition reads as the main entrance with the possibility of adding a canopy.

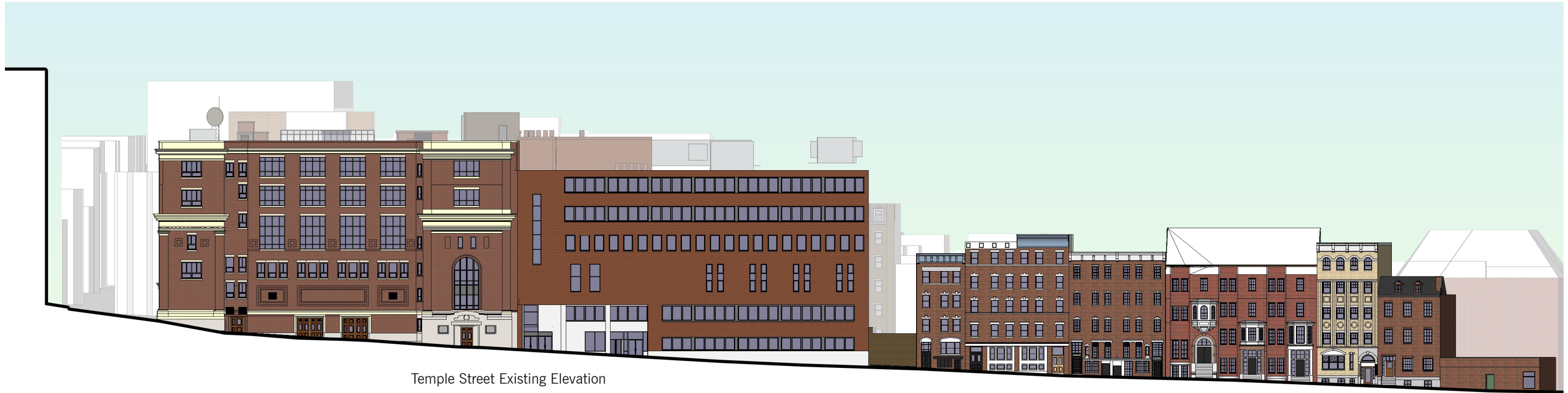

Temple Street Existing Elevation



Temple Street Proposed Elevation

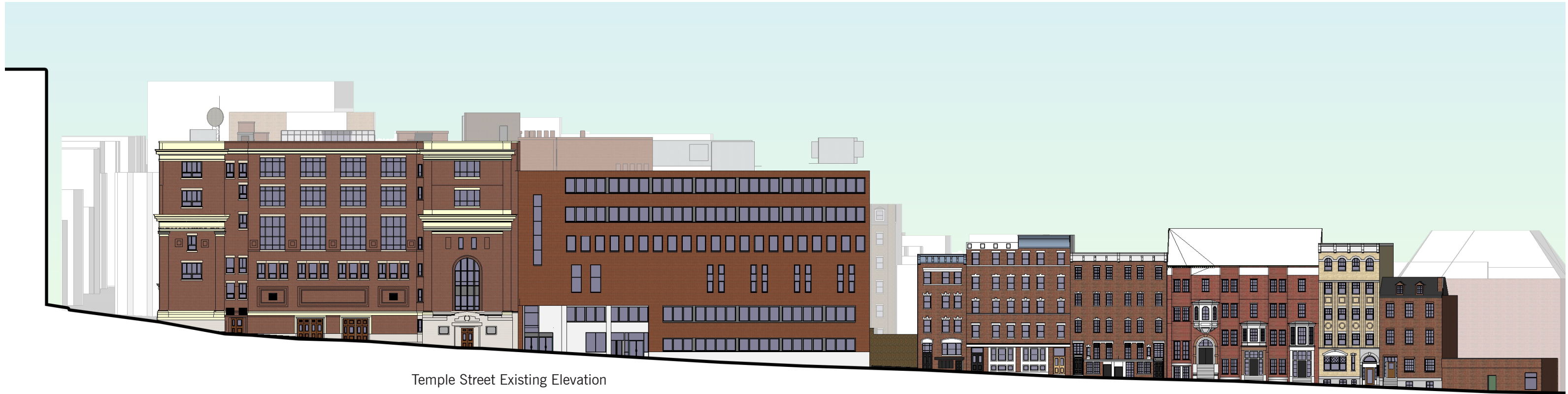

Temple Street Existing Elevation



Temple Street Proposed Elevation



Archer | Donahue
Boston, MA

Temple Street Elevation

March 29, 2017

DEVELOPER : JDMD Owner, LLC

ARCHITECT : The Architectural Team

tat | the architectural team

14188



Archer | Donahue
Boston, MA

Entry from South

March 29, 2017

DEVELOPER : JDMD Owner, LLC

ARCHITECT : The Architectural Team

tat | the architectural team

14188







Archer | Donahue
Boston, MA

View from Park

March 29, 2017

DEVELOPER : JDMD Owner, LLC

ARCHITECT : The Architectural Team

tat | the architectural team

14188

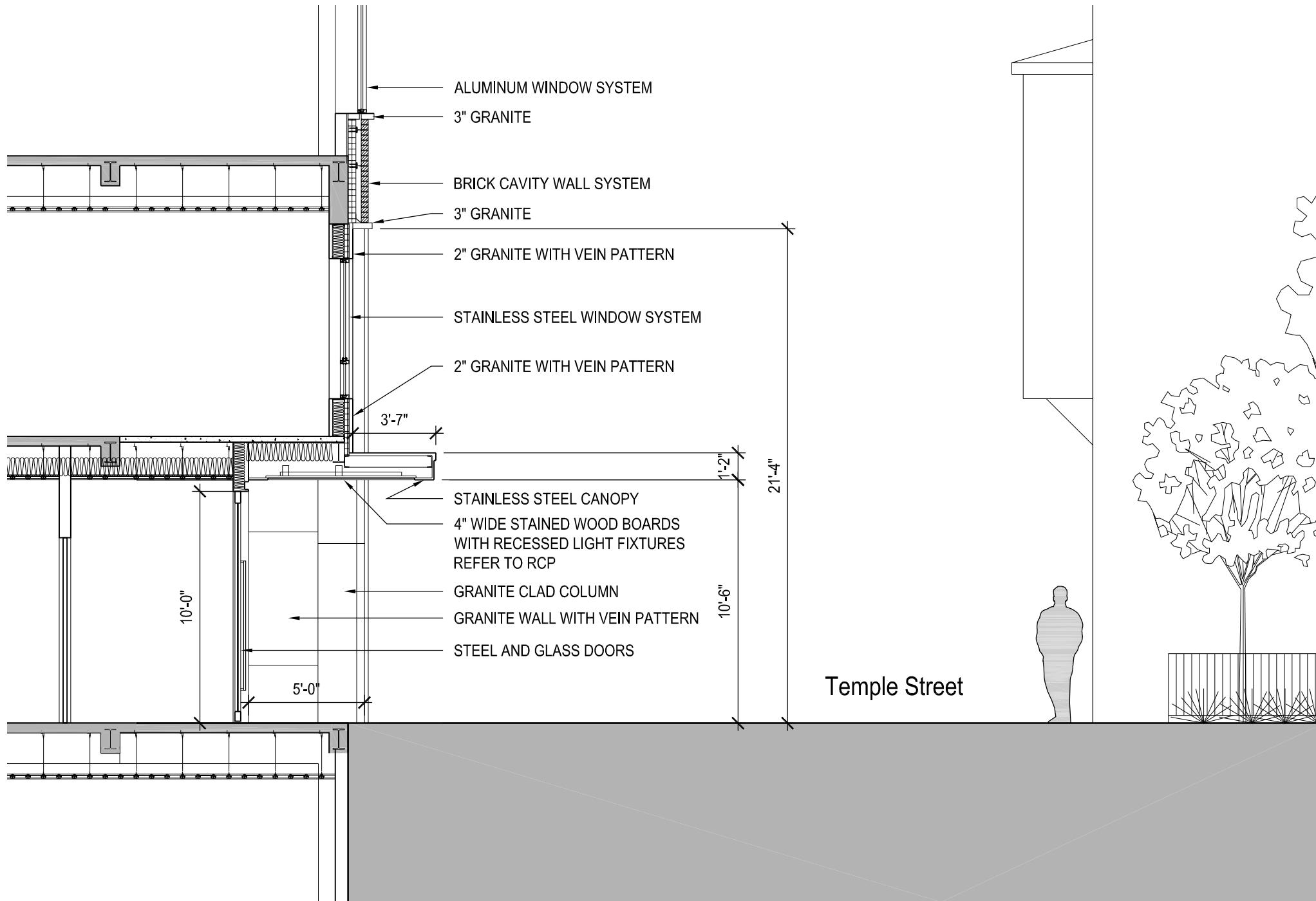

1 Donahue Entry at Canopy
SCALE: 3/16" = 1'-0"

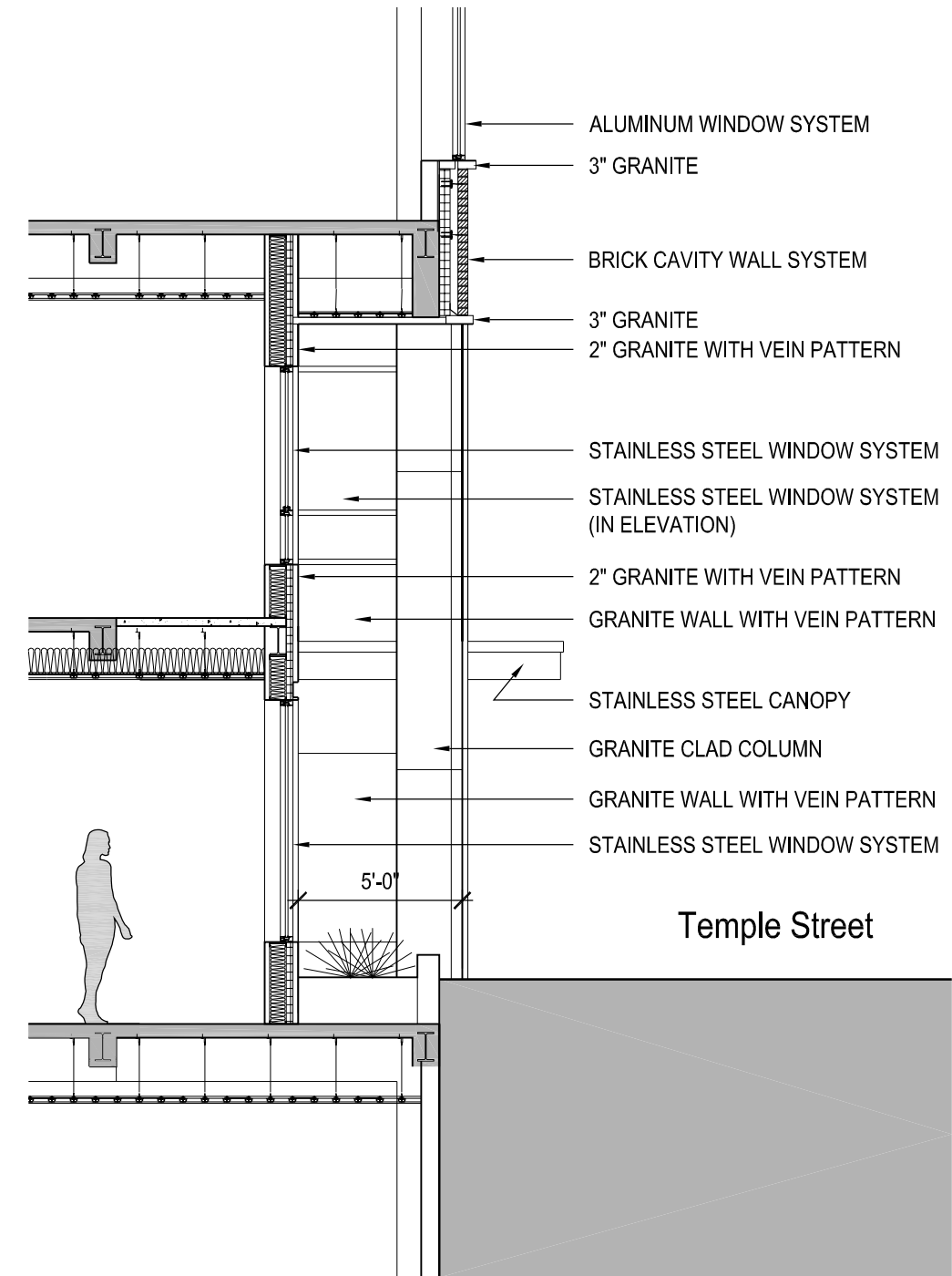

1 Donahue Entry at Recess
SCALE: 3/16" = 1'-0"

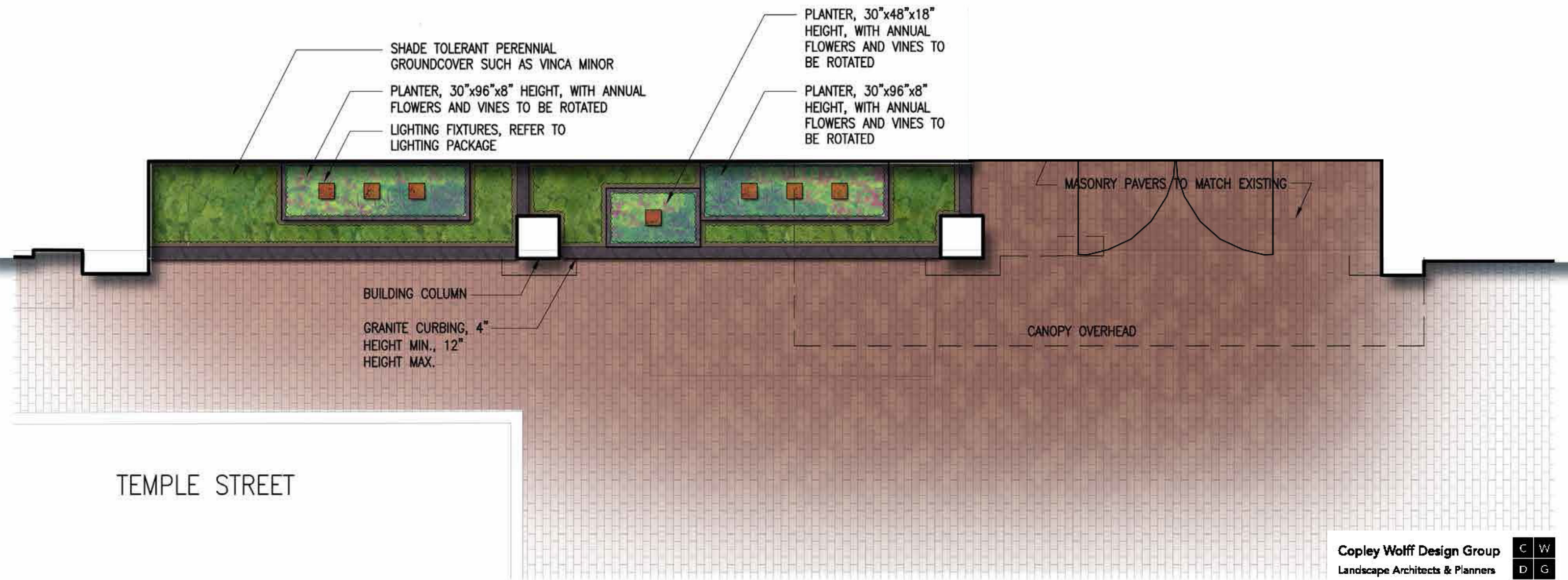



Copley Wolff Design Group
Landscape Architects & Planners



Proviso 3: That the window details be restudied including the size of the openings, configuration, operation, profiles, and the details of the corner windows.



Archer | Donahue
Boston, MA

Archer Original Windows

March 29, 2017

DEVELOPER : JDMD Owner, LLC

ARCHITECT : The Architectural Team

tat | the architectural team

14188

Original Metal Windows

Replacement Windows



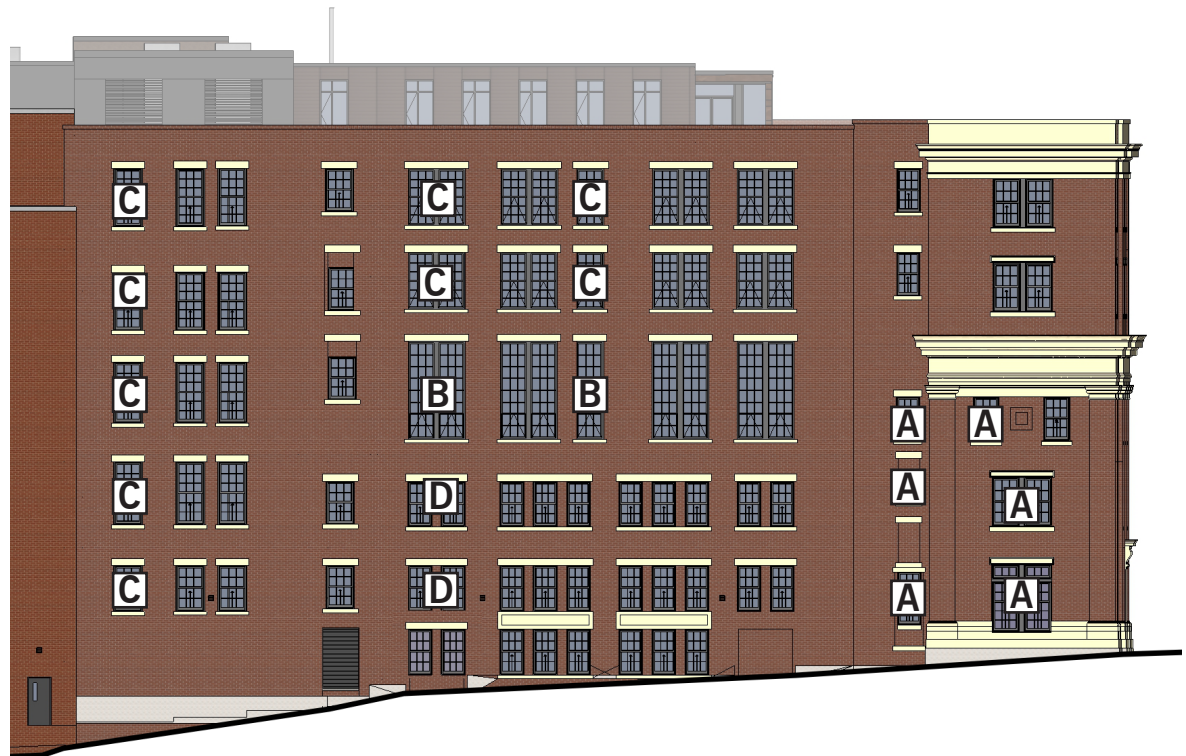

Ridgeway Lane Street Elevation

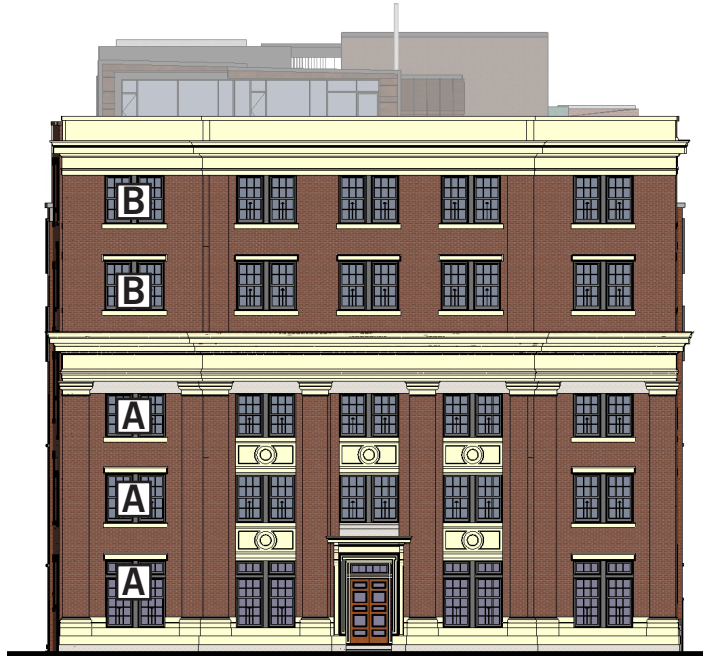

Derne Street Elevation



Temple Street Elevation

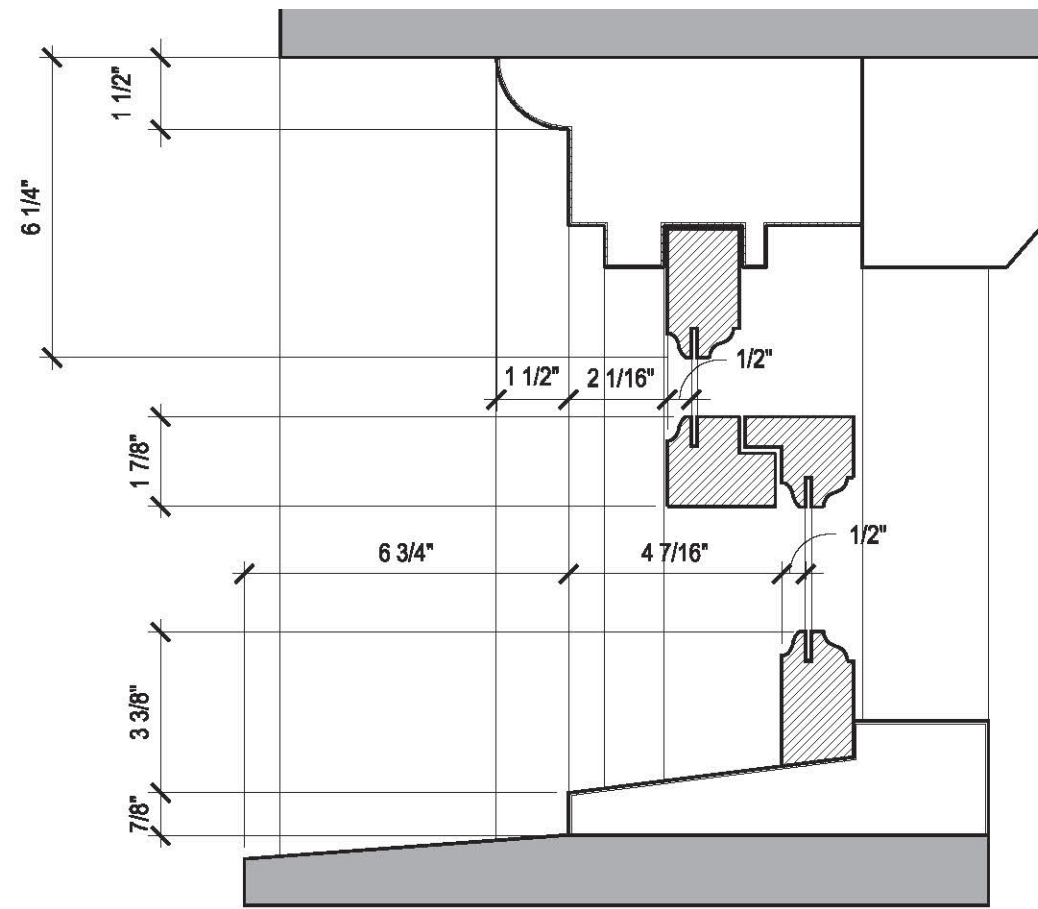

HEAD
DETAIL

MTG RAIL
DETAIL

SILL
DETAIL

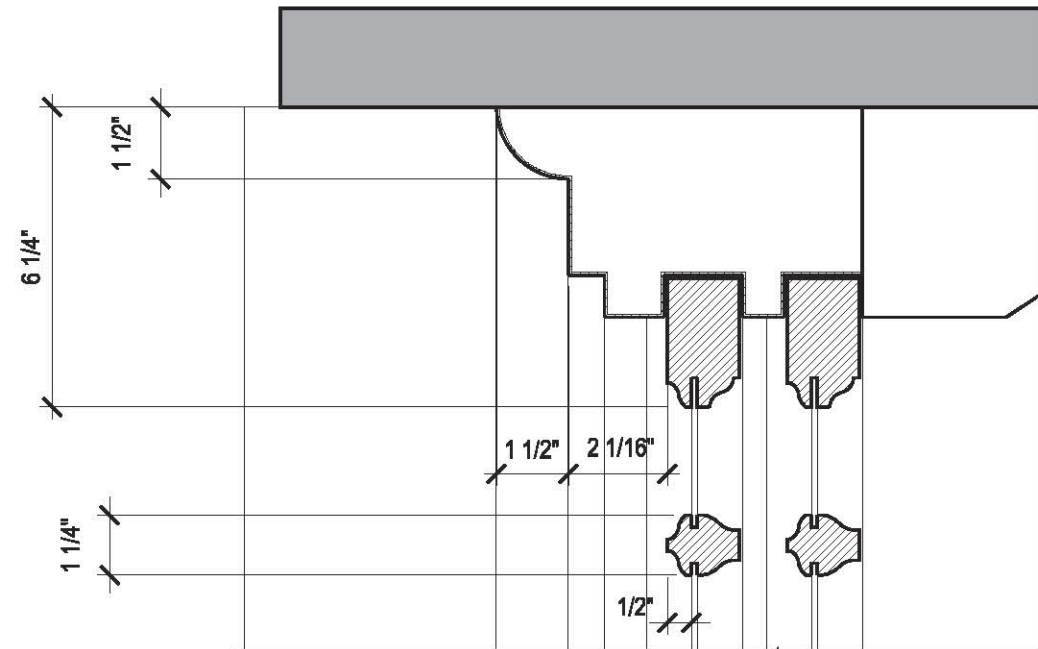

JAMB
DETAIL

MUNTIN
DETAIL

A TYPE A - WINDOW DETAILS - EXISTING
SCALE: 3" = 1'-0"

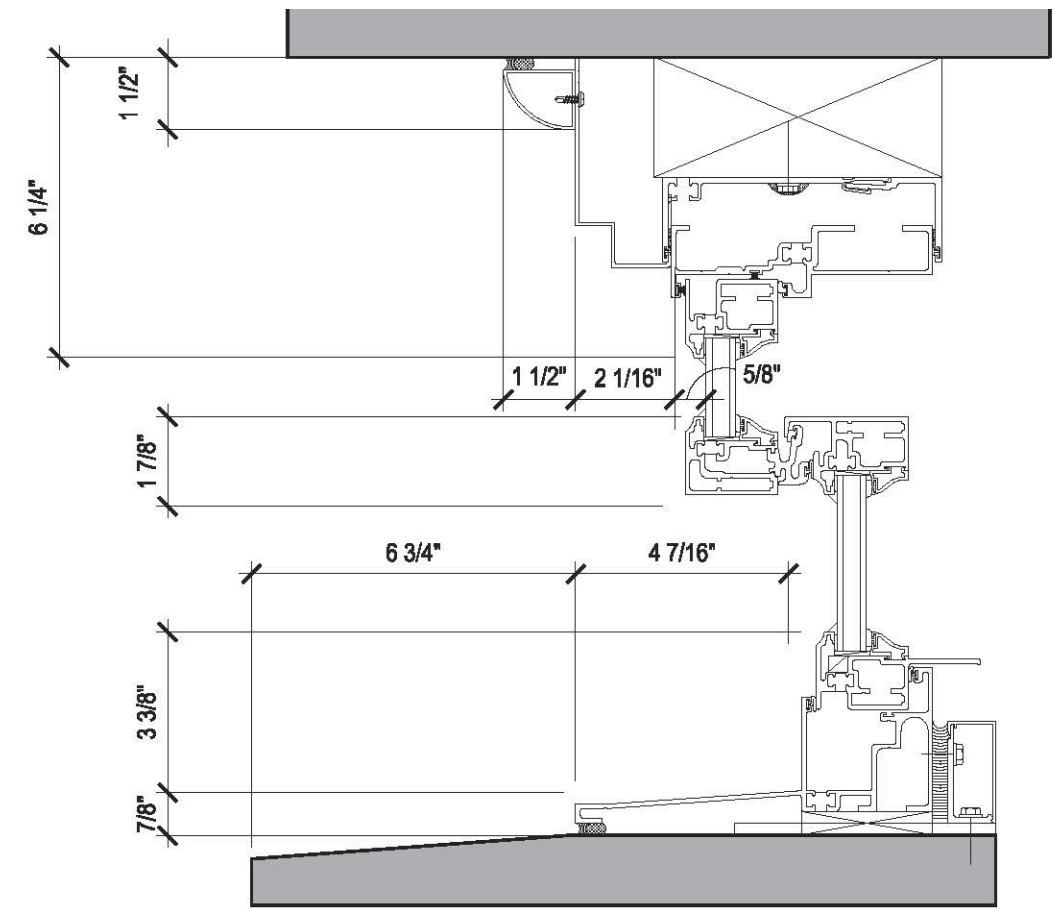

HEAD
DETAIL

MTG RAIL
DETAIL

SILL
DETAIL

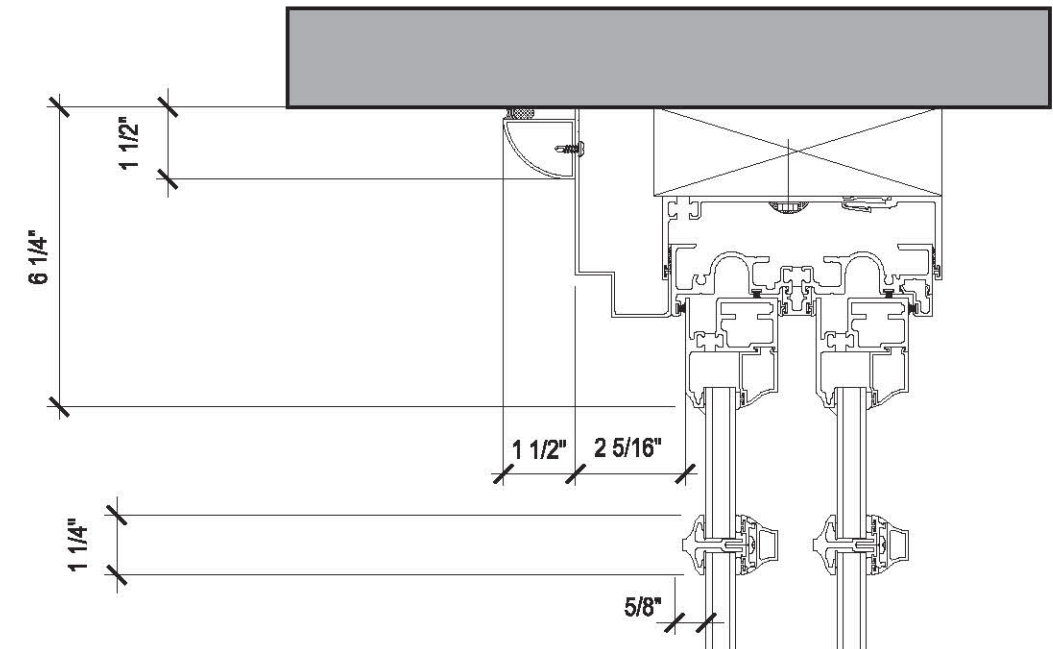

JAMB
DETAIL

MUNTIN
DETAIL

A TYPE A - WINDOW DETAILS- PROPOSED
SCALE: 3" = 1'-0"

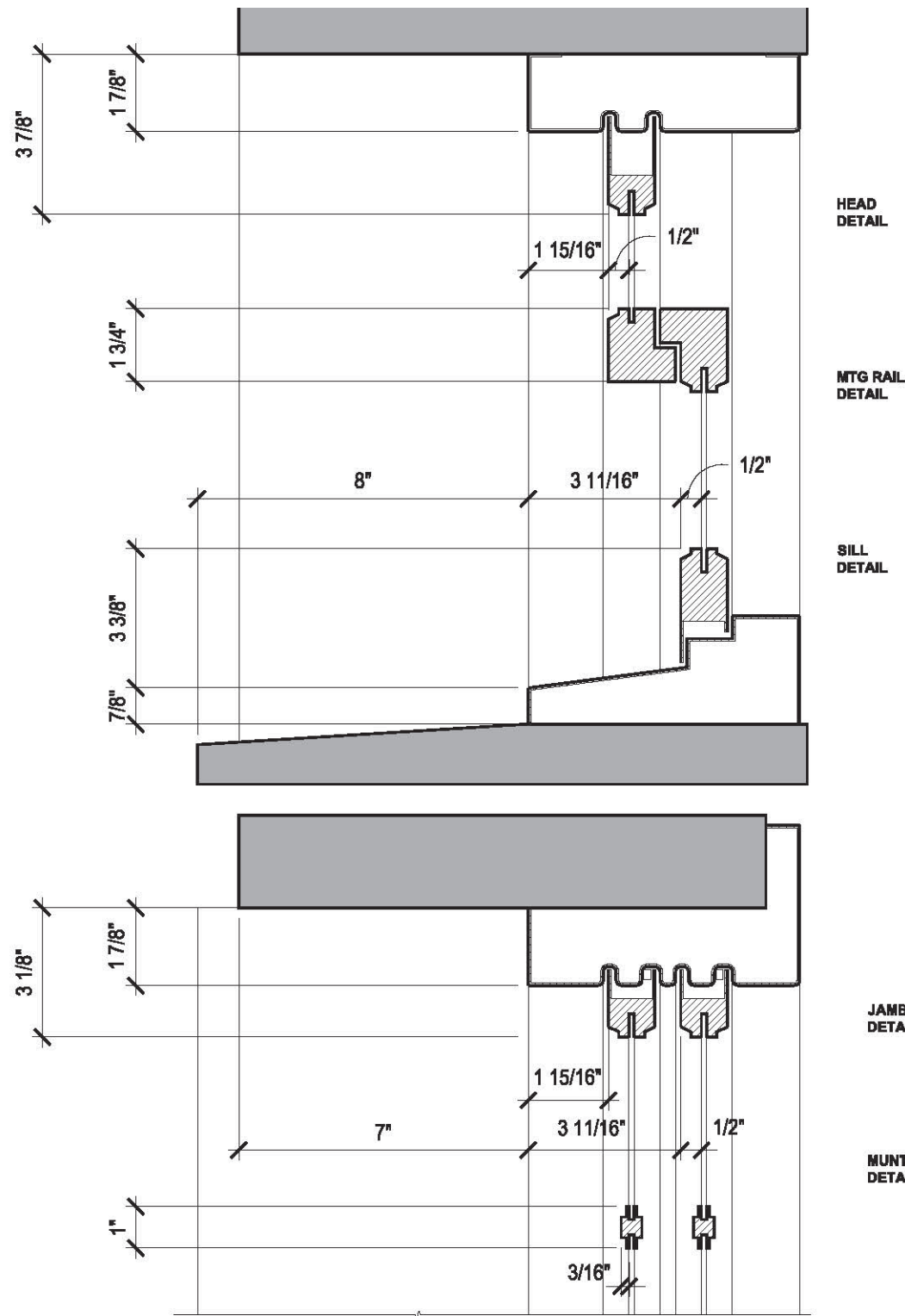

B TYPE B - WINDOW DETAIL - EXISTING
SCALE: 3" = 1'-0"

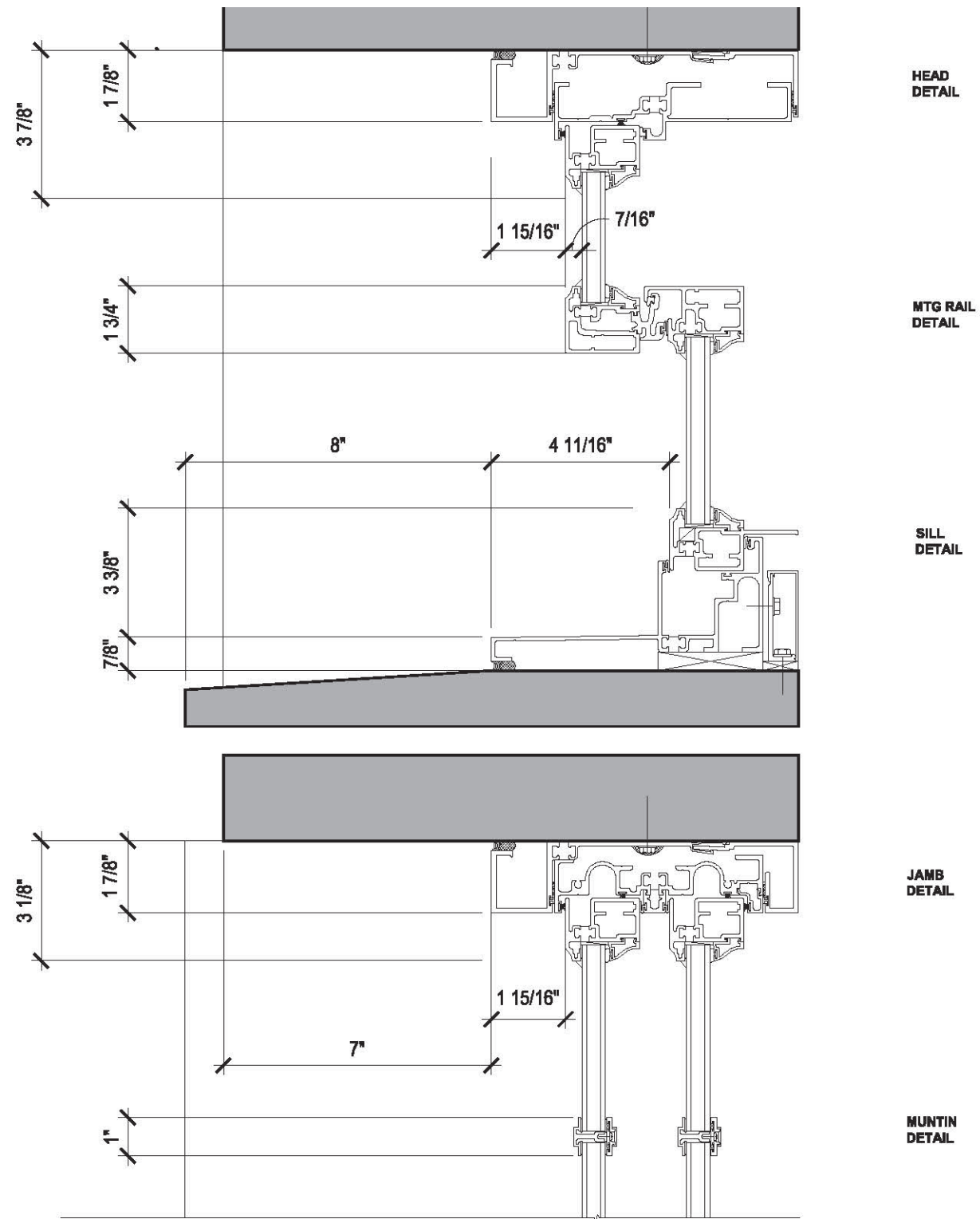

B TYPE B - WINDOW DETAIL - PROPOSED
SCALE: 3" = 1'-0"

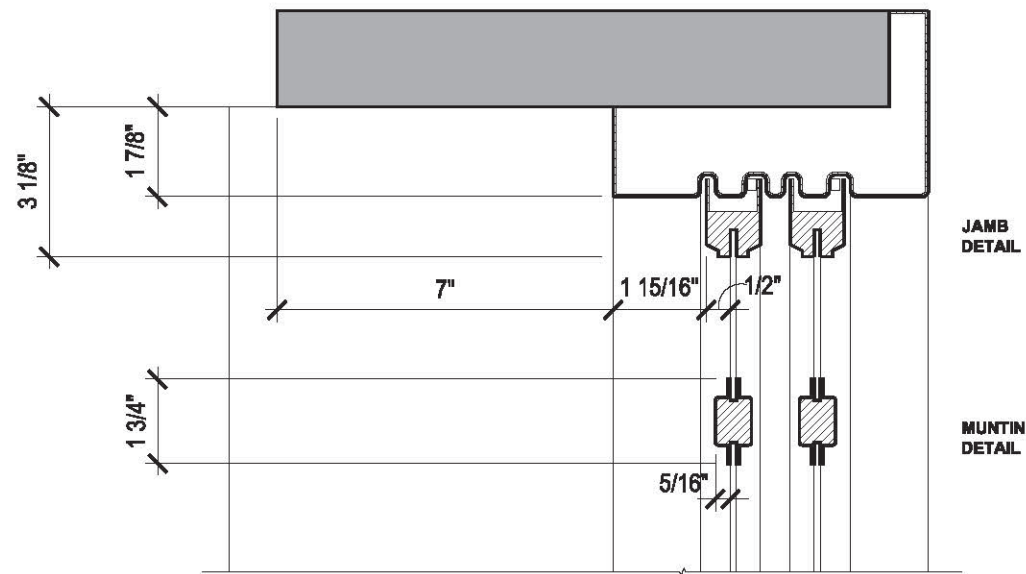
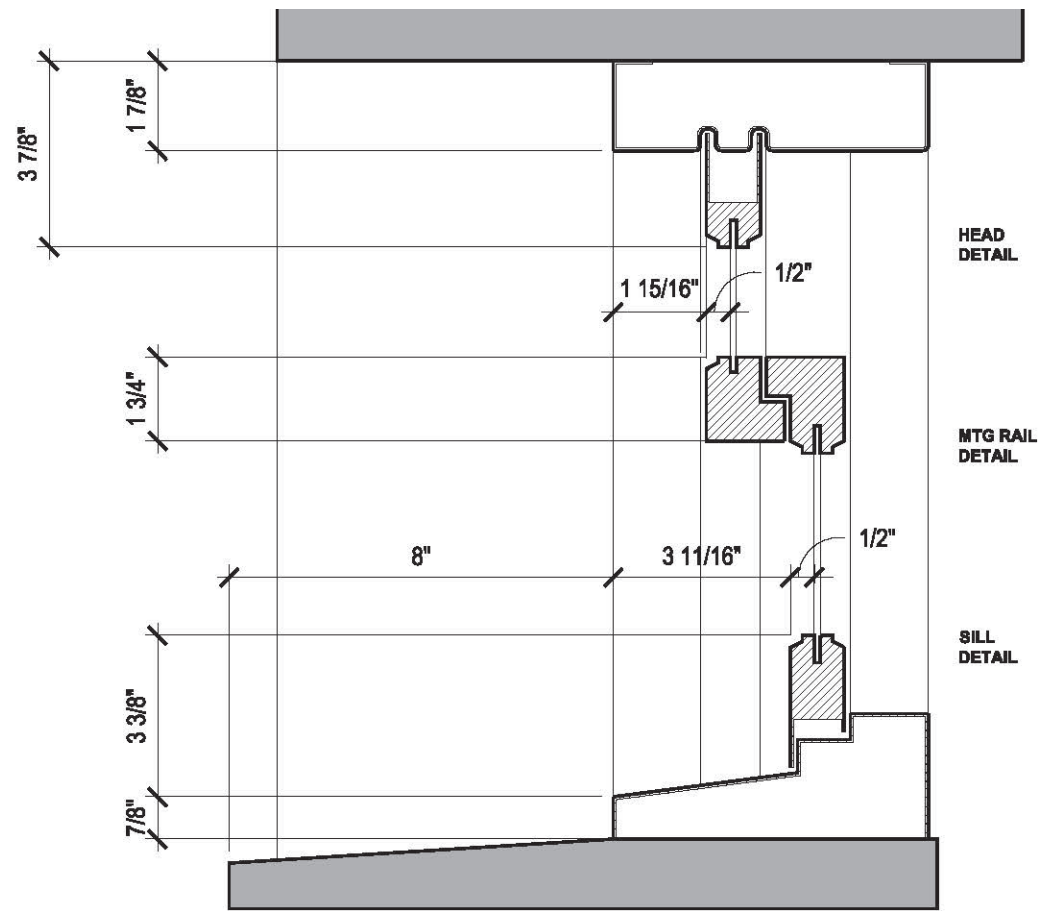

C TYPE C - WINDOW DETAIL - EXISTING
SCALE: 3" = 1'-0"

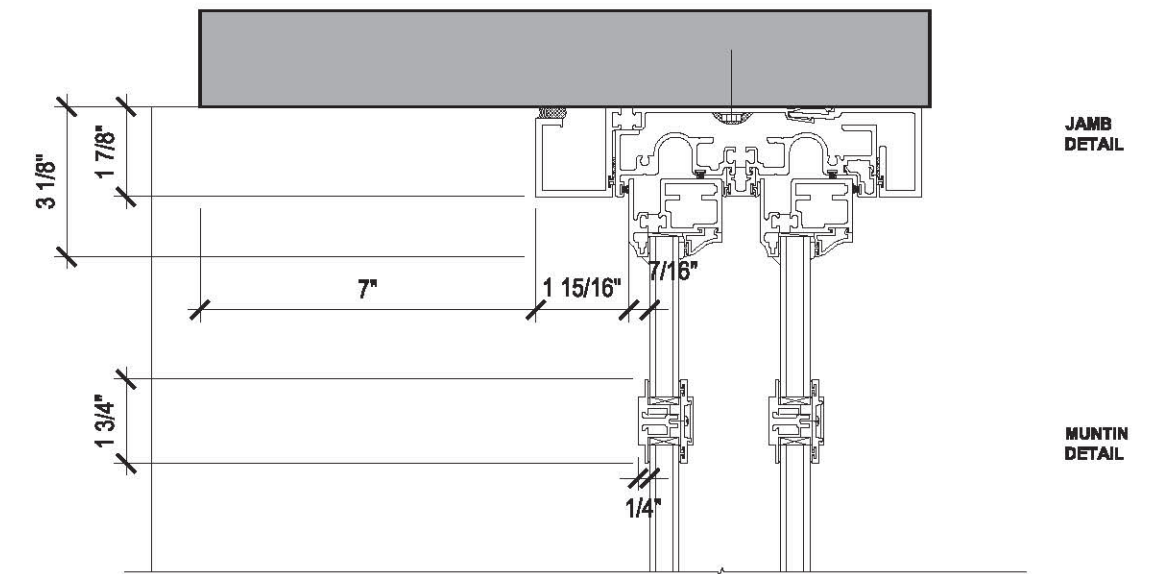
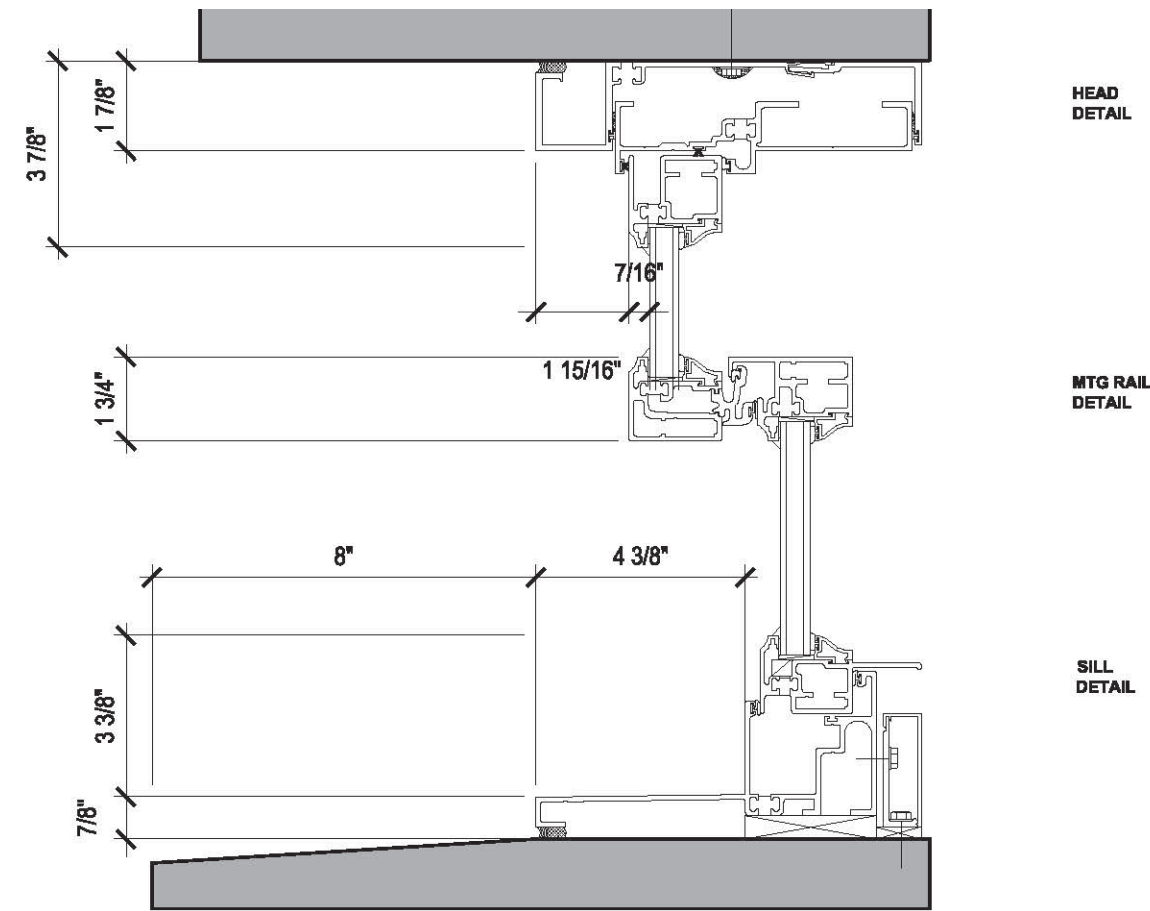

C TYPE C - WINDOW DETAIL - PROPOSED
SCALE: 3" = 1'-0"

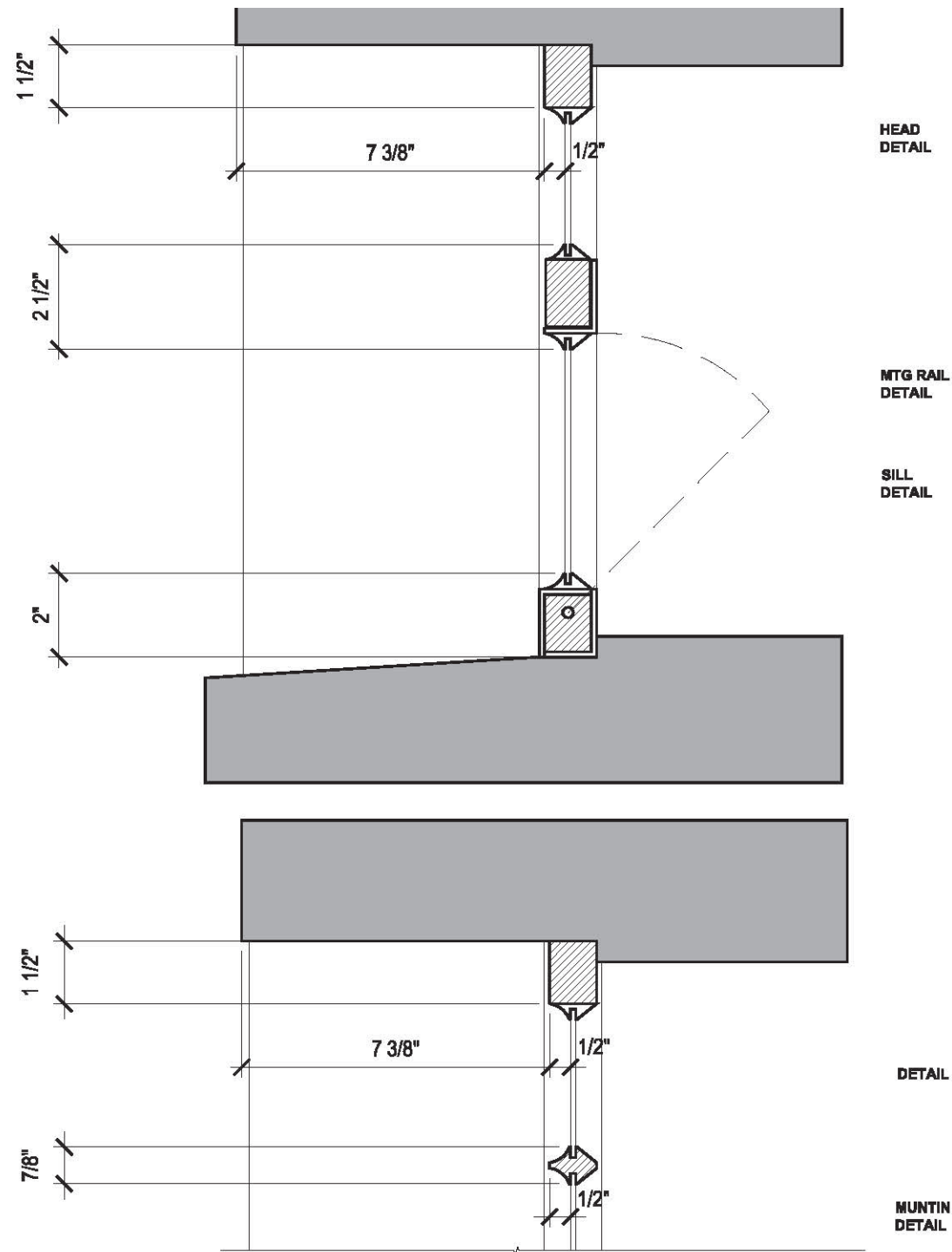

D TYPE D- WINDOW DETAIL - EXISTING
SCALE: 3" = 1'-0"

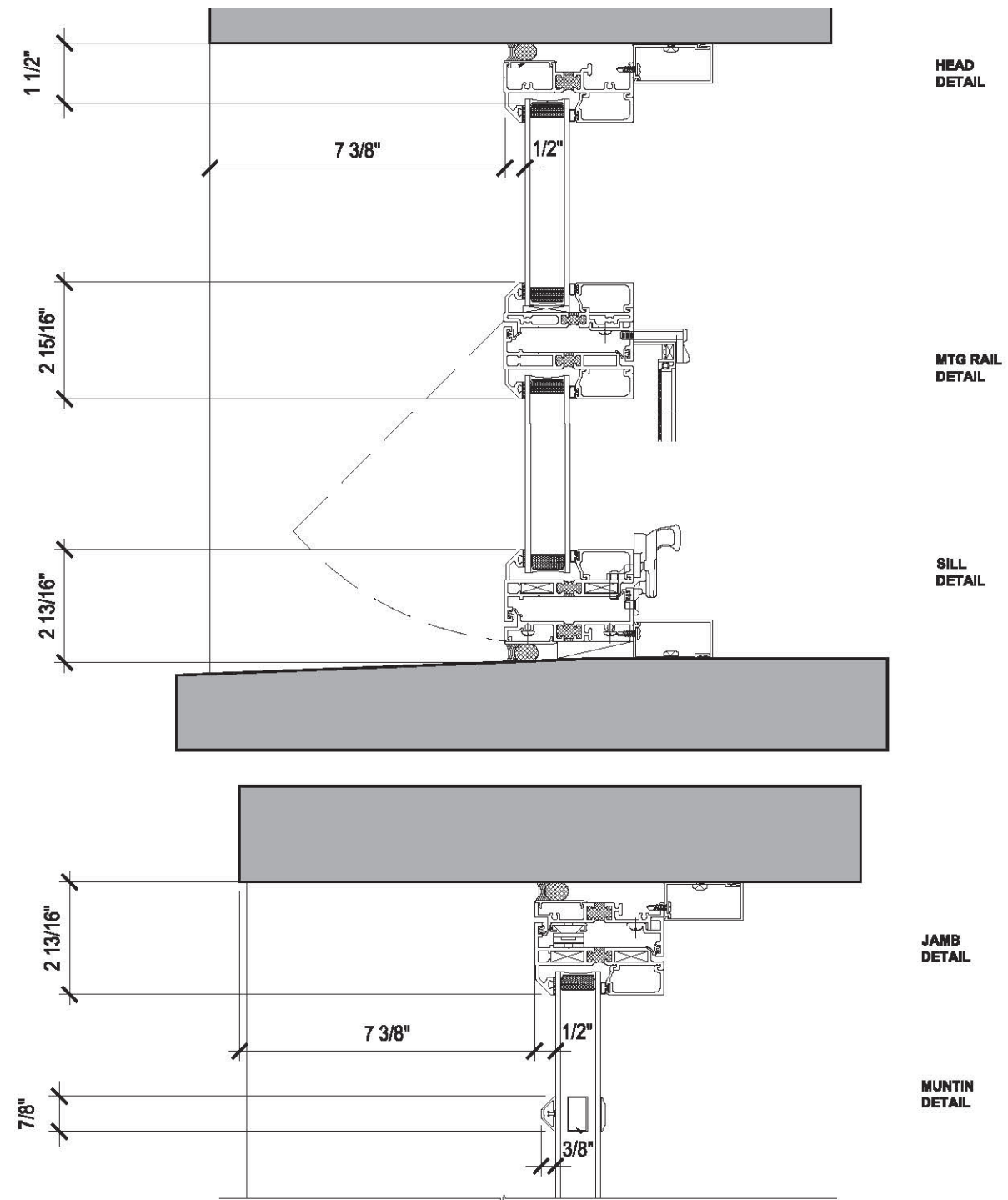

D TYPE D - WINDOW DETAIL - PROPOSED
SCALE: 3" = 1'-0"



Temple Street Elevation



Alley (North) Elevation



Ridgeway Lane Elevation

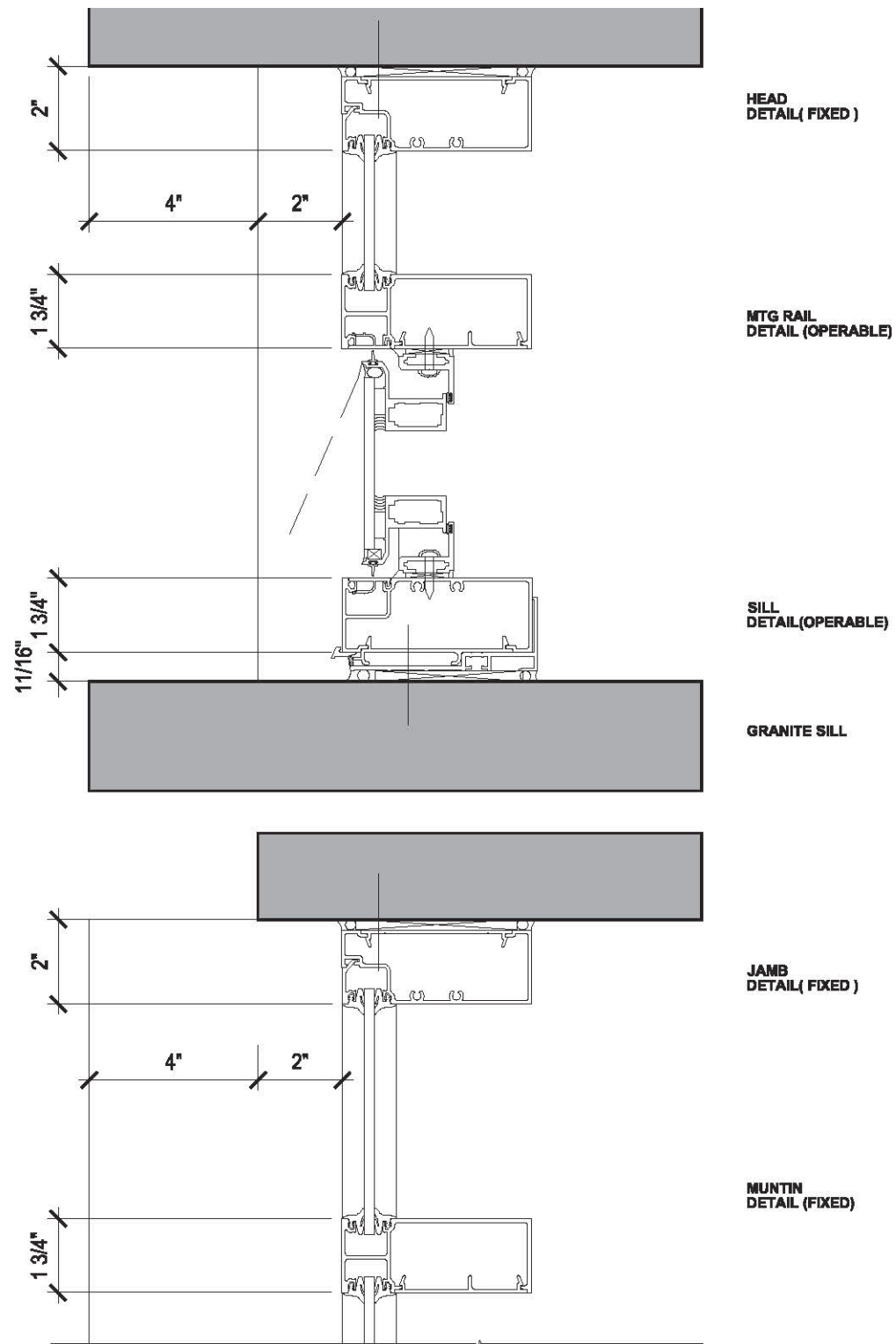

E TYPE E - WINDOW DETAIL - PROPOSED
SCALE: 3" = 1'-0"

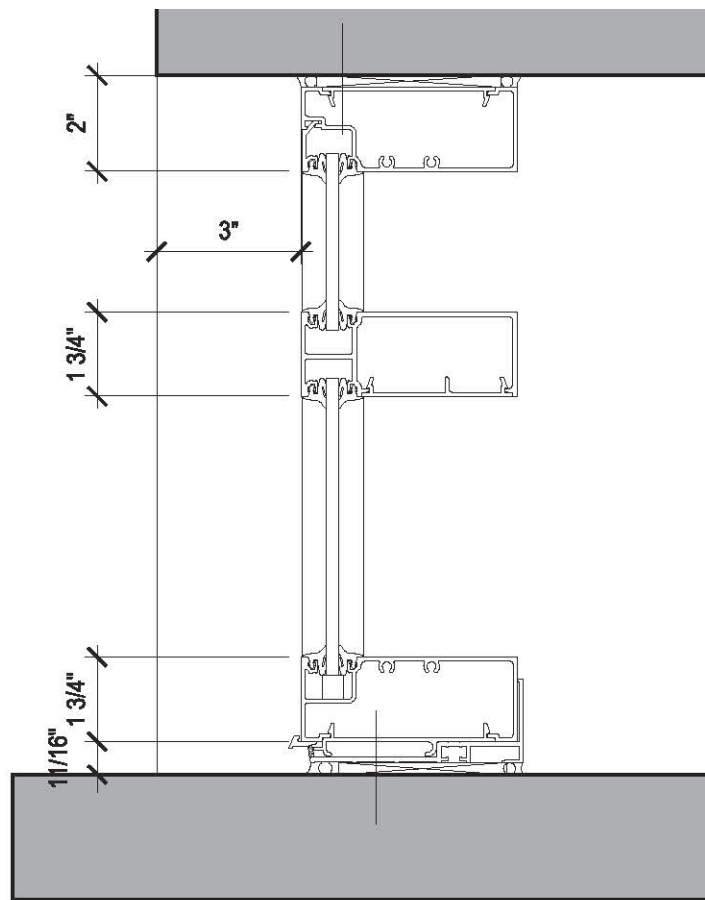

HEAD
DETAIL (FIXED)

MTG RAIL
DETAIL (FIXED)

SILL
DETAIL (FIXED)

GRANITE SILL

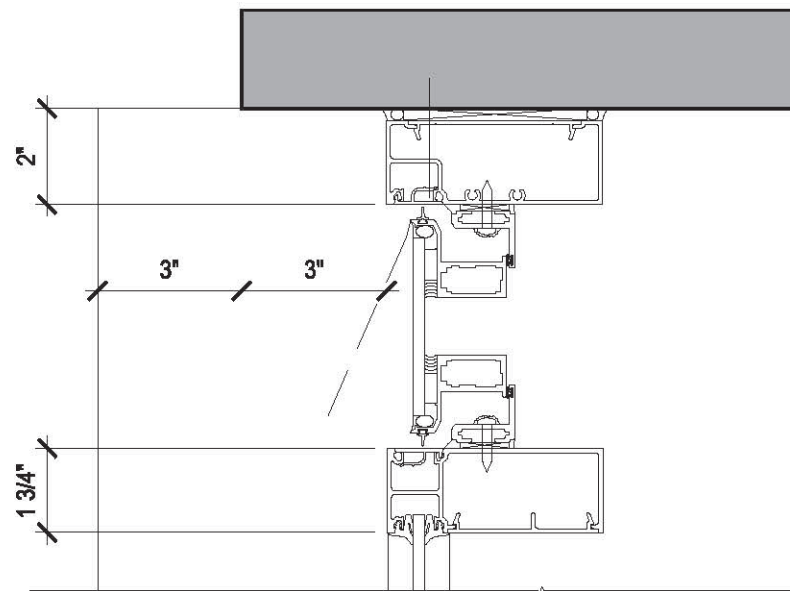

JAMB
DETAIL (OPERABLE)

MUNTIN
DETAIL (OPERABLE)

F TYPE F - WINDOW DETAIL - PROPOSED
SCALE: 3" = 1'-0"

Proviso 4: That a final lighting plan be submitted,
including for the Ridgeway Lane facade.

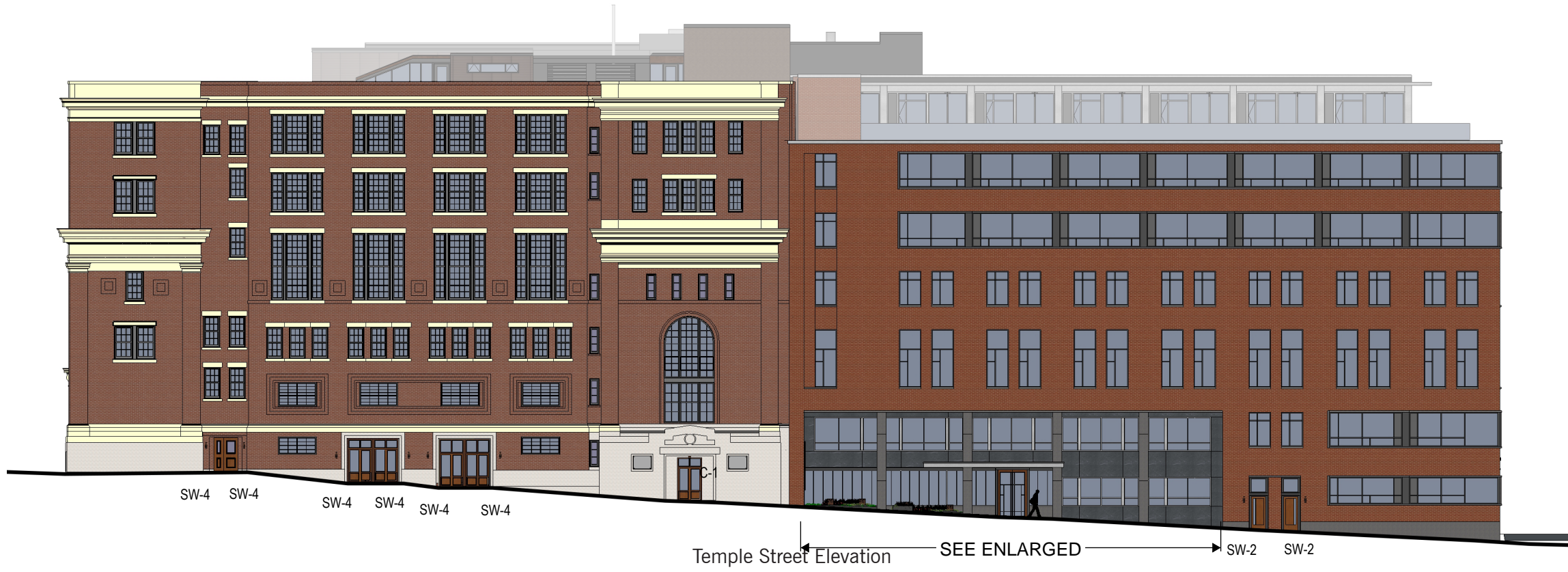

SW-2
TROY LIGHTING
ETHOS LED OUTDOOR WALL SCONCE
 4.5"W X 15"H



SW-3
MODERN FORMS- PANDORA 9
LED
 9"W X 9"H



SW-4
CRENSHAW- CUSTOM BRACKET SCONCE
LED
 6" Dia. Shade X 13"H



C-1
HUBBARDTON FORGE
TWILIGHT OUTDOOR SEMI-FLUSH
 6"W X 4.9"H



CAM
SECURITY CAMERA
TEKA ILLUMINATION
 SURFACE MOUNTED OBSERVATORY

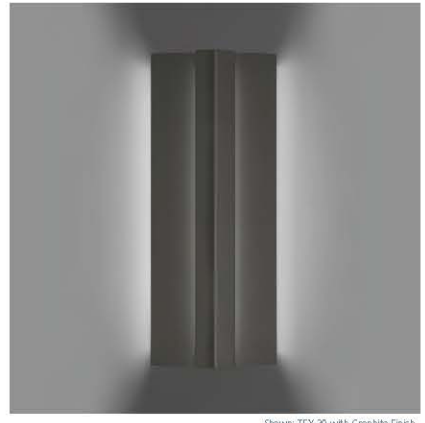

Shown: TEX 30 with Graphite Finish



EOB - Enviro Oil-Rubbed Bronze (Powder Coat)

SW-1
ALVA TEX LED
 2X 60"L x 12"W x 4"D



SG-1
B. LUX AMS OUTDOOR (CORTEN STEEL)
 15 3/4" X 15 3/4" X 15 3/4"

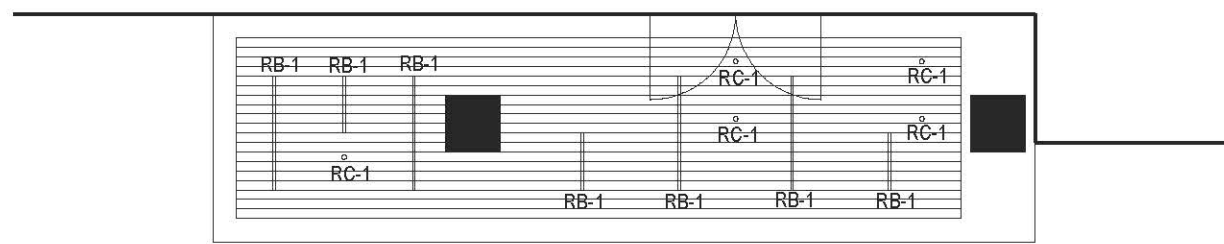

Canopy Reflected Ceiling Plan



Plexineon White 1X Series

PRODUCT SUMMARY



- PRODUCT FEATURES**
- Four Kelvin temperatures
 - Energy efficient
 - Long lifetime
 - Stable and consistent color temperature
 - Low voltage
 - Easy to install
 - Cool to the touch
 - For use as exterior or interior accent lighting, direct view or indirect view applications, coves & more

RB-1
PLEXINEON WHITE LED
 48"L x 1/2"W
 24"L X 1/2"W



2" LED Downlight
 Open & Wall Wash
D2LED
 120V or 277V
 High Output

DATE: _____ TYPE: _____
 FIRM NAME: _____
 PROJECT: _____



RC-1
ARCHITEKTUR LED DOWN LIGHT
 3" DIAMETER



Ridgeway Lane Elevation



Derne Street Elevation



SW-3
MODERN FORMS- PANDORA 9
LED
 9"W X 9"H



CAM
SECURITY CAMERA
TEKA ILLUMINATION
 SURFACE MOUNTED OBSERVATORY



RC-1
ARCHITEKTUR LED DOWN LIGHT
 3" DIAMETER

2" LED Downlight
 Open & Wall Wash
D2LED
 120V or 277V
 High Output

DATE: _____ TYPE: _____
 FIRM NAME: _____
 PROJECT: _____

Architektar
 Ceiling Cutout: 2 3/4"
 Ceiling Thickness: 1/2" - 1 1/4"
 For conversion to millimeters,
 multiply inches by 25.4

Proviso 5: That detailed drawings for the replacement doors and transoms including cutsheets for the hardware be submitted.



EXISTING DOOR PHOTO



EXISTING DOOR PHOTO



EXISTING DOOR PHOTO



EXISTING DOOR PHOTO

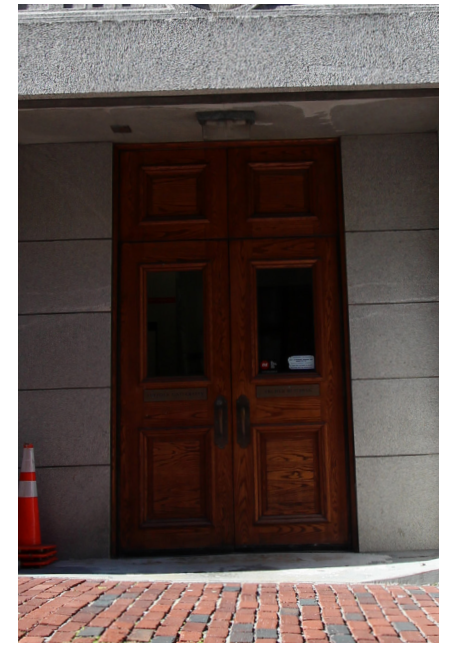

EXISTING DOOR PHOTO

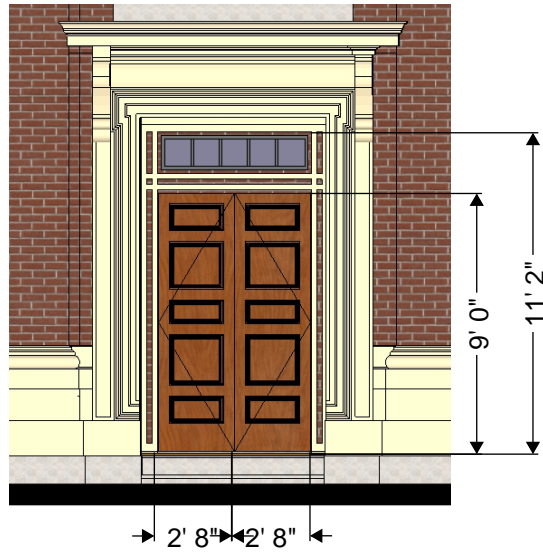

UNIT ENTRY
(2) 2' 8" X 0' X 1 3/4" STAINED MAHOGANY DOORS

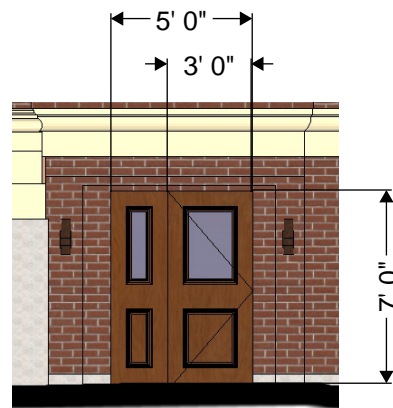

STAIR EGRESS
3' X 7' X 1 3/4" STAINED MAHOGANY DOOR

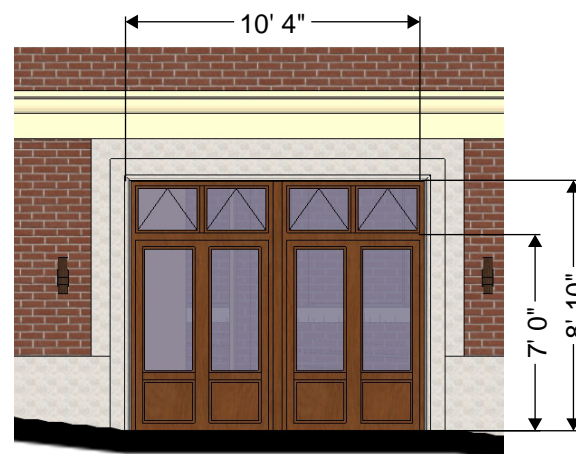

UNIT WINDOWS
STAINED MAHOGANY FIXED DOOR AND OPERABLE TRANSOM WINDOWS

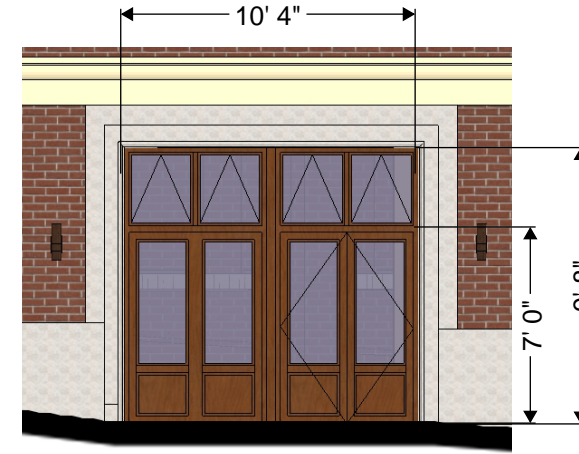

UNIT ENTRY AND SIDELIGHTS
2' 8" X 7' STAINED MAHOGANY DOOR, SIDELIGHTS, AND OPERABLE TRANSOM WINDOWS

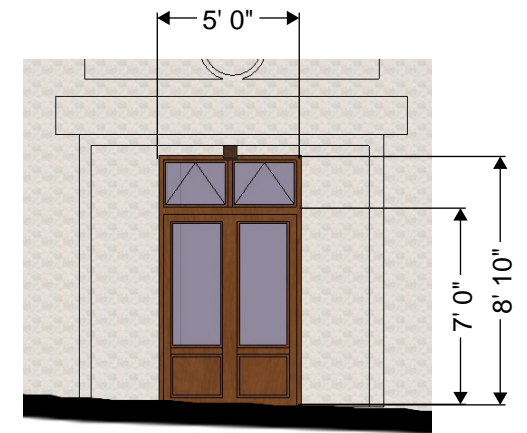

AMENITY WINDOWS
STAINED MAHOGANY FIXED DOOR AND OPERABLE TRANSOM WINDOWS



Baldwin- Tremont Entrance Trim
Oil Rubbed Bronze finish
17" x 3 3/8" x 2 1/2" projection



Baldwin- Tremont Entrance Trim
Oil Rubbed Bronze finish
17" x 3 3/8" x 2 1/2" projection



Baldwin- Tremont Entrance Trim
Oil Rubbed Bronze finish
17" x 3 3/8" x 2 1/2" projection



MAIN ENTRY
 (2) 3' X 10' X 1 3/4" STAINED
 MAHOGANY AND STEEL DOOR

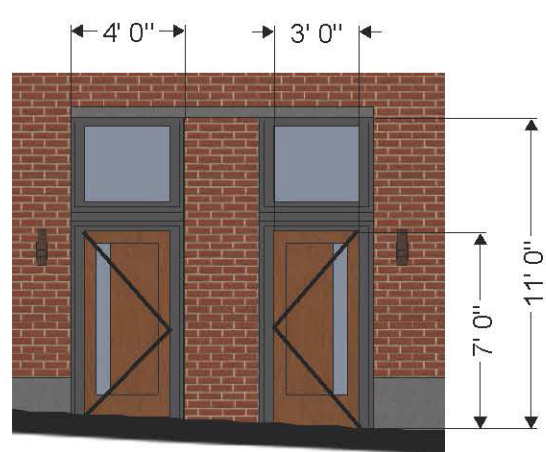

UNIT ENTRY
 3' X 7' X 1 3/4" STAINED
 MAHOGANY DOOR

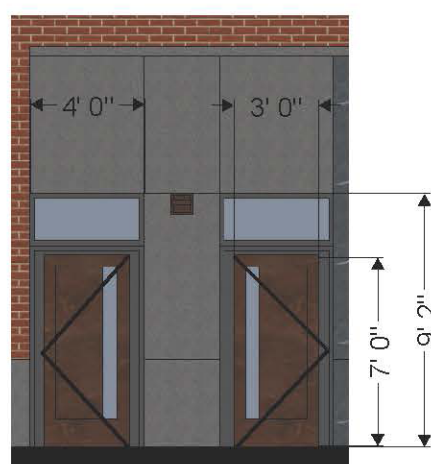

SECONDARY ENTRY
 3' X 7' X 1 3/4" BRASS DOOR
 WITH BRONZE FINISH

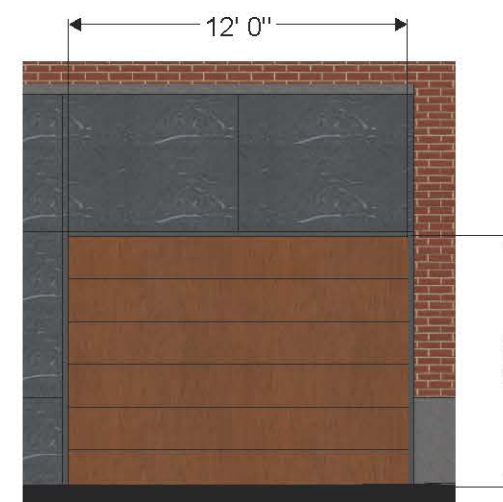

GARAGE
 12' X 9' OVERHEAD DOOR
 STAINED MAHOGANY



STAIR EGRESS
 3' X 6' 8" X 1 3/4" PAINTED
 STEEL

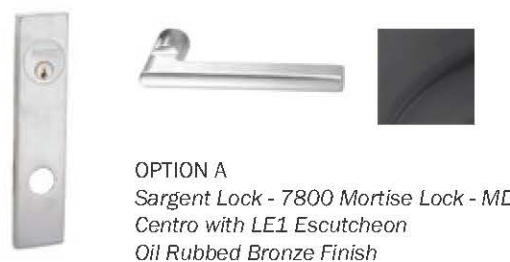

Proviso 6: That the materials be restudied,
including the number of materials and finishes.

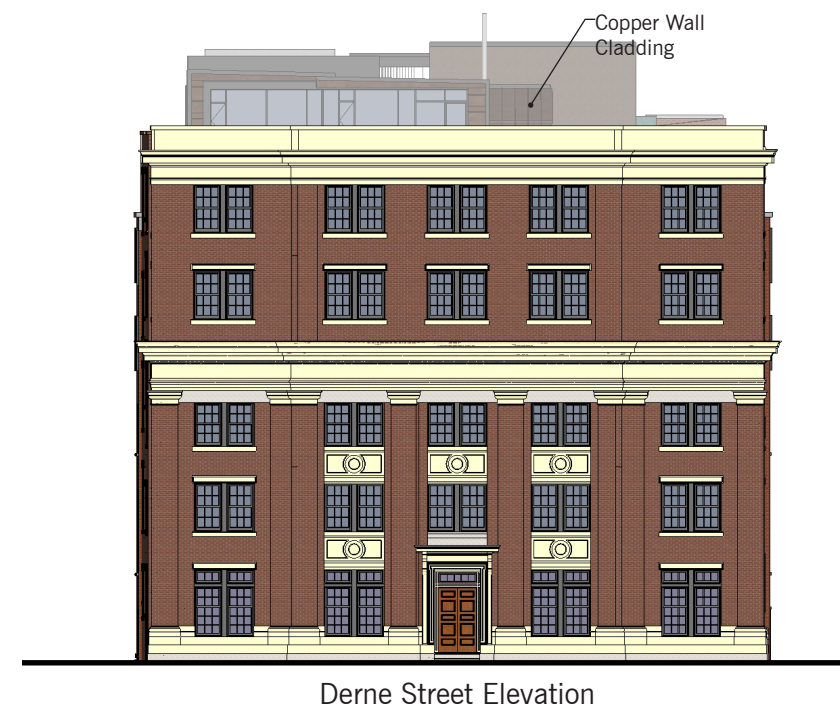
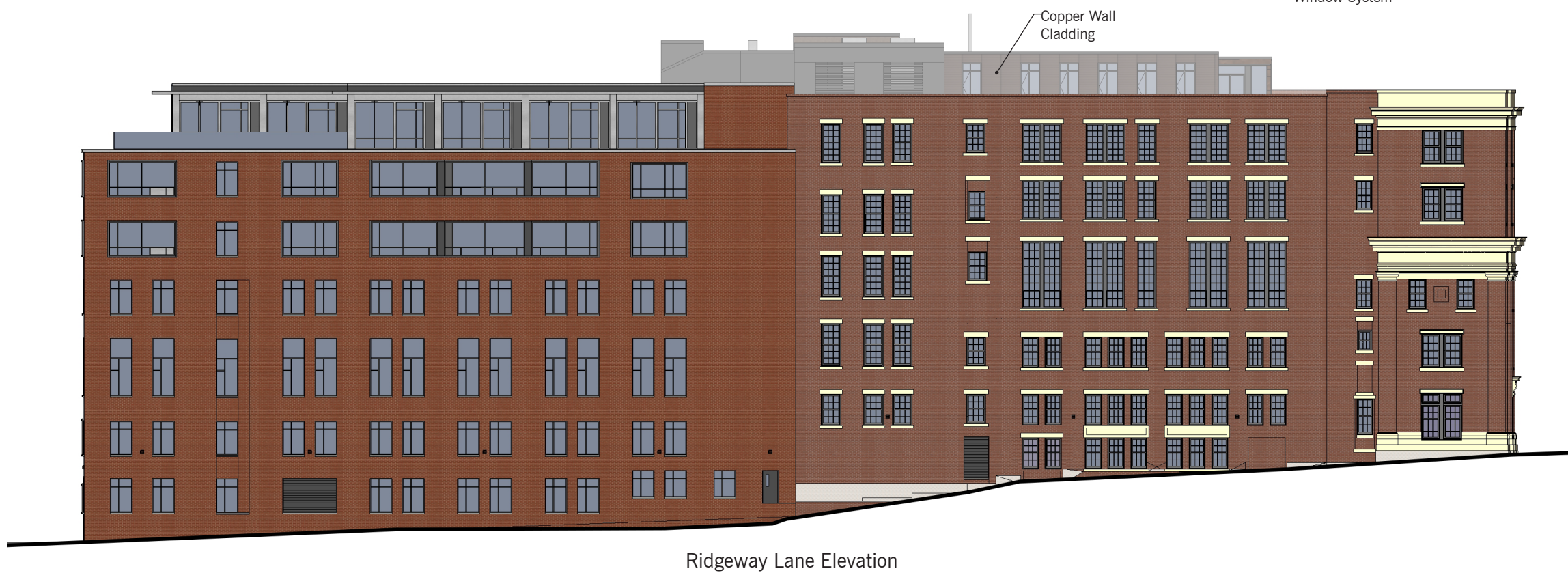
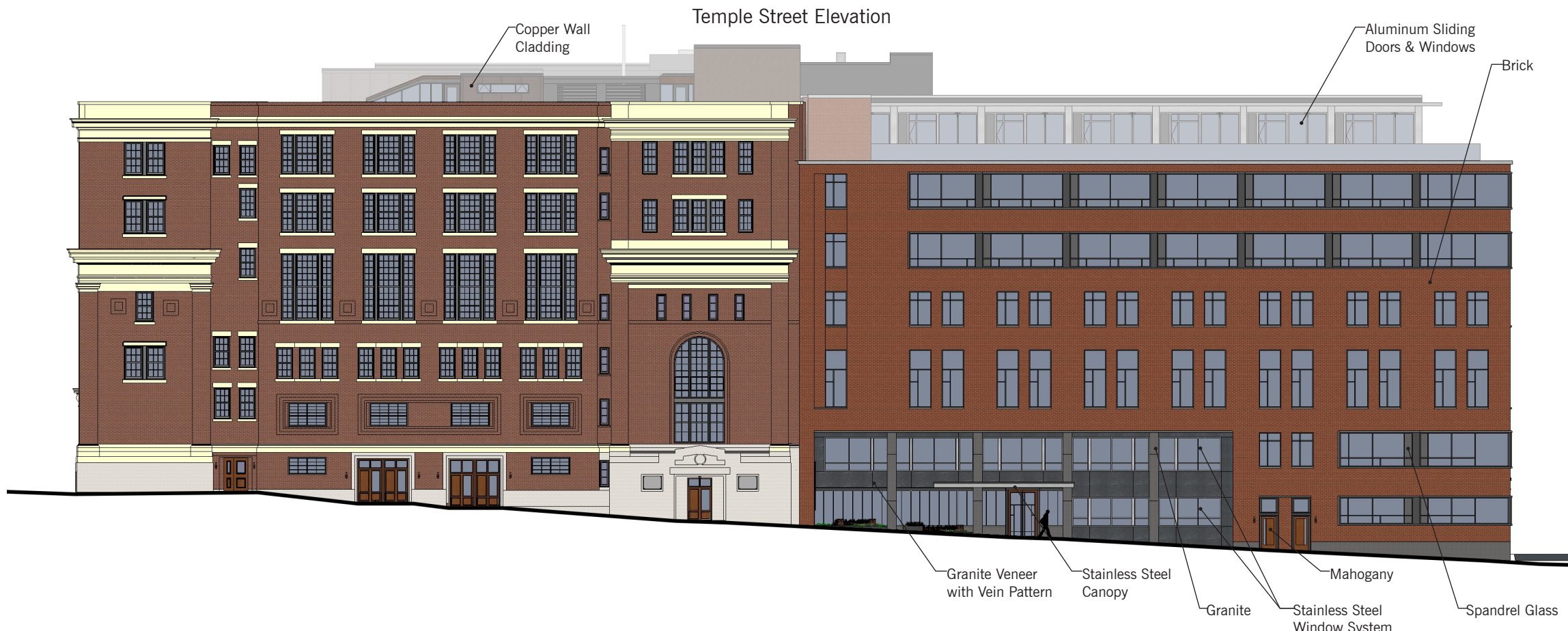

Proviso 7: That the configuration of the infill at the entrances on the passageway (North) Facade be restudied.



Granite

Light Fixture

Brass Door
w/ Bronze Finish

Mahogany Overhead Door

Granite Veneer
with Vein Pattern

Proviso 8: And that the shape, size and materials of the planters at the passageway be restudied.

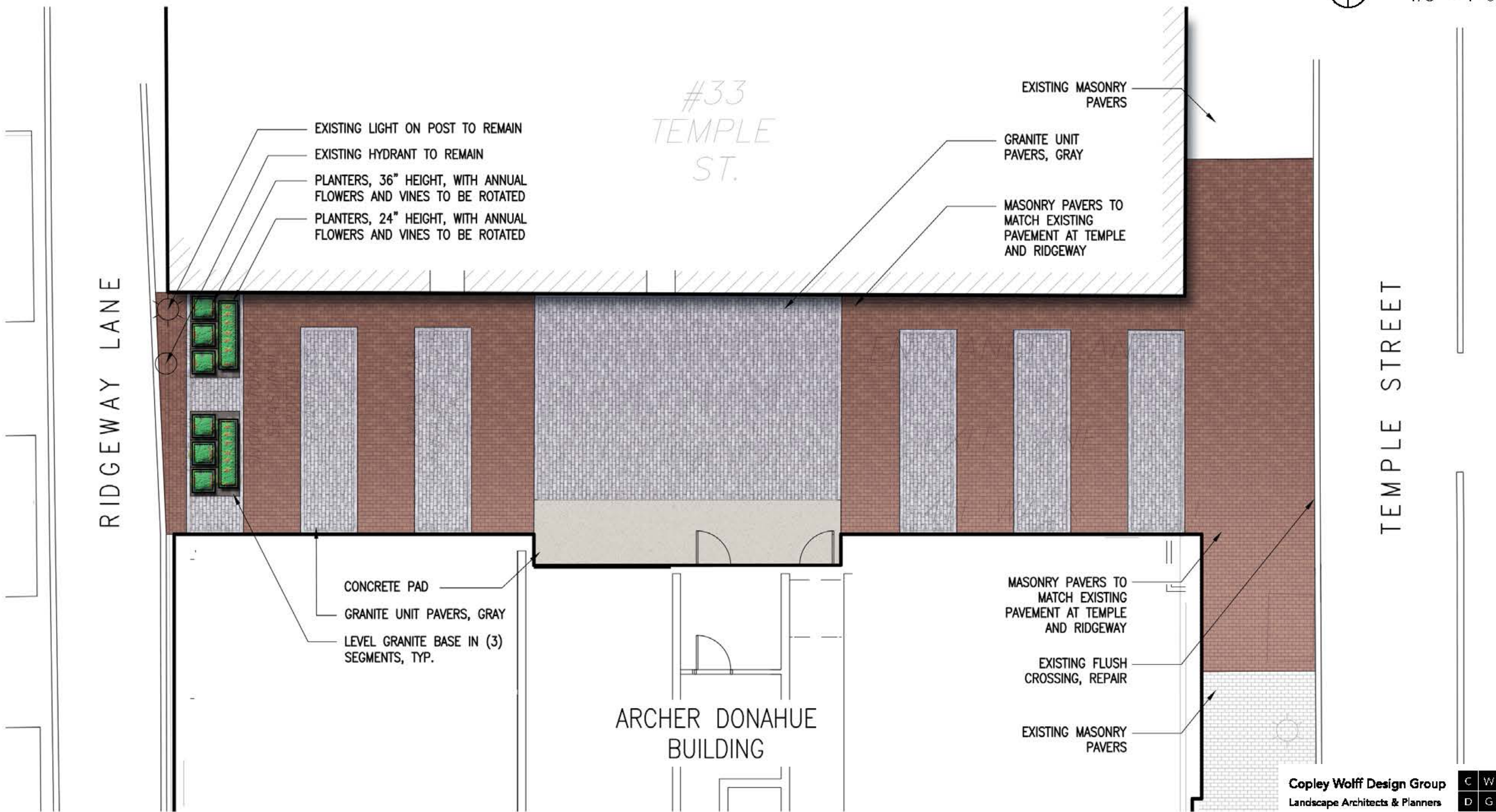

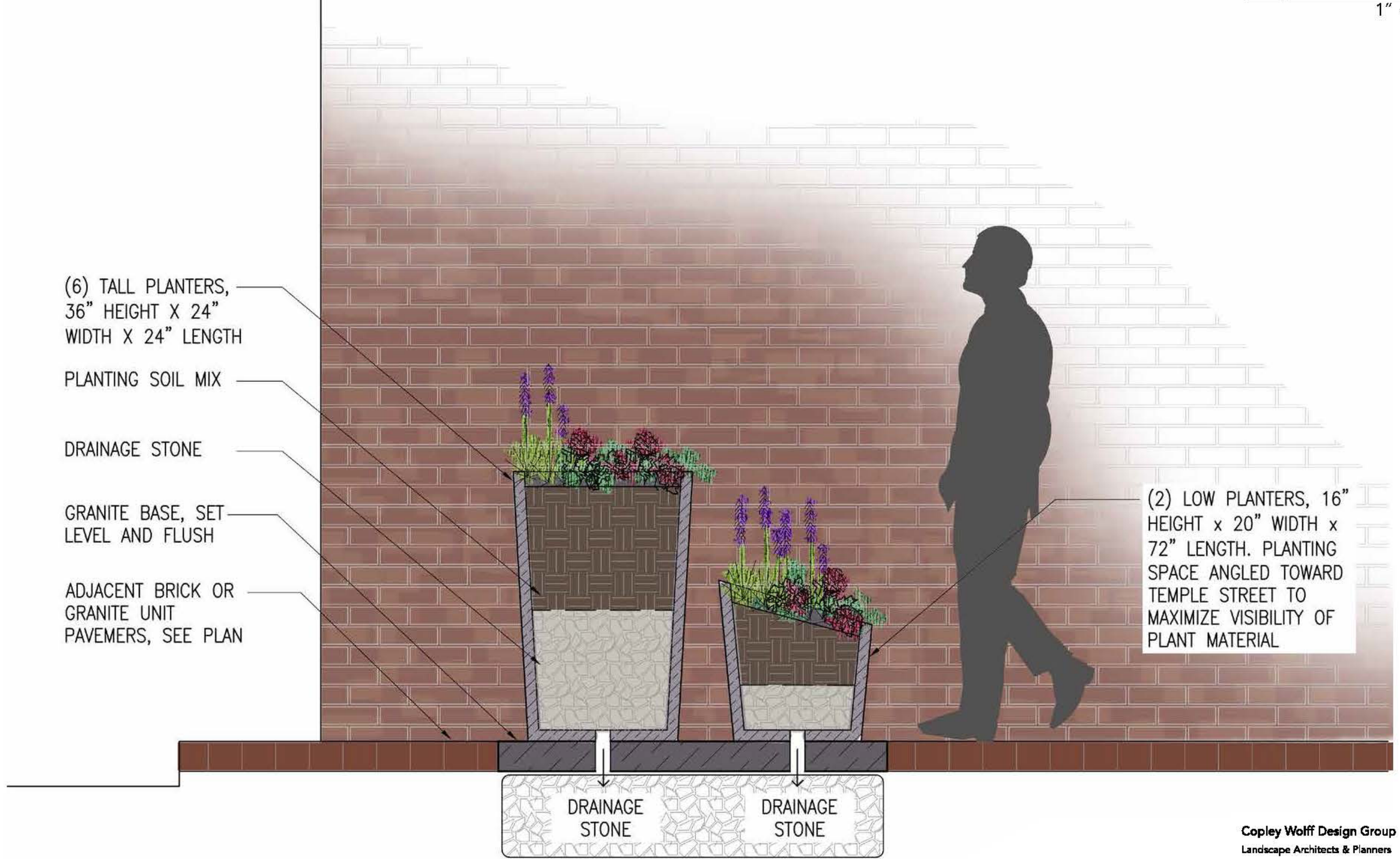

(6) TALL PLANTERS,
36" HEIGHT X 24"
WIDTH X 24" LENGTH

PLANTING SOIL MIX

DRAINAGE STONE

GRANITE BASE, SET
LEVEL AND FLUSH

ADJACENT BRICK OR
GRANITE UNIT
PAVEMERS, SEE PLAN

(2) LOW PLANTERS, 16"
HEIGHT x 20" WIDTH x
72" LENGTH. PLANTING
SPACE ANGLED TOWARD
TEMPLE STREET TO
MAXIMIZE VISIBILITY OF
PLANT MATERIAL

DRAINAGE
STONE

DRAINAGE
STONE

Copley Wolff Design Group
Landscape Architects & Planners





planter examples

Copley Wolff Design Group
Landscape Architects & Planners

