

AERIAL VIEW

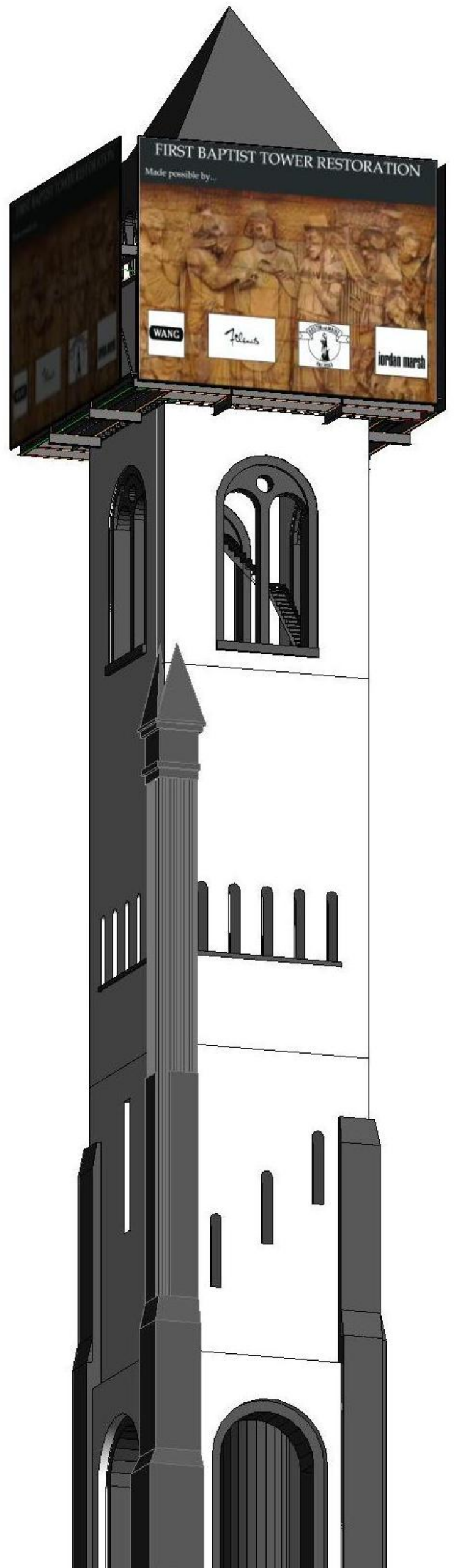

STREET VIEW

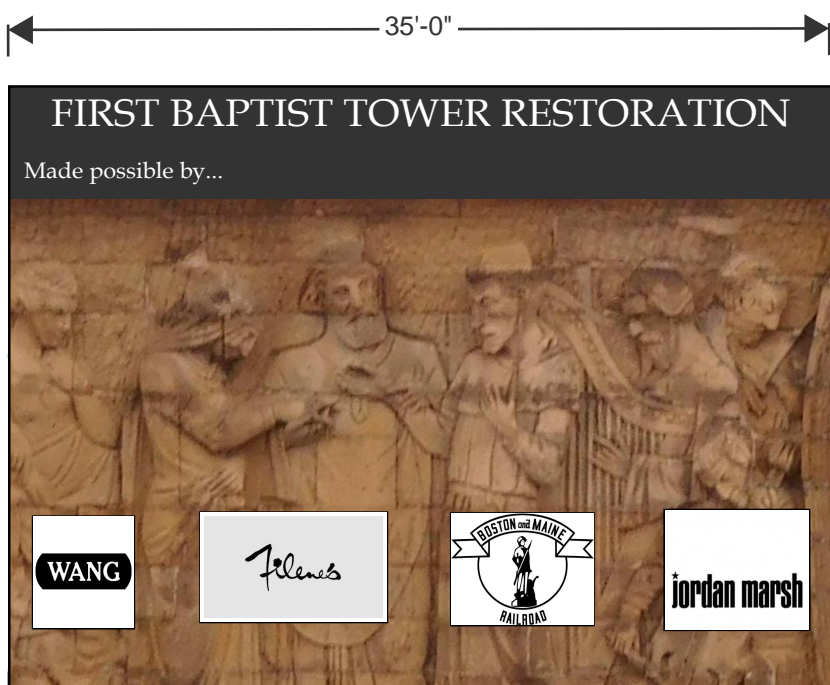

SCRIM CONCEPTUAL DESIGN

PLEASE NOTE that the "sponsors" shown are just for example and are not the actual anticipated sponsors.



SCRIM IN RELATION TO WORKING PLATFORM
(Scrim will actually be on all four sides)

WORKING PLATFORM CROSS-SECTION

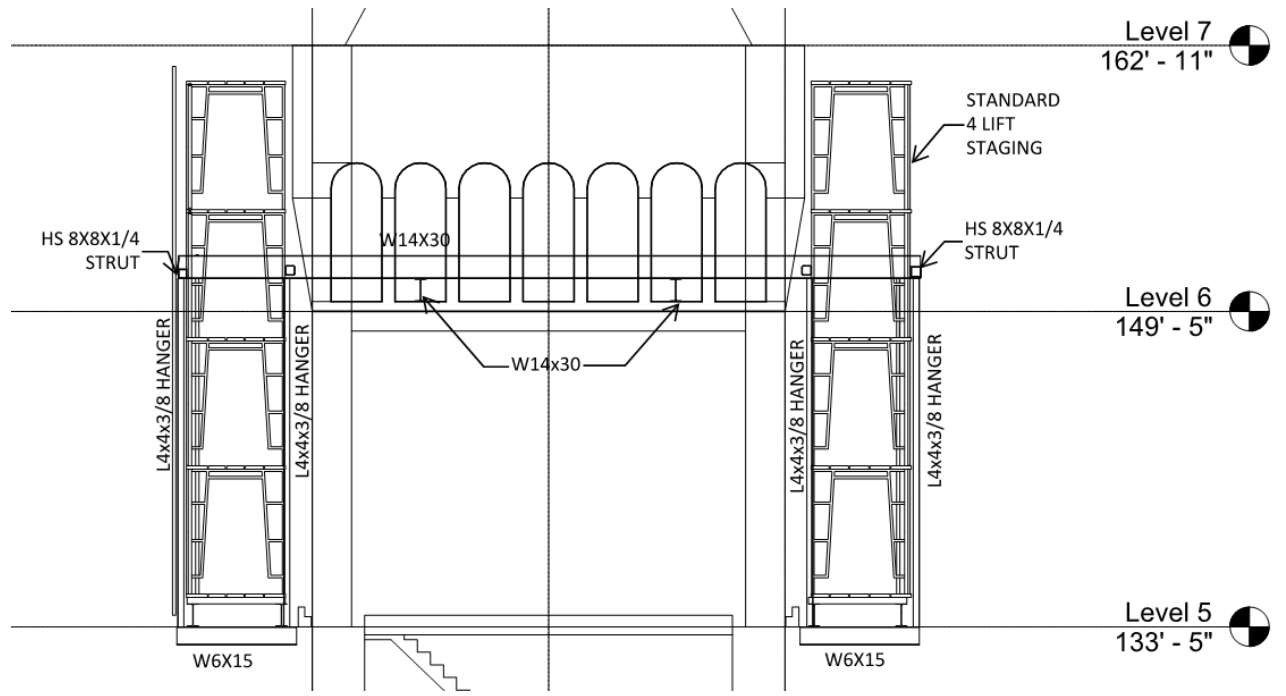

WORKING PLATFORM UPPER PLAN

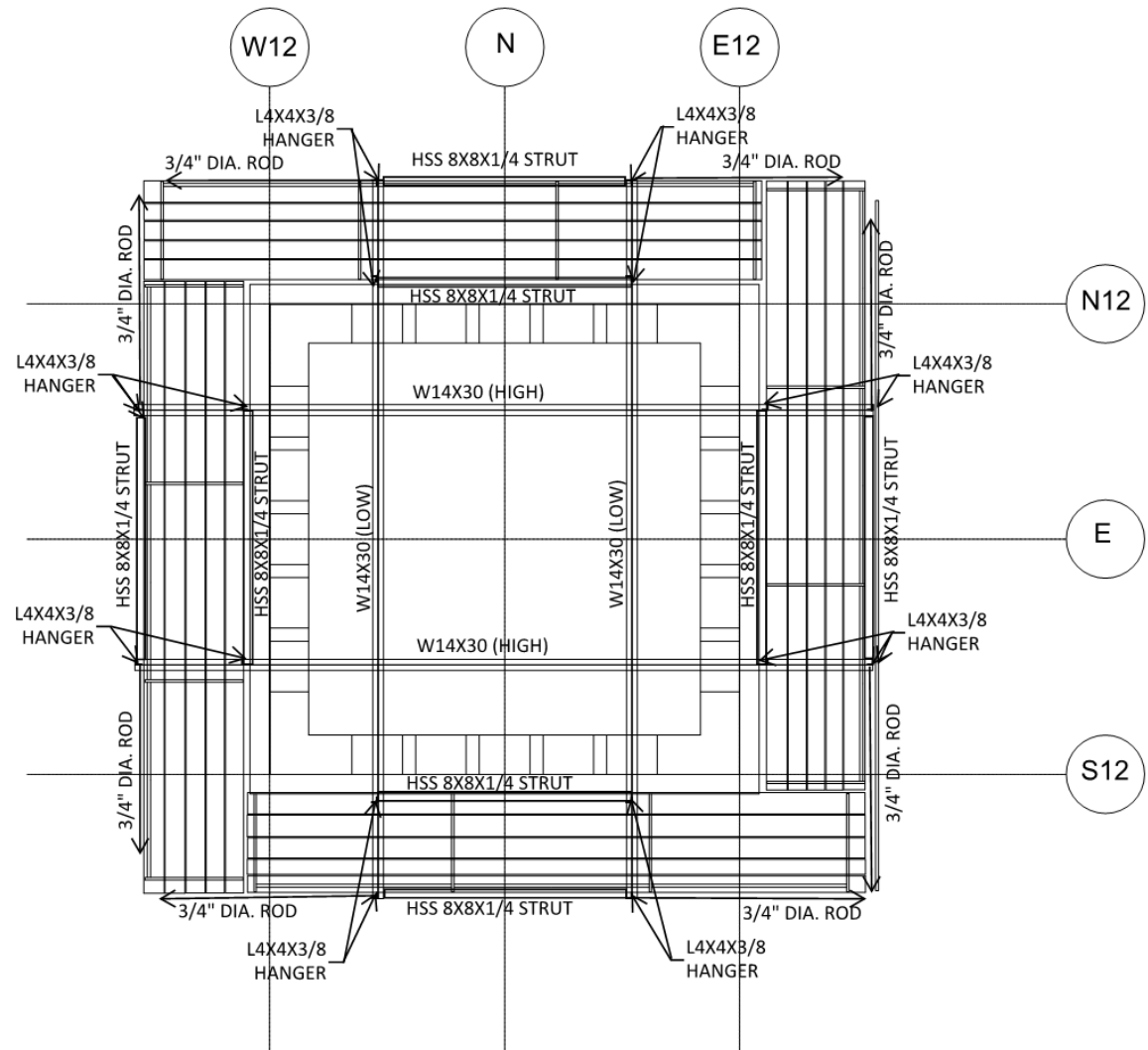

WORKING PLATFORM LOWER PLAN

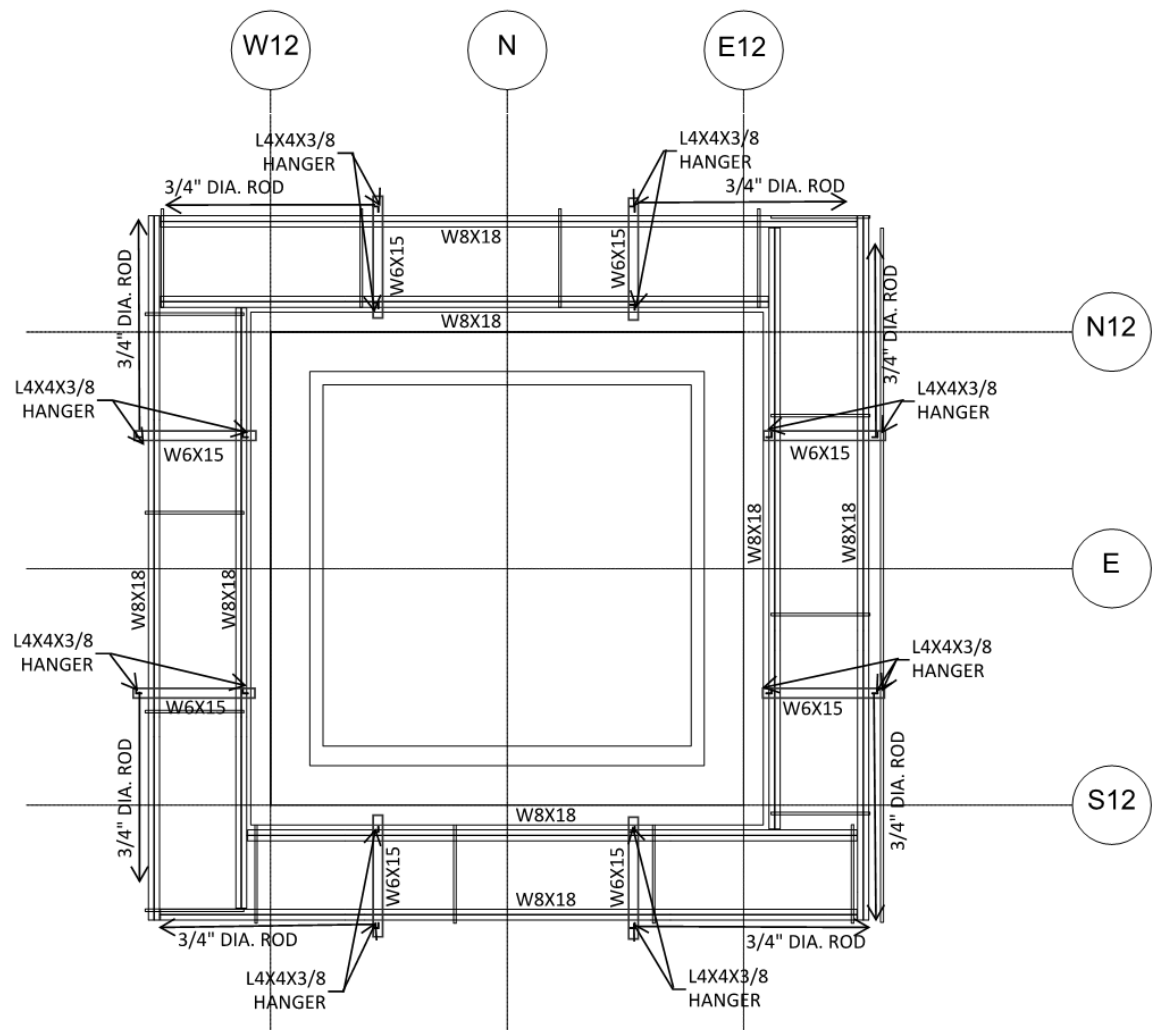



PART 1
EMERGENCY REPAIRS
FIRST BAPTIST CHURCH
BOSTON, MA

OWNER:
FIRST BAPTIST CHURCH OF BOSTON
110 COMMONWEALTH AVENUE
BOSTON, MA 02116

ENGINEER:
STRUCTURES NORTH CONSULTING ENGINEERS, INC.
60 WASHINGTON STREET
SALEM, MA 01970
978-745-6817

UPDATED:
3-1-17

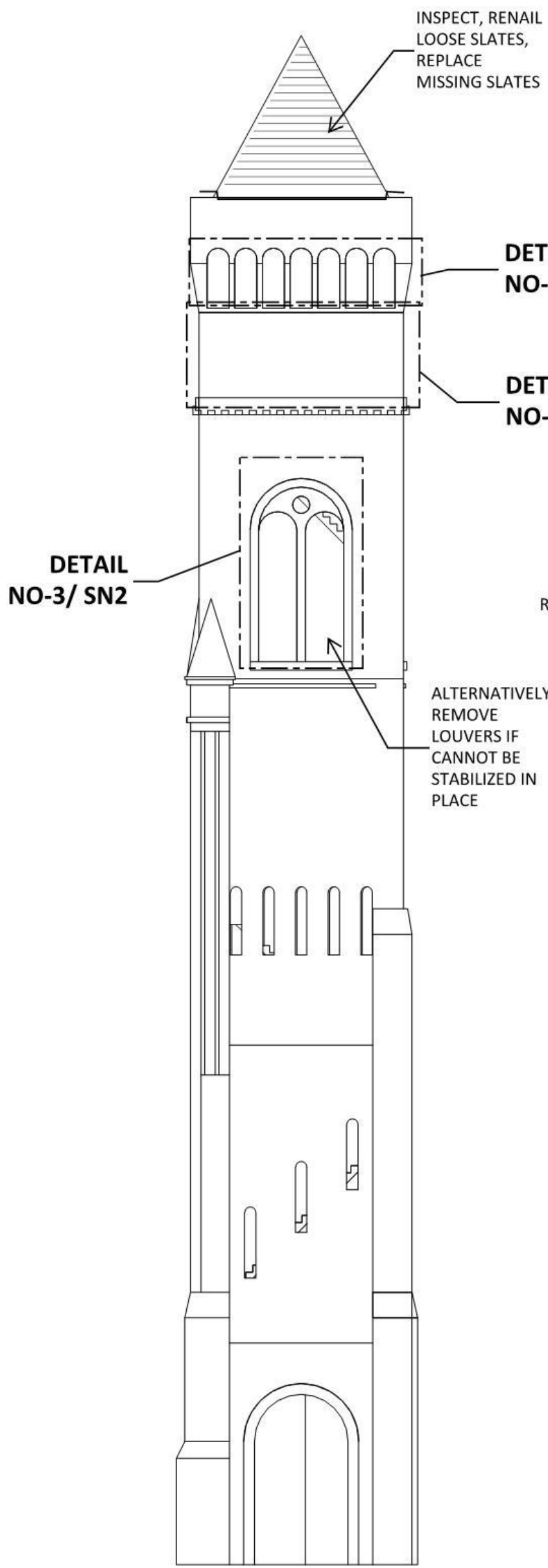

NORTH ELEVATION/ EXTERIOR

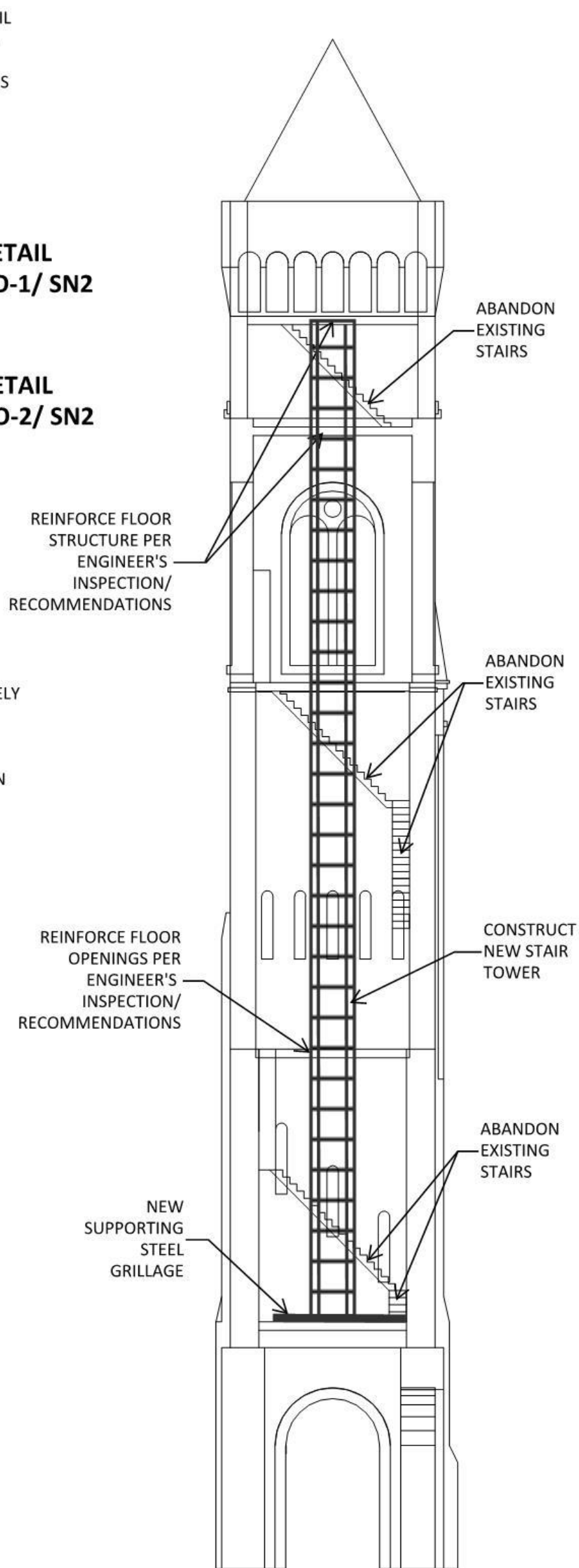

NORTH ELEVATION/ INTERIOR

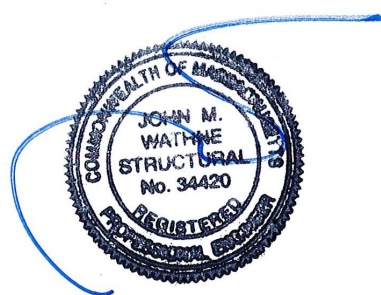

<p>EMERGENCY REPAIRS FIRST BAPTIST CHURCH 110 COMMONWEALTH AVENUE, BOSTON, MA</p>	 STRUCTURES NORTH CONSULTING ENGINEERS, INC. 60 WASHINGTON ST. SALEM, MA JMW/ SA/ 3-1-17	<p>SN1 ELEVATIONS</p>
---	---	--

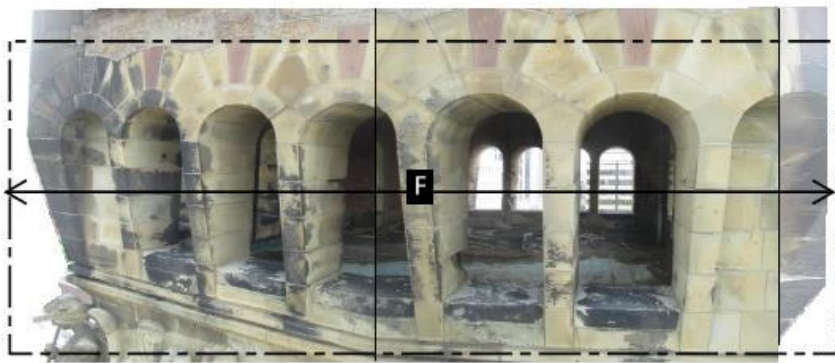

DETAIL NO-1



DETAIL NO-2



DETAIL NO-3

KEYED NOTES

- A** REMOVE LOOSE STONE SPALL- NEAR SIDE, (f)= FAR SIDE.
- B** REMOVE LOOSE MORTAR OR FLAKING STONE.
- C** PRESS BACKER-ROD INTO OPEN CRACKS AND JOINTS.
- D** INSTALL STAINLESS STEEL HARDWARE CLOTH STRETCHED TIGHTLY OVER LOOSE OR CRACKED STONE.
- E** LOOP HARDWARE CLOTH AROUND 2X4 P/T WOODEN BATTEN AND, PULL TIGHTLY AND FASTEN TO MASONRY- NEAR SIDE, (f)= FAR SIDE.
- F** VISUALLY INSPECT AND HAMMER TAP EXISTING STONework, REMOVE ALL LOOSE FRAGMENTS AND SPALLS.
- G** INSTALL WOODEN CIPPLES AND BRACES TO SUPPORT SLIDING LOUVER FINS.
- H** INSPECT LOUVER FINS, REMOVE IF ROTTED BEYOND REPAIR INSTEAD OF SUPPORTING AND BRACING THEM.
- I** REMOVE FAILED LOUVER DEBRIS.
- J** REMOVE ROTTED SOFFIT OF RAFTER TAIL, REINFORCE WITH NEW 2X8 SISTERS AT EACH SIDE.

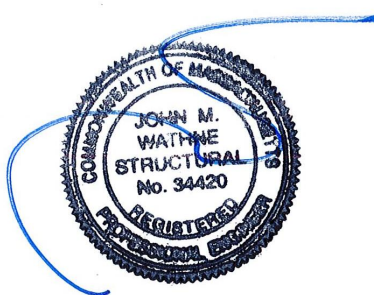

<p>EMERGENCY REPAIRS FIRST BAPTIST CHURCH 110 COMMONWEALTH AVENUE, BOSTON, MA</p>	 <p>STRUCTURES NORTH CONSULTING ENGINEERS, INC 60 WASHINGTON ST. SALEM, MA JMW/ SA/ 1-6-17</p>	<p>SN2 DETAILS</p>
---	---	--

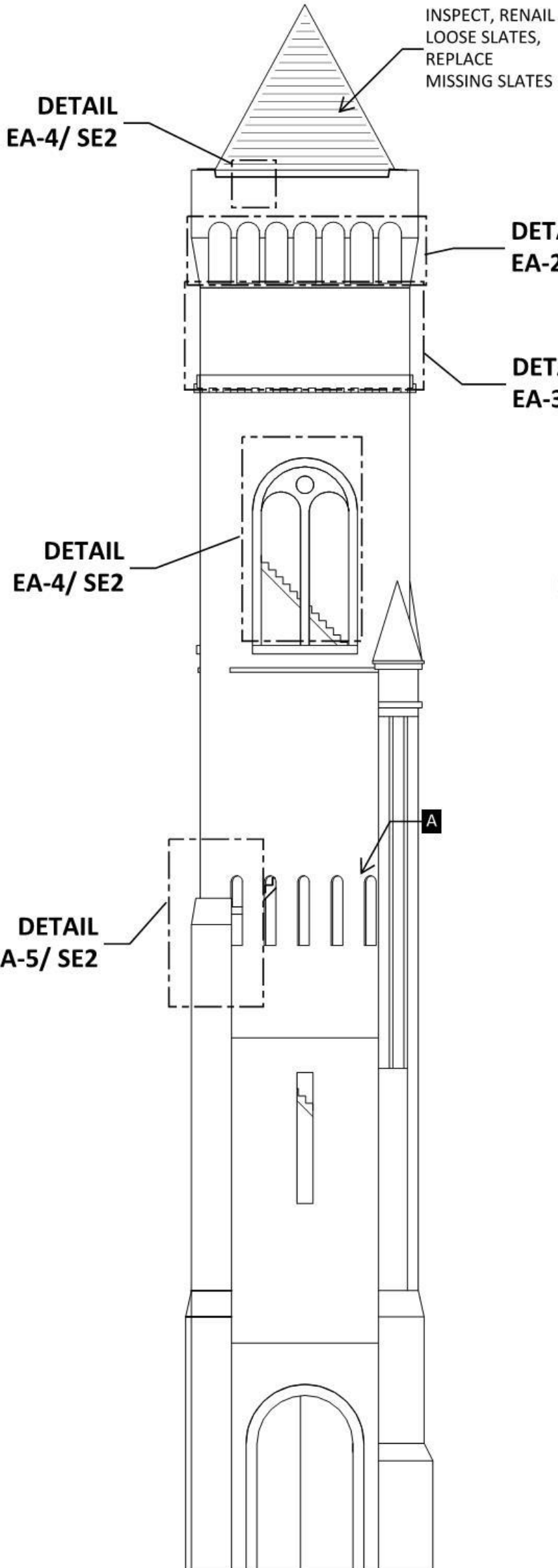

EAST ELEVATION/ EXTERIOR

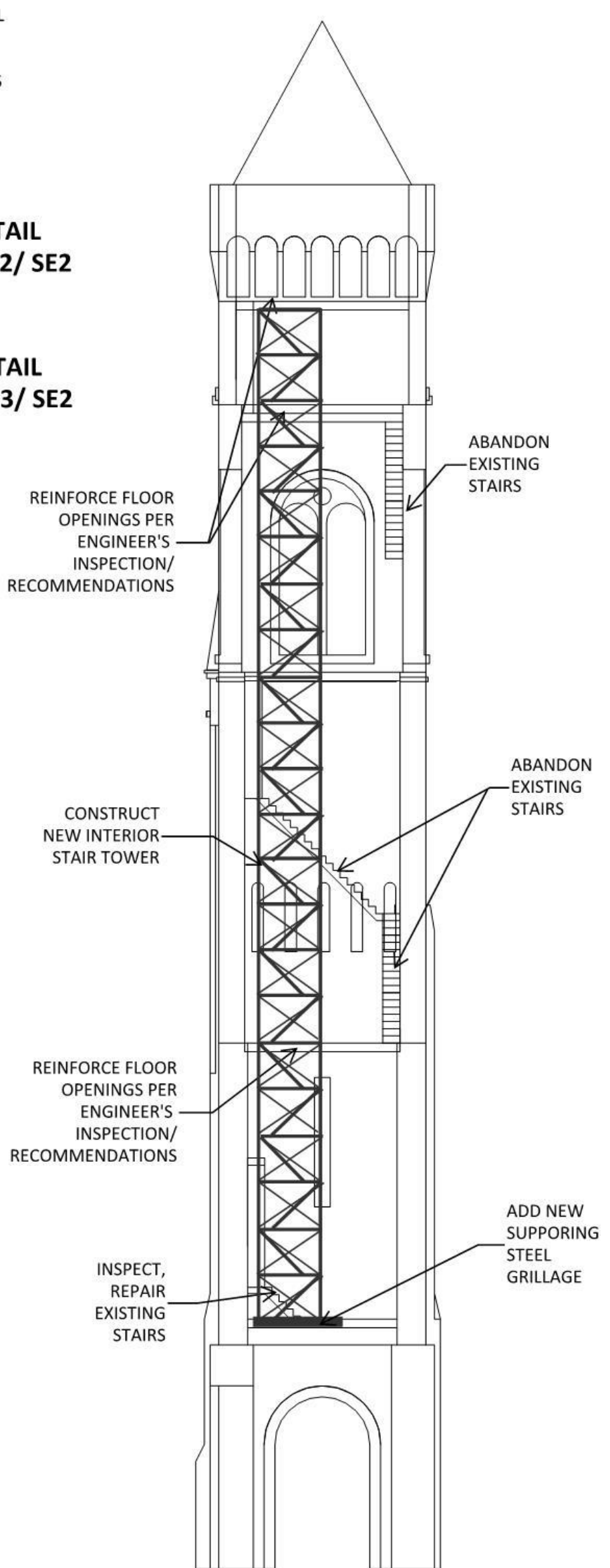

EAST ELEVATION/ INTERIOR

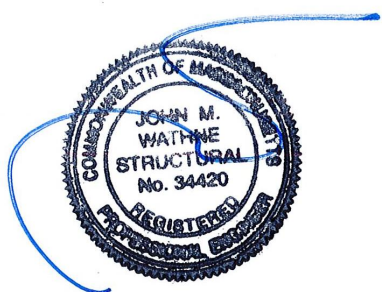

EMERGENCY REPAIRS
FIRST BAPTIST CHURCH
 110 COMMONWEALTH AVENUE, BOSTON, MA

STRUCTURES NORTH
 CONSULTING ENGINEERS, INC.
 60 WASHINGTON ST. SALEM, MA
 JMW/ SA/ 3-1-17

SE1
ELEVATIONS



DETAIL EA-1

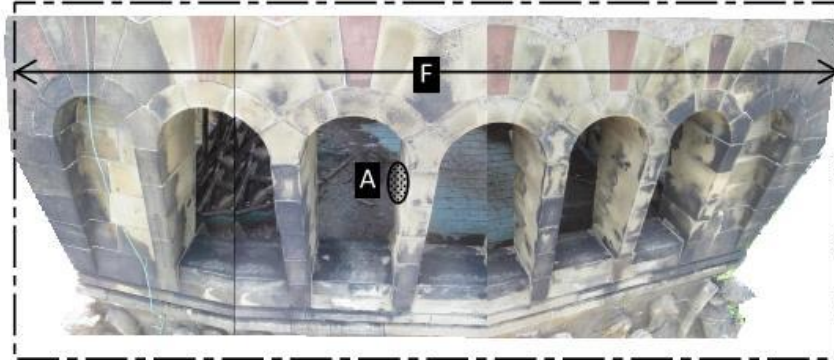

DETAIL EA-2



DETAIL EA-3

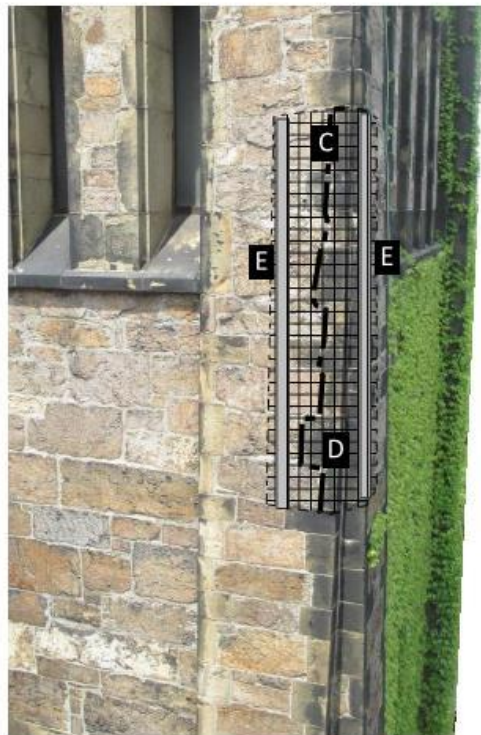

DETAIL EA-5

KEYED NOTES

- A** REMOVE LOOSE STONE SPALL- NEAR SIDE, (f)= FAR SIDE.
- B** REMOVE LOOSE MORTAR OR FLAKING STONE.
- C** PRESS BACKER-ROD INTO OPEN CRACKS AND JOINTS.
- D** INSTALL STAINLESS STEEL HARDWARE CLOTH STRETCHED TIGHTLY OVER LOOSE OR CRACKED STONE.
- E** LOOP HARDWARE CLOTH AROUND 2X4 P/T WOODEN BATTEN AND, PULL TIGHTLY AND FASTEN TO MASONRY- NEAR SIDE, (f)= FAR SIDE.
- F** VISUALLY INSPECT AND HAMMER TAP EXISTING STONEMWORK, REMOVE ALL LOOSE FRAGMENTS AND SPALLS.
- G** INSTALL WOODEN CIPPLES AND BRACES TO SUPPORT SLIDING LOUVER FINS.
- H** INSPECT LOUVER FINS, REMOVE IF ROTTED BEYOND REPAIR INSTEAD OF SUPPORTING AND BRACING THEM.
- I** REMOVE FAILED LOUVER DEBRIS.
- J** REMOVE ROTTED SOFFIT OF RAFTER TAIL, REINFORCE WITH NEW 2X8 SISTERS AT EACH SIDE.



DETAIL EA-4

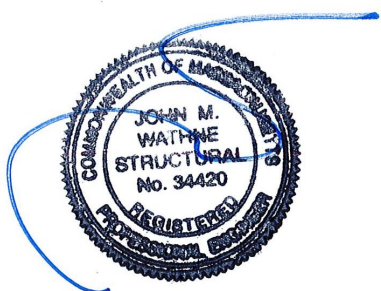

<p>EMERGENCY REPAIRS FIRST BAPTIST CHURCH 110 COMMONWEALTH AVENUE, BOSTON, MA</p>	<p> STRUCTURES NORTH CONSULTING ENGINEERS, INC 60 WASHINGTON ST. SALEM, MA JMW/ SA/ 7-27-16</p>	<p>SE2 DETAILS</p>
---	---	---------------------------------------

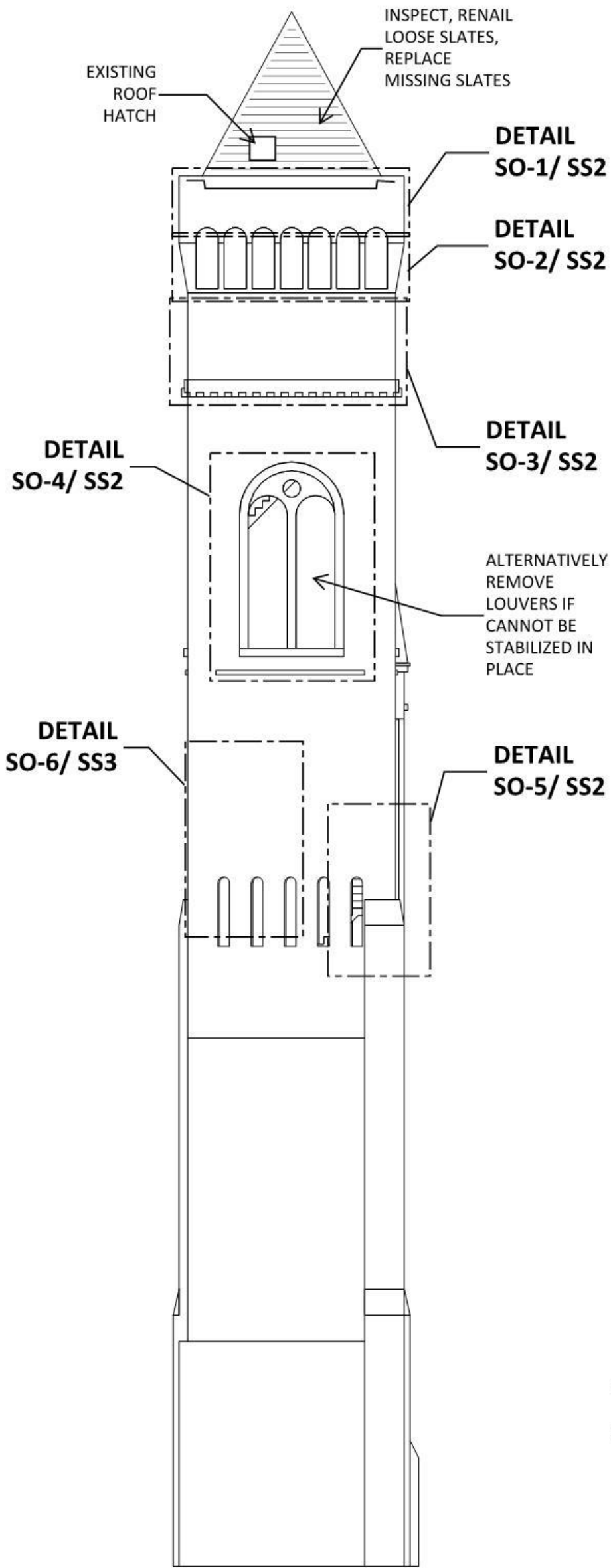

SOUTH ELEVATION/ EXTERIOR

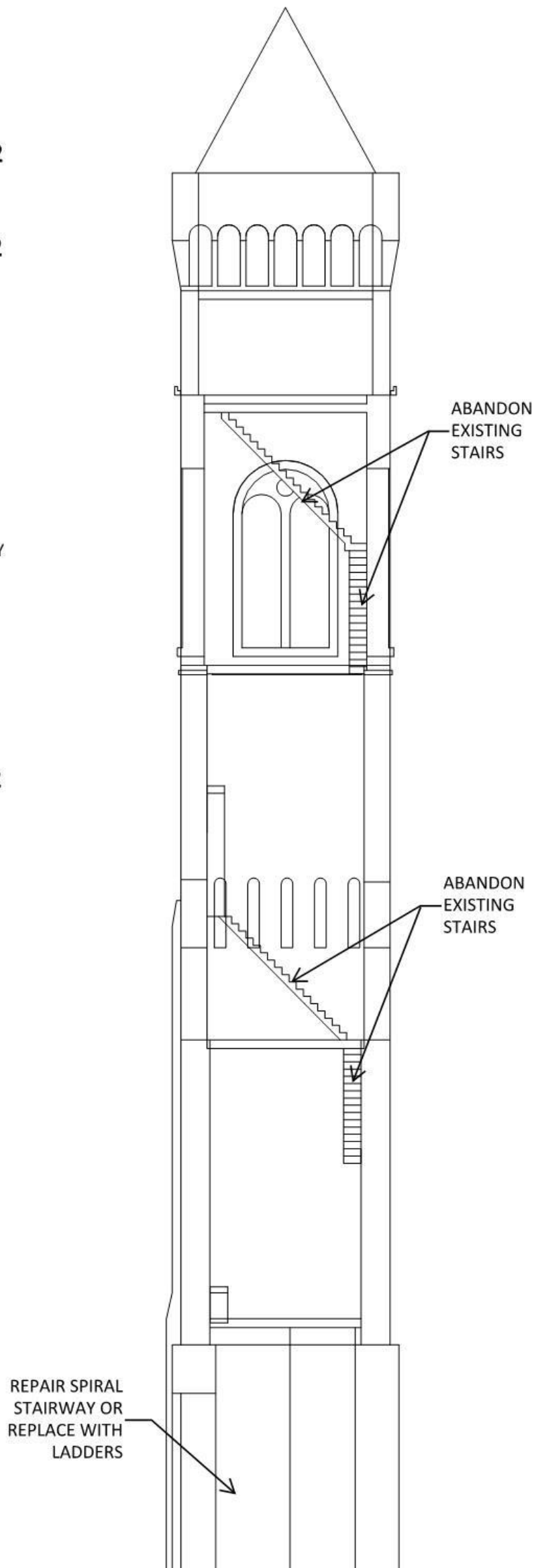

SOUTH ELEVATION/ INTERIOR

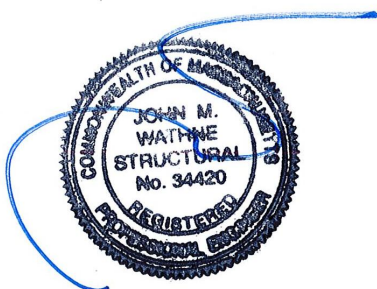

<p>EMERGENCY REPAIRS FIRST BAPTIST CHURCH 110 COMMONWEALTH AVENUE, BOSTON, MA</p>	<p> STRUCTURES NORTH CONSULTING ENGINEERS, INC 60 WASHINGTON ST. SALEM, MA JMW/SA/ 3-1-17</p>	<p>SS1 ELEVATIONS</p>
---	---	--



DETAIL SO-1

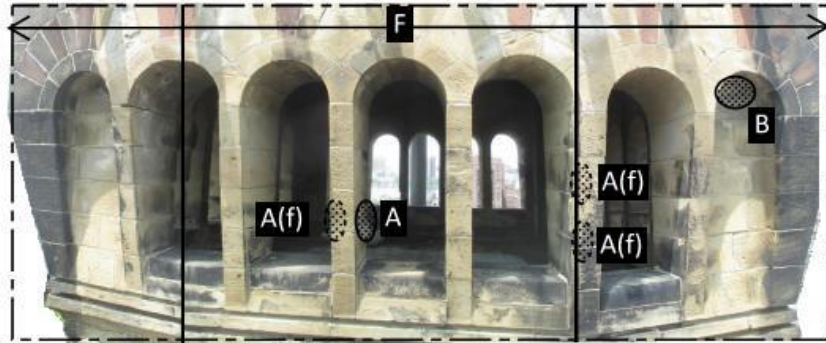

DETAIL SO-2

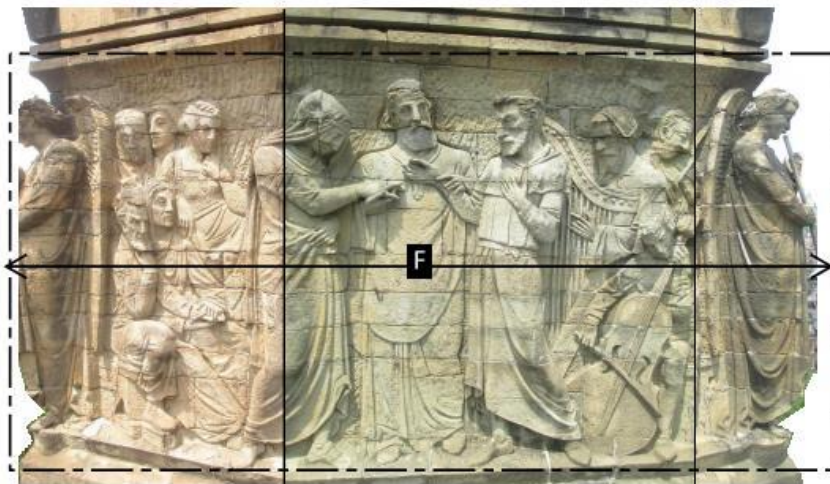

DETAIL SO-3

KEYED NOTES

- A** REMOVE LOOSE STONE SPALL- NEAR SIDE, (f)= FAR SIDE.
- B** REMOVE LOOSE MORTAR OR FLAKING STONE.
- C** PRESS BACKER-ROD INTO OPEN CRACKS AND JOINTS.
- D** INSTALL STAINLESS STEEL HARDWARE CLOTH STRETCHED TIGHTLY OVER LOOSE OR CRACKED STONE.
- E** LOOP HARDWARE CLOTH AROUND 2X4 P/T WOODEN BATTEN AND, PULL TIGHTLY AND FASTEN TO MASONRY- NEAR SIDE, (f)= FAR SIDE.
- F** VISUALLY INSPECT AND HAMMER TAP EXISTING STONEWORK, REMOVE ALL LOOSE FRAGMENTS AND SPALLS.
- G** INSTALL WOODEN CIPPLES AND BRACES TO SUPPORT SLIDING LOUVER FINS.
- H** INSPECT LOUVER FINS, REMOVE IF ROTTED BEYOND REPAIR INSTEAD OF SUPPORTING AND BRACING THEM.
- I** REMOVE FAILED LOUVER DEBRIS.
- J** REMOVE ROTTED SOFFIT OF RAFTER TAIL, REINFORCE WITH NEW 2X8 SISTERS AT EACH SIDE.

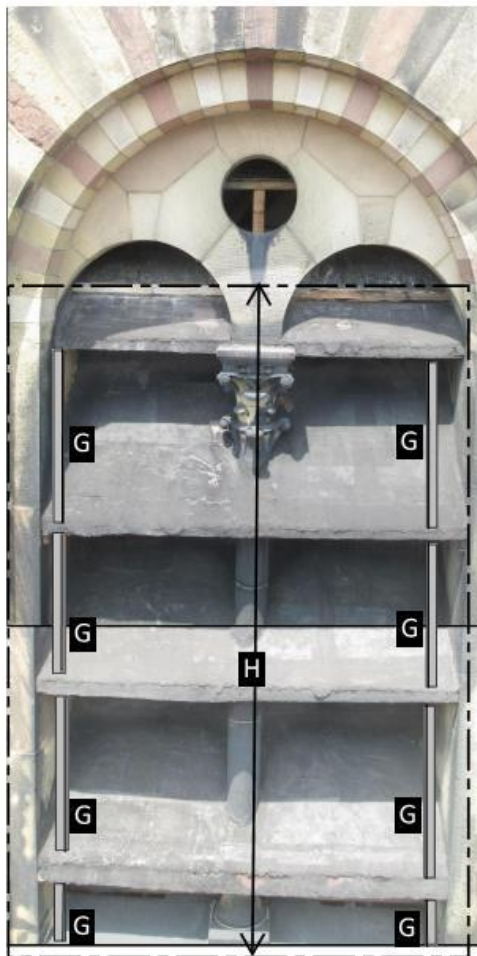

DETAIL SO-4

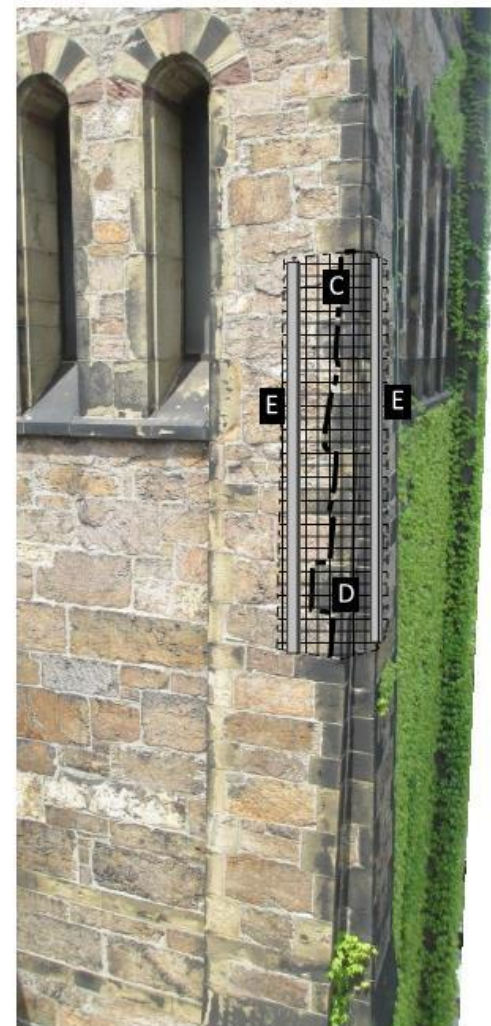

DETAIL SO-5

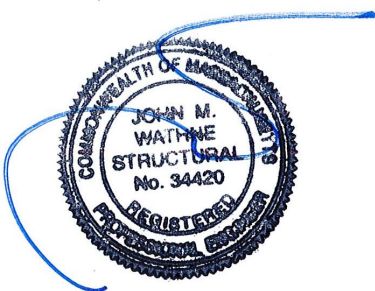



DETAIL SO-6

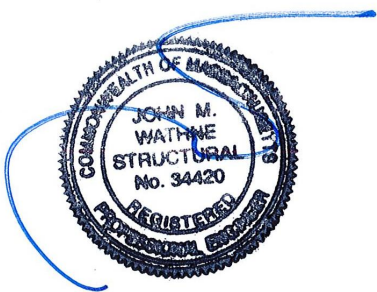

<p>EMERGENCY REPAIRS FIRST BAPTIST CHURCH 110 COMMONWEALTH AVENUE, BOSTON, MA</p>	<p> STRUCTURES NORTH CONSULTING ENGINEERS, INC 60 WASHINGTON ST. SALEM, MA JMW/ SA/ 1-6-17</p>	<p>SS3 DETAILS</p>
---	---	-------------------------------

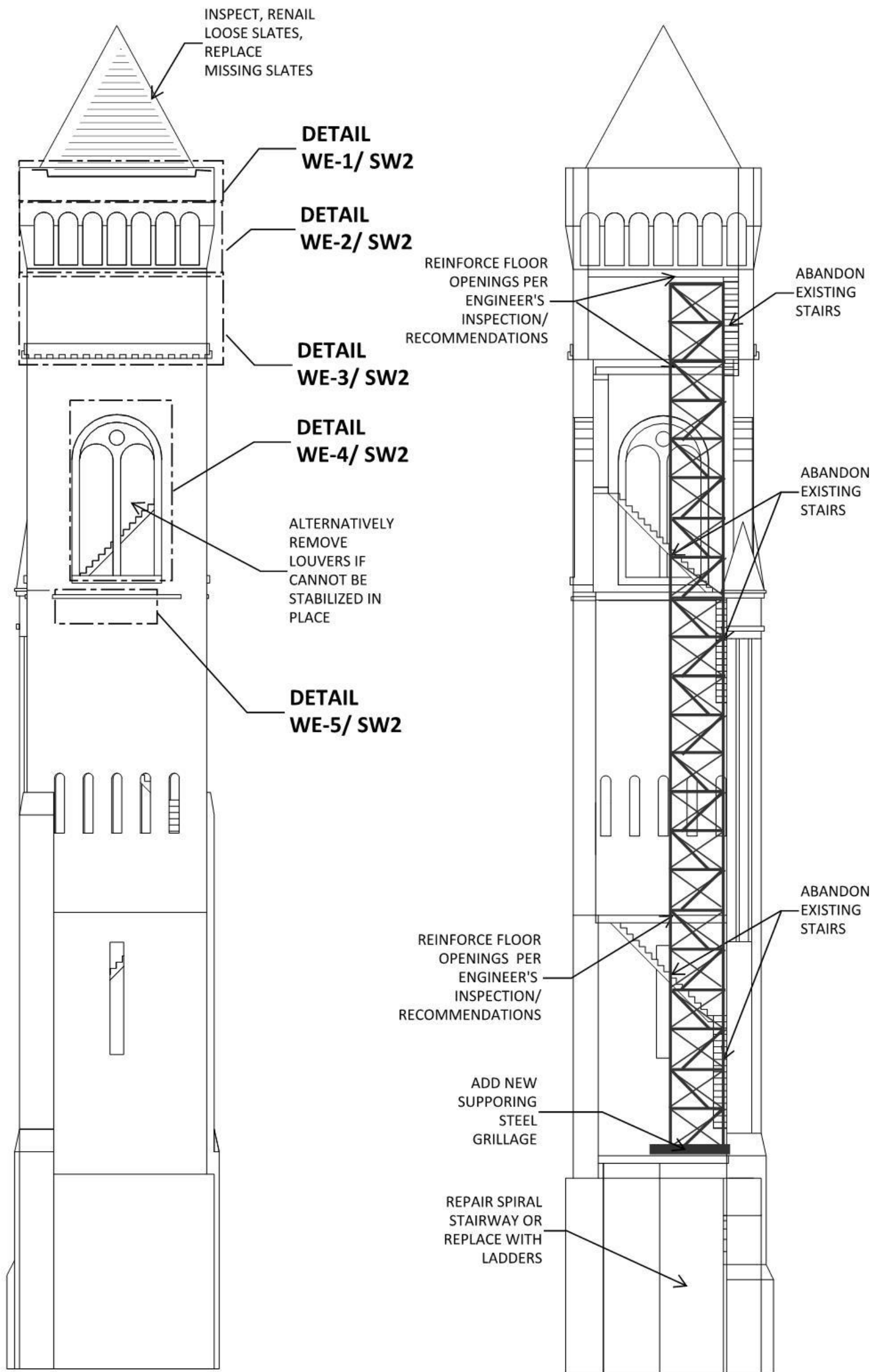

WEST ELEVATION/ EXTERIOR

WEST ELEVATION/ INTERIOR

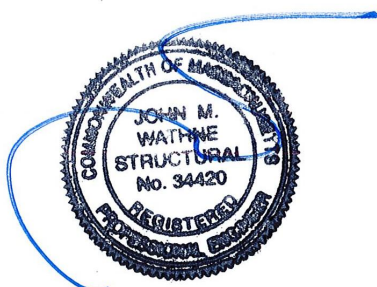

EMERGENCY REPAIRS
FIRST BAPTIST CHURCH
 110 COMMONWEALTH AVENUE, BOSTON, MA



STRUCTURES NORTH
 CONSULTING ENGINEERS, INC.
 60 WASHINGTON ST. SALEM, MA
 JMW/ SA/ 3-1-17

SW1
ELEVATIONS

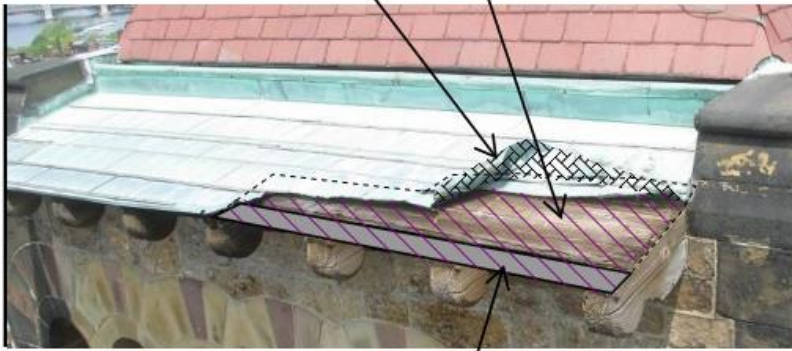

CUT OFF LOOSE, PEELED BACK COPPER FLASHING

INSTALL BONDED AND BATEDED EPDM MEMBRANE OUT TO EDGE OF NEW SHEATHING. FLATTEN AND NAIL DOWN REMAINING METAL FLASHING OVER THE EPDM.



REPLACE ROTTED AND MISSING SHEATHING BOARDS WITH NEW 5/4" BOARDS SCREWED DOWN INTO RAFTER TAILS.

DETAIL WE-1

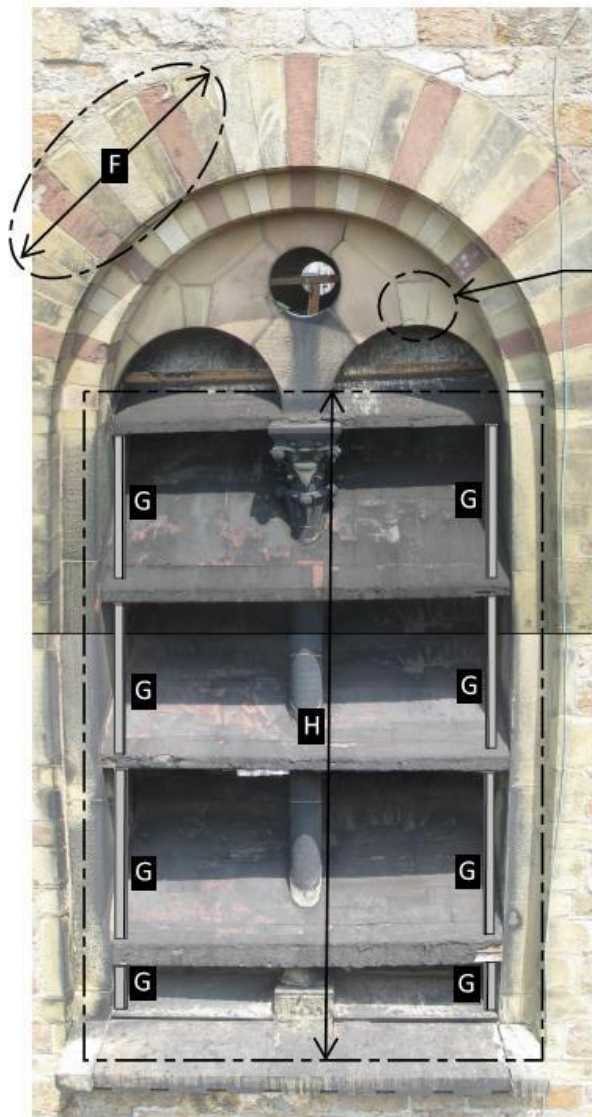

WEDGE GAPS IN SLIPPING KEYSTONE

DETAIL WE-4

KEYED NOTES

- A** REMOVE LOOSE STONE SPALL- NEAR SIDE, (f)= FAR SIDE.
- B** REMOVE LOOSE MORTAR OR FLAKING STONE.
- C** PRESS BACKER-ROD INTO OPEN CRACKS AND JOINTS.
- D** INSTALL STAINLESS STEEL HARDWARE CLOTH STRETCHED TIGHTLY OVER LOOSE OR CRACKED STONE.
- E** LOOP HARDWARE CLOTH AROUND 2X4 P/T WOODEN BATTEN AND, PULL TIGHTLY AND FASTEN TO MASONRY- NEAR SIDE, (f)= FAR SIDE.
- F** VISUALLY INSPECT AND HAMMER TAP EXISTING STONEMWORK, REMOVE ALL LOOSE FRAGMENTS AND SPALLS.
- G** INSTALL WOODEN CIPPLES AND BRACES TO SUPPORT SLIDING LOUVER FINs.
- H** INSPECT LOUVER FINs, REMOVE IF ROTTED BEYOND REPAIR INSTEAD OF SUPPORTING AND BRACING THEM.
- I** REMOVE FAILED LOUVER DEBRIS.
- J** REMOVE ROTTED SOFFIT OF RAFTER TAIL, REINFORCE WITH NEW 2X8 SISTERS AT EACH SIDE.

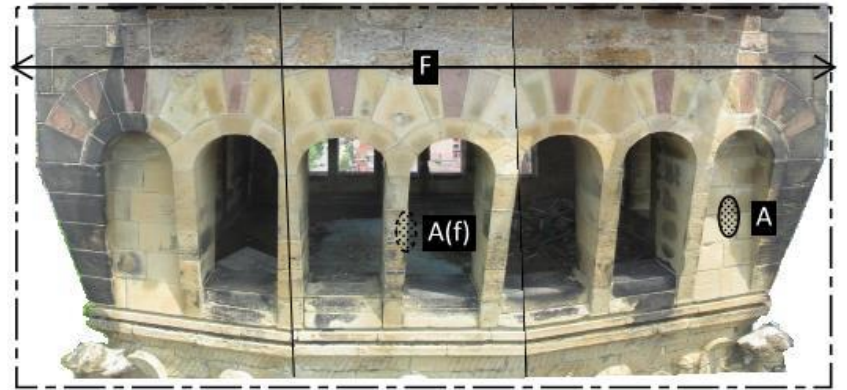

DETAIL WE-2

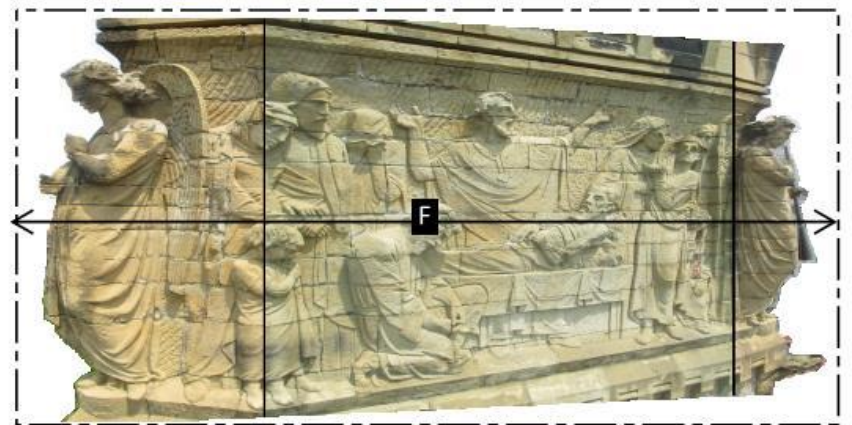

DETAIL WE-3



DETAIL WE-5

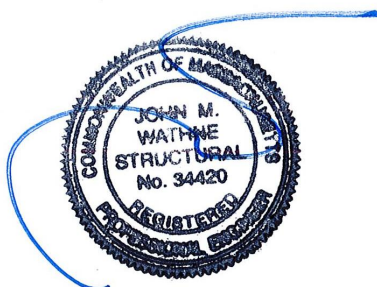

<p>EMERGENCY REPAIRS FIRST BAPTIST CHURCH 110 COMMONWEALTH AVENUE, BOSTON, MA</p>	<p> STRUCTURES NORTH CONSULTING ENGINEERS, INC 60 WASHINGTON ST. SALEM, MA JMW/ SA/ 1-6-17</p>	<p>SW2 DETAILS</p>
---	--	--